

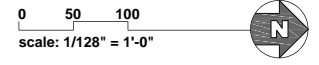

BUILDING SPECIFICATIONS:

Building Size:	301,000 SF
Available Space:	75,939 SF
Office:	1,171 SF
Site Area:	12.37 Acres
Loading:	Eight (8) Exterior Docks
Dock Equipment:	8 Levelers, 8 Dock Lights
Car Parking:	90 Cars
Clear Height:	23' Clear
Lighting:	580 (8' T12's) / 160 (400 WHPS)
Bay Size:	40' x 37'
Sprinkler:	Wet Density - .58 GPM/SF Designed Area of Discharge - 3,000 SF
Power:	600 Amps / 480 Volts
Rail Carrier:	Belt Railway
Rail Loading:	3 Exterior Docks
Heat:	Gas Unit Heaters
Year Built:	1975
Real Estate Taxes:	\$1.96 PSF
Lease Rate:	\$5.50 PSF Gross
Driving Distances:	<ul style="list-style-type: none">• Midway Airport (4.1 M)• O'Hare Airport (26.6 M)• I-55 & Harlem Full Interchange (3.5 M)

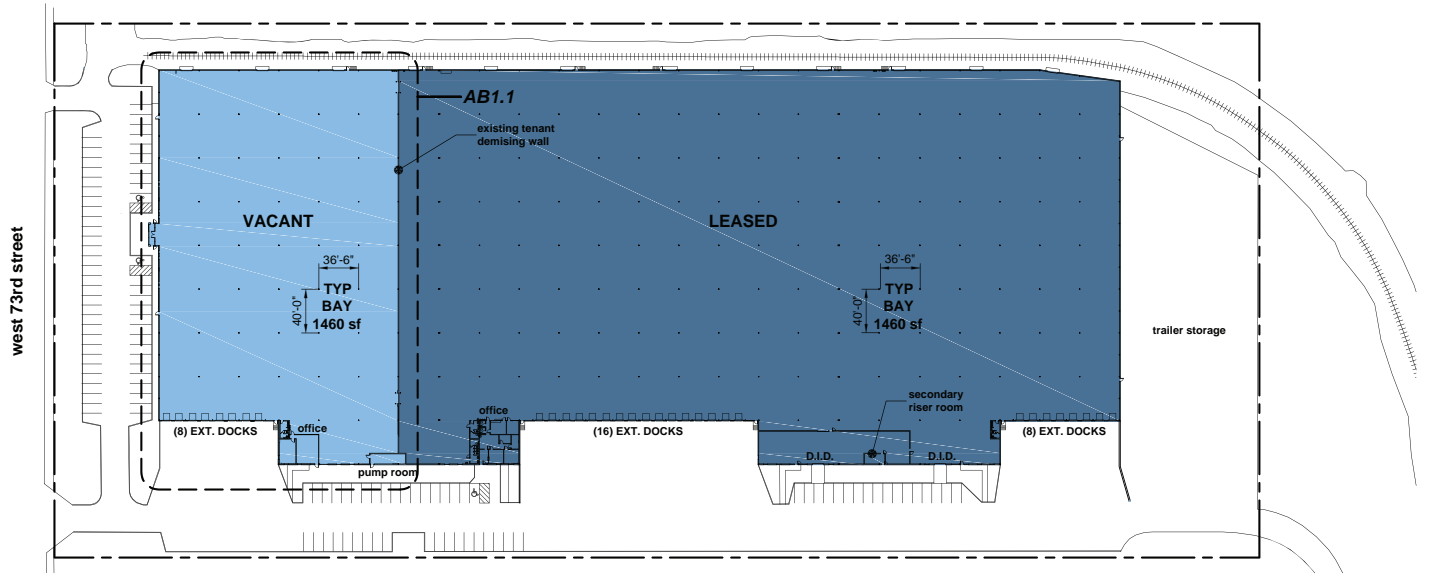



SITE PLAN

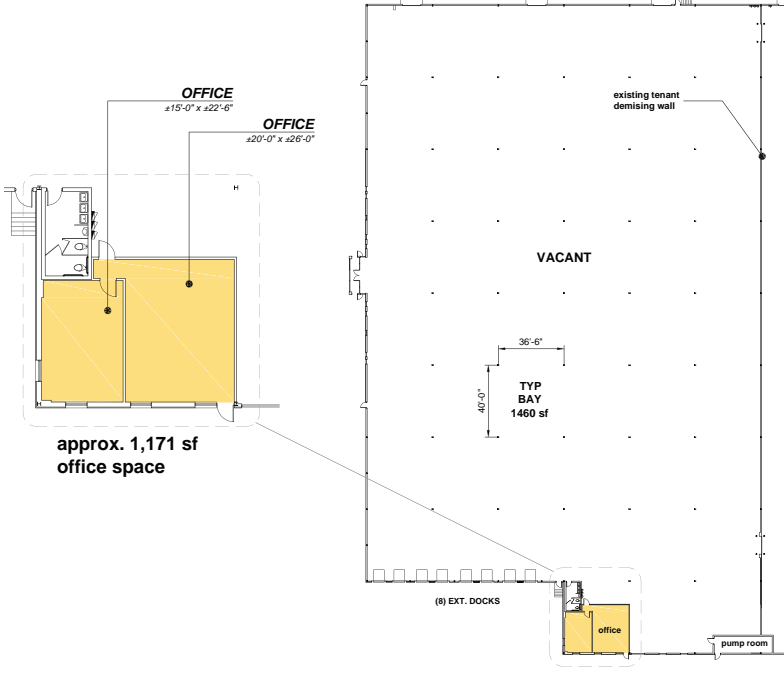

building information

one story multi-tenant office/warehouse

vacant tenant area:	± 75,939 sf
leased tenant area:	± 225,061 sf
total building area:	± 301,000 sf

building information

one story office/warehouse

office area:	± 1,171 sf
warehouse area:	± 74,768 sf
total building area:	± 75,939 sf

