

776 AVENUE OF THE AMERICAS



776 AVENUE OF THE AMERICAS

FLOORS / AREA Partial 4th / 8,597 RSF
Entire 3rd / 23,765 RSF
Entire 2nd / 24,121 RSF
Ground / 908 RSF

TOTAL BLOCK Approximately 57,000 RSF

POSSESSION First Quarter 2020

FEATURES

- Unique **building within a building** opportunity
- Private lobby with expansive branding opportunities
- 14' high ceilings throughout
- Excellent natural light on four (4) sides
- Landlord to do a cosmetic renovation to the lobby
- Elevator modifications underway
- Premises to be delivered demolished and in clean shell condition
- Building situated in the heart of Chelsea

David Falk
212.372.2271
dfalk@ngkf.com

Peter Shimkin
212.372.2150
pshimkin@ngkf.com

Eric Cagner
212.372.2279
ecagner@ngkf.com





AREA

776 AVENUE OF THE AMERICAS



TEST FIT

776 AVENUE OF THE AMERICAS

CREATIVE LAYOUT

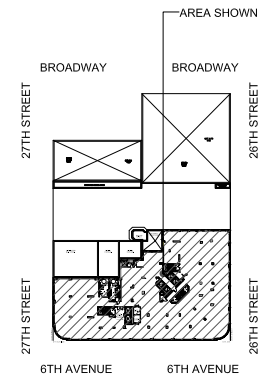
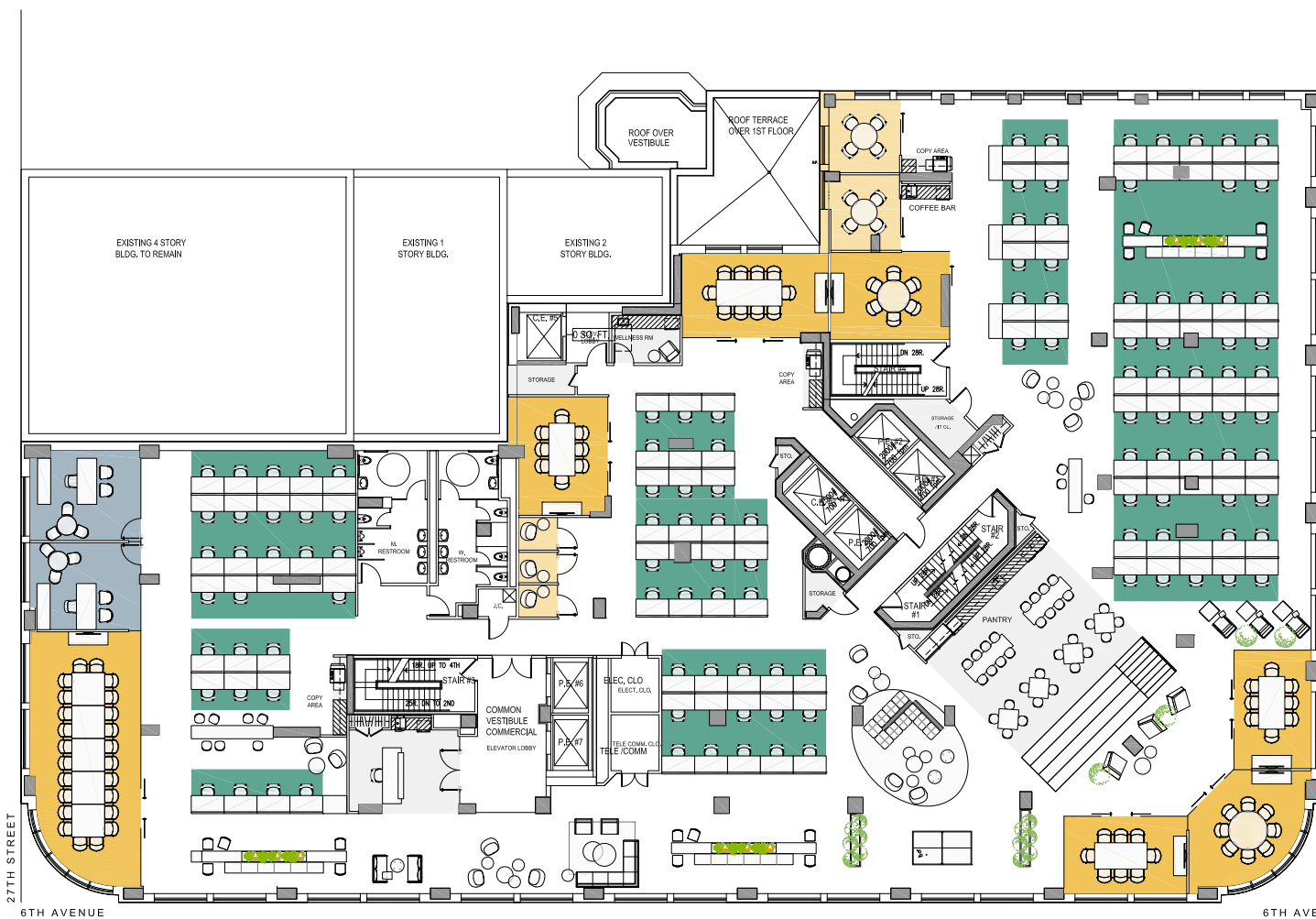

KEY PLAN: NTS

WORK SPACE	SEATS
EXECUTIVE OFFICE	2
BENCHING (2' 6" x 5')	118
RECEPTION	1
TOTAL HEADCOUNT	121

COLLABORATIVE SPACE	
CONFERENCE (24 PPL)	1
CONFERENCE (10 PPL)	1
CONFERENCE (8 PPL)	4
CONFERENCE (6 PPL)	1
MEETING ROOMS (4 PPL)	2
PHONE ROOMS	3

SUPPORT	
PANTRY	1
COFFEE BAR	2
COAT CLOSET	2
COPY AREA	3
STORAGE/IT CL.	1
STORAGE ROOM	5
WELLNESS ROOM	1

TEST FIT

776 AVENUE OF THE AMERICAS

HIGH DENSITY LAYOUT

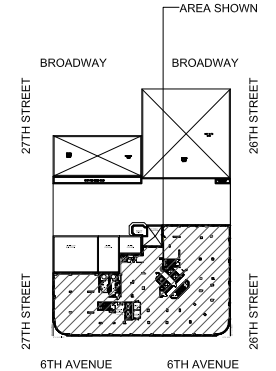
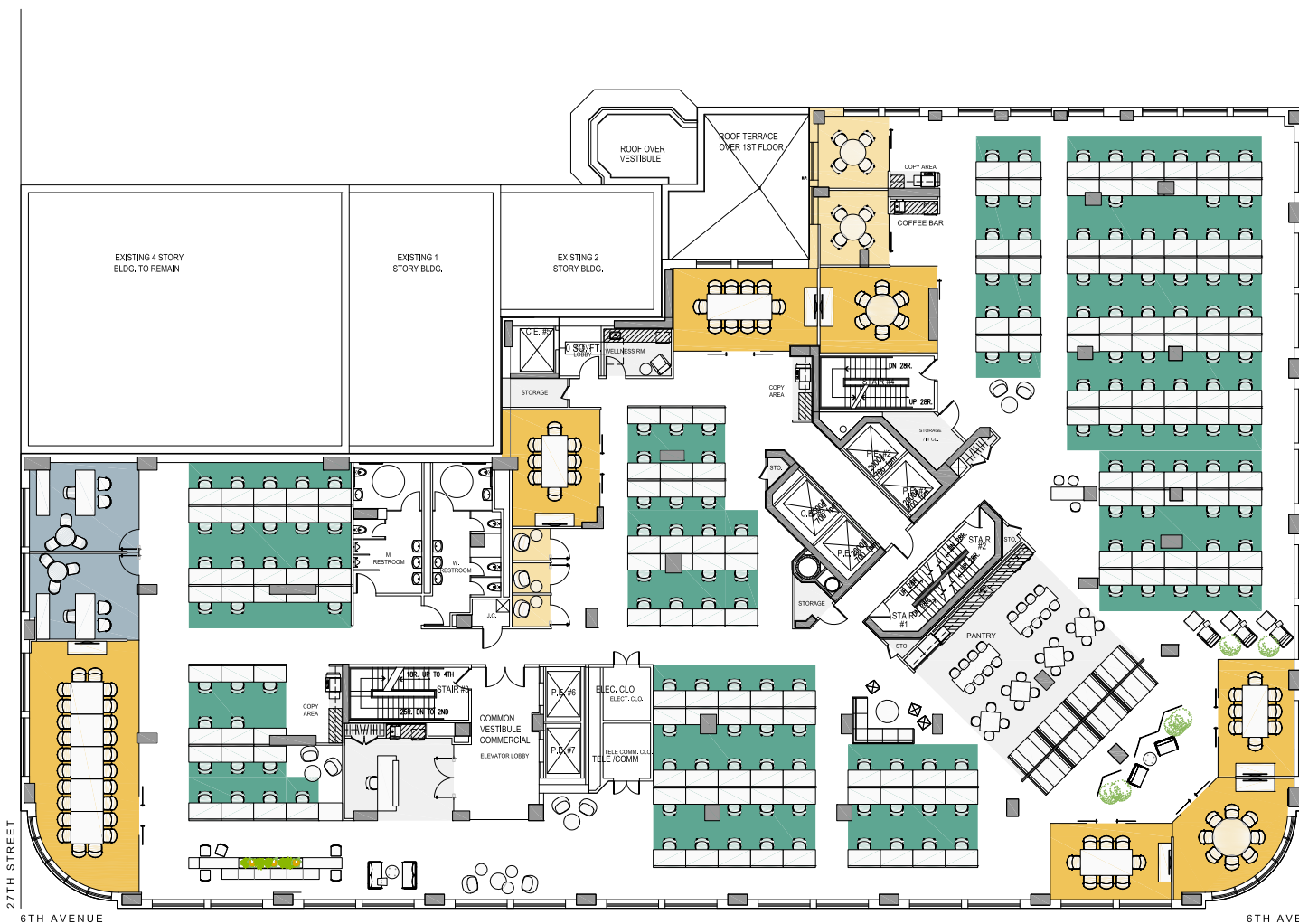

KEY PLAN: NTS

WORK SPACE	SEATS
EXECUTIVE OFFICE	2
BENCHING (2' 6" x 5')	157
RECEPTION	1
TOTAL HEADCOUNT	160

COLLABORATIVE SPACE	
CONFERENCE (24 PPL)	1
CONFERENCE (10 PPL)	1
CONFERENCE (8 PPL)	4
CONFERENCE (6 PPL)	1
MEETING ROOMS (4 PPL)	2
PHONE ROOMS	3

SUPPORT	
PANTRY	1
COFFEE BAR	2
COAT CLOSET	2
COPY AREA	3
STORAGE/IT CL.	1
STORAGE ROOM	5
WELLNESS ROOM	1

776 AVENUE OF THE AMERICAS

David Falk

212.372.2271

dfalk@ngkf.com

Peter Shimkin

212.372.2150

pshimkin@ngkf.com

Eric Cagner

212.372.2279

ecagner@ngkf.com

