

1,984 SF OFFICE / SERVICE CENTER AVAILABLE FOR LEASE

2503-2505 METRO BOULEVARD | MARYLAND HEIGHTS, MO 63043



1,984 SF OFFICE / SERVICE CENTER AVAILABLE

- 2505 Metro Court, Suite E
- Drop ceiling production area with 100% HVAC
- Access to dock platform
- Excellent truck turn-around area
- Quiet cul-de-sac
- Located near the southwest corner of the signalized intersection of Dorsett Road and Metro Blvd just east of Weldon Parkway
- Convenient and easy access to I-270 via Dorsett Road
- Within close proximity to Westport Plaza amenities
- **LEASE RATE: \$5.95 PSF NNN**

For additional information, please contact:

BO KEEFER
bkeeper@hutkin.com
314.708.1258 o.
314.973.1242 m.

TONY GIARRATANO
tony@hutkin.com
314.708.4922 o.
314.276.2352 m.

HUTKIN
DEVELOPMENT COMPANY

10829 OLIVE BOULEVARD, SUITE 200
ST. LOUIS, MISSOURI 63141
314.872.9140 PHONE
314.872.9001 FAX
WWW.HUTKIN.COM

1,984 SF OFFICE / SERVICE CENTER AVAILABLE FOR LEASE

2503-2505 METRO BOULEVARD | MARYLAND HEIGHTS, MO 63043

COMMON HALLWAY TO DOCK PLATFORM

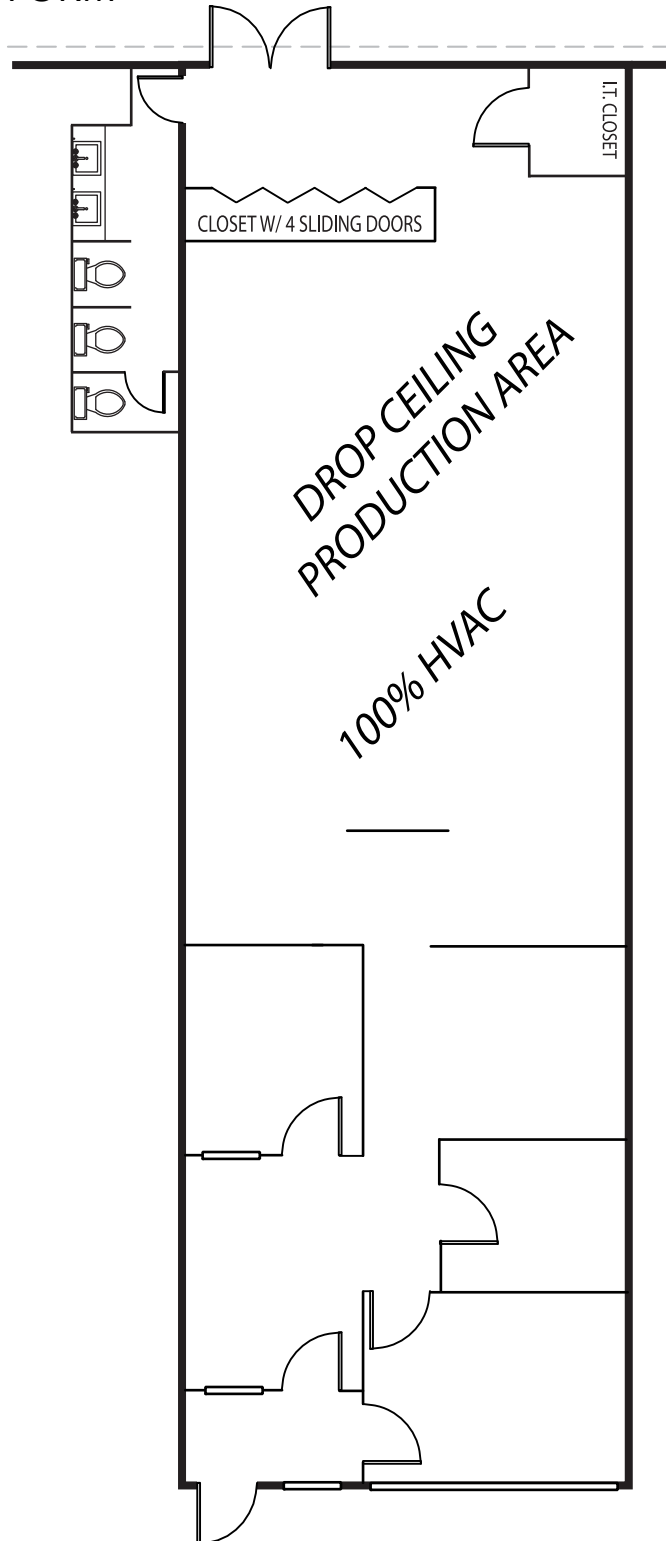

2505 METRO, SUITE E
1,984 SF

1,984 SF OFFICE / SERVICE CENTER AVAILABLE FOR LEASE

2503-2505 METRO BOULEVARD | MARYLAND HEIGHTS, MO 63043

