

Pacific Business Park Building 3

6908 S 220th Street
Kent, WA

2,500 SF total

375 SF office

.....
\$0.60 PSF shell

.....
\$0.75 PSF, NNN office add-on

.....
2 dock-high doors

.....
1 grade-level door

.....
14' - 16' clear height

.....
Comcast Cable available

.....
February 1, 2016



Tremendous access to I-5 and SR-167 via S 212th Street



Doug Klein, SIOR

Senior Vice President

206.248.7348

dklein@kiddermathews.com

.....
Kraig Heeter

Vice President

206.248.7313

kheeter@kiddermathews.com

Pacific Business Park Building 3

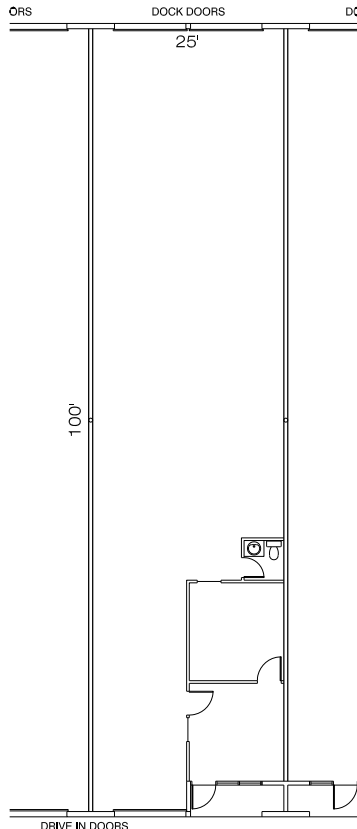

AVAILABLE SPACE
2,500 SF TOTAL
375 SF OFFICE

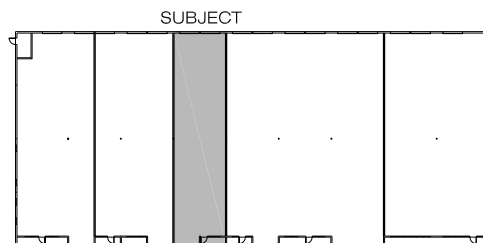

KEY PLAN
NOT TO SCALE

PACIFIC BUSINESS PARK (NORTH)
BUILDING #3 (PTR #158)
6908 S. 220TH STREET
KENT, WA 98032

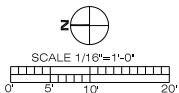

A FACTRUST PROPERTY

Contact

Doug Klein, SIOR
Senior Vice President
206.248.7348
dklein@kiddermathews.com

Kraig Heeter
Vice President
206.248.7313
kheeter@kiddermathews.com