



900 Washington Street, Suite 850 • Vancouver, WA 98660
(360) 750-5595 • fax (360) 750-5594 • www.fg-cre.com

For Sale



HAZEL DELL AVENUE PARCEL

South of NE 88th Street & Adjacent to Hazel Dell Town Center
Vancouver, WA 98665

TAX PARCEL NO: 145251000

ZONING: Community Commercial

PARCEL SIZE: 18,375 SF

SALE PRICE: \$350,000 (\$19.04/SF)

NEIGHBORING RETAILERS:

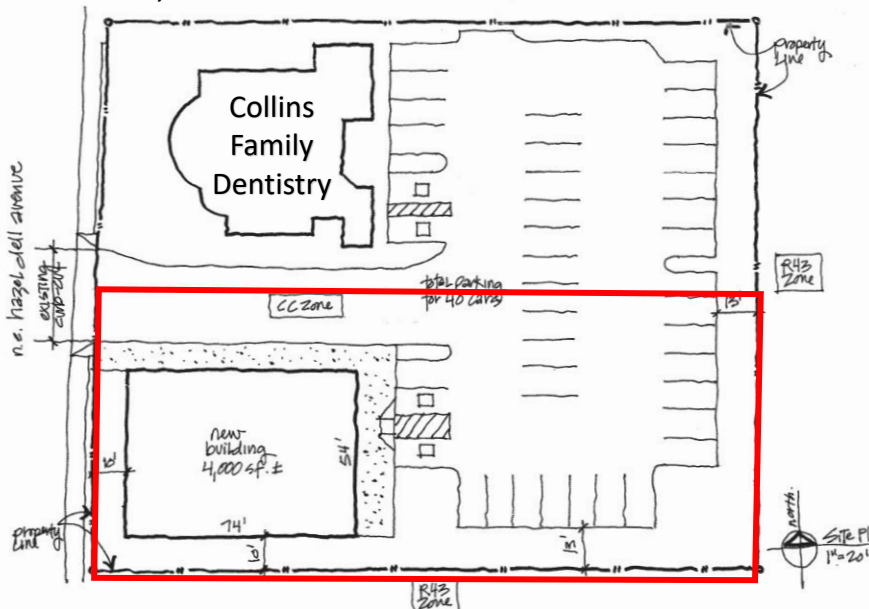

360-750-5595
www.fg-cre.com

FOR MORE INFO:
Deborah Ewing | 360.597.0566 | dewing@fg-cre.com

For Sale

Hazel Dell Land | Vancouver, WA 98665

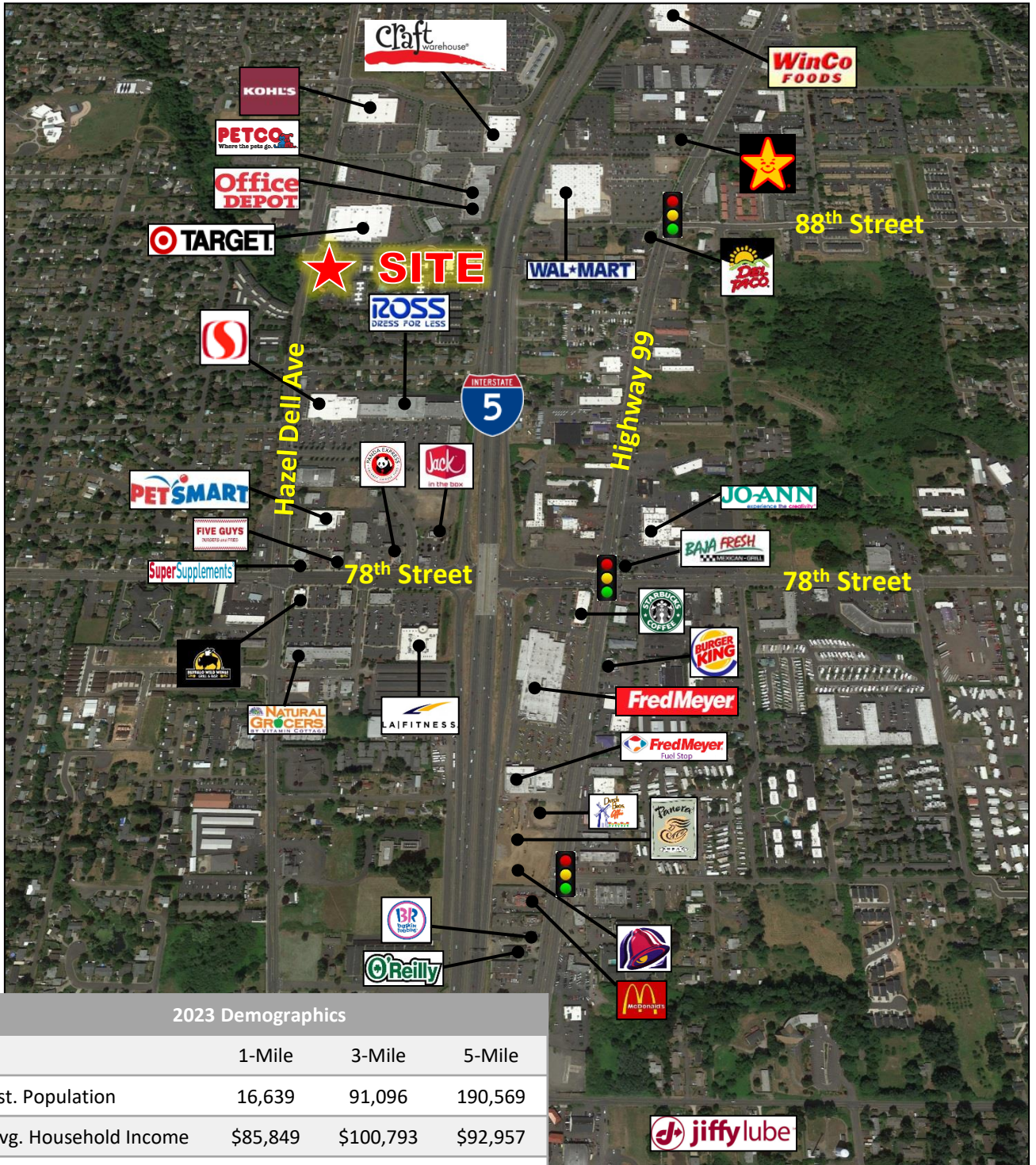

2023 Demographics

	1-Mile	3-Mile	5-Mile
Est. Population	16,639	91,096	190,569
Avg. Household Income	\$85,849	\$100,793	\$92,957
Daytime Employment	7,633	28,058	79,446

This statement with the information it contains is given with the understanding that all the negotiations relating to the purchase, rental or leasing of the property described above shall be conducted through this office. The above information, while not guaranteed, has been secured from sources we believe to be reliable.

www.fg-cre.com