

MENLO BUSINESS PARK



 **Newmark  
Knight Frank**

**FRANK COX** 408.982.8422  
fcox@ngkf.com CA RE License #00889881

SAN JOSE, CA  
AVAILABILITY SUMMARY  
**±3,793 - ±4,479 SF**





(Floorplan Not to Scale)

2360 QUME DRIVE | SUITE A:  
**±4,479 SQUARE FEET**

- Newly Renovated
- 100% Drop Ceiling Office / R&D Area
- Front Unit
- Great Glass Line
- Perimeter Privates with Side Light Glass
- Lunch Area / Break Room
- Open Office Area
- Large Conference Room
- One (1) Grade Level Truck Door / Glassed In
- Call to Tour





2372 QUME DRIVE | SUITE D:

±**3,793 SQUARE FEET**

- Market Ready Interiors
- ±80% Drop Ceiling Office / R&D Area
- Reception Area
- Two (2) Private Offices
- One (1) Conference Room
- Lunch Area
- Two (2) Restrooms
- Balance Open Ceiling Warehouse
- One (1) Grade Level Truck Door
- Call to Tour

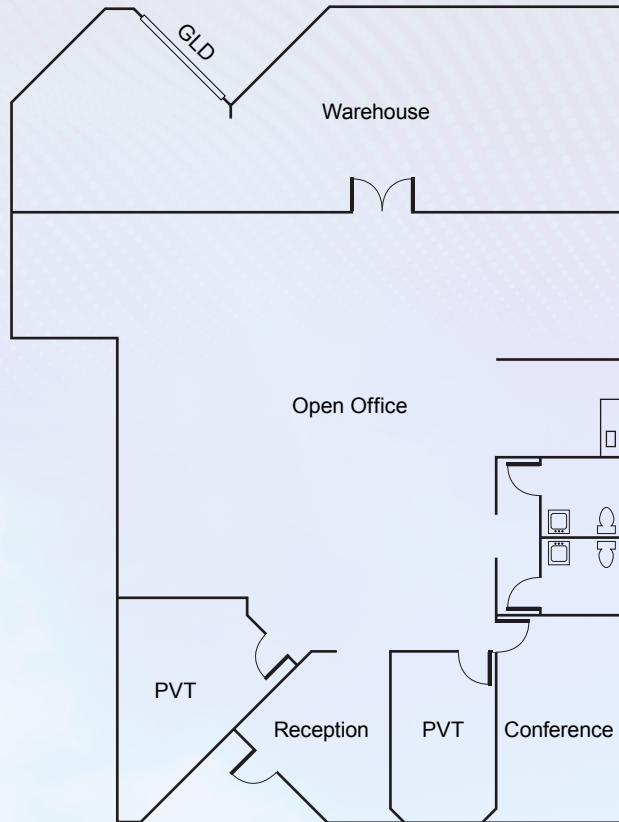

**AVAILABLE  
NOW**

(Floorplan Not to Scale)





±3,793 - ±4,479 SQUARE FEET

# SITE PLAN

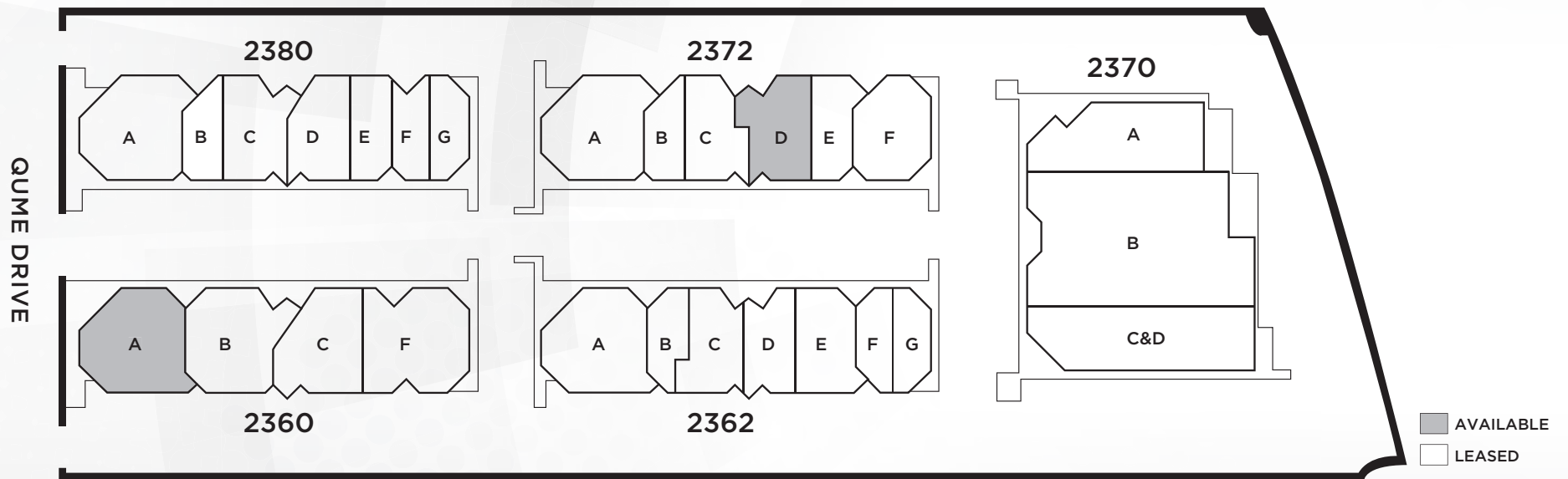



# LOCATION MAP

## MILPITAS



## SAN JOSE

## SANTA CLARA





2360 & 2372 QUME DRIVE  
SAN JOSE, CA

FRANK COX | 408.982.8422  
fcox@ngkf.com | CA RE License #00889881



3055 Olin Street, Suite 2200  
San Jose, CA 95128

The distributor of this communication is performing acts for which a real estate license is required. The information contained herein has been obtained from sources deemed reliable but has not been verified and no guarantee, warranty or representation, either express or implied, is made with respect to such information. Terms of sale or lease and availability are subject to change or withdrawal without notice. 19-1618.01/20