

Coming to Market in 2015

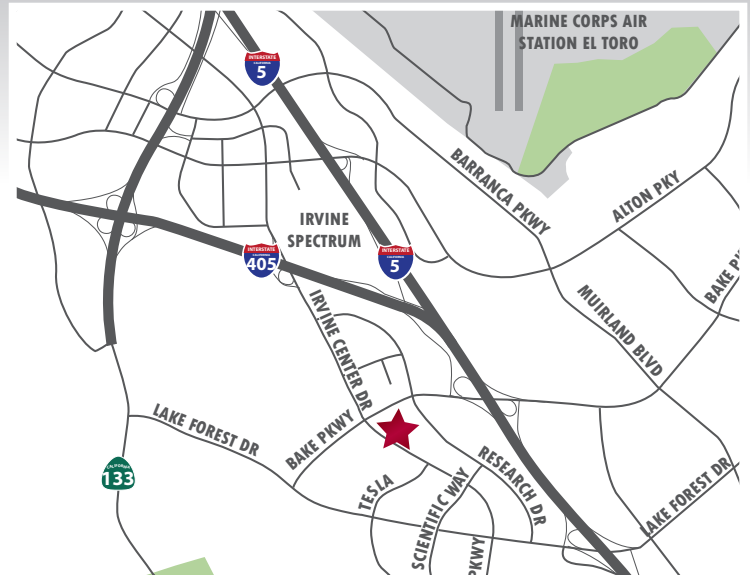

PROPERTY FEATURES

- ±18,920 SF Freestanding Creative Office Building
 - Exposed Ceiling with Hard Ducting
 - Polished Concrete Floor
 - Abundant Glassline with Operable Windows
- Divisible to 9,460 SF & 4,730 SF
- ±1,020 SF Enclosed Indoor/Outdoor Patio
- 4:1 Surface Free Parking
- Signage on Irvine Center Drive
- Close Proximity to John Wayne Airport
- Minutes to Irvine Spectrum Entertainment Center
- Immediate access to Santa Ana (5) and San Diego (405) Freeways and Eastern Transportation Corridor (133) Toll Road



For more information, please contact:

ALTON BURGESS

Senior Vice President
(949) 724-4722
aburgess@lee-associates.com
BRE# 01717094

TRAVIS HAINING

Senior Vice President
(949) 724-4711
thaining@lee-associates.com
BRE# 01483191

RYAN LAWLER

Associate
(949) 724-4718
rlawler@lee-associates.com
BRE# 01935961

LEE & ASSOCIATES - NEWPORT BEACH, INC.

A member of the Lee & Associates Group of Companies
100 BAYVIEW CIRCLE, SUITE 600
NEWPORT BEACH, CA 92660
949.724.1000 | WWW.LEE-ASSOCIATES.COM

AVAILABLE FOR LEASE ±18,920 SQ. FT. CREATIVE OFFICE BUILDING

75 DOPPLER | IRVINE, CA

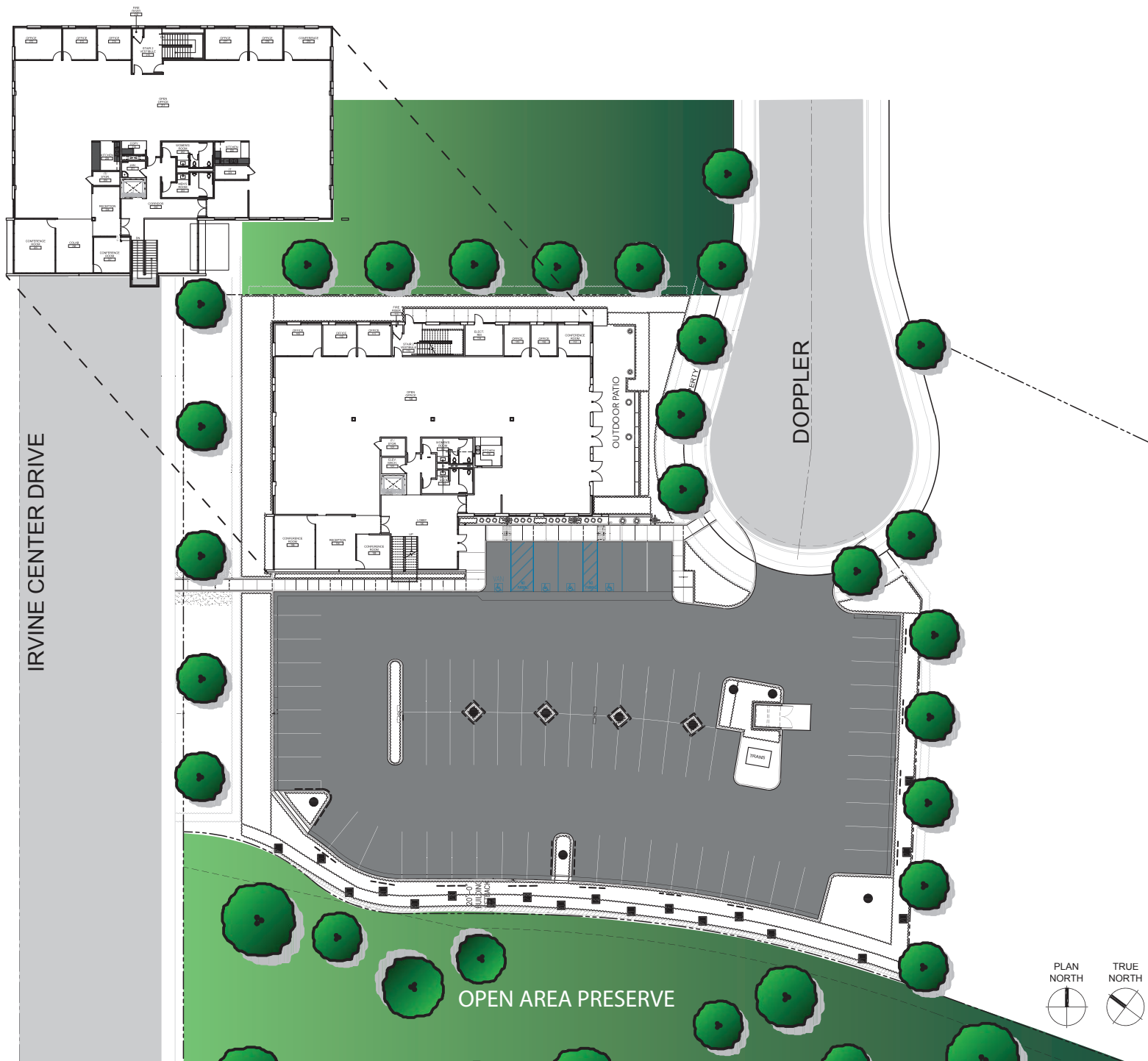

For more information, please contact:

ALTON BURGESS
 Senior Vice President
 (949) 724-4722
 aburgess@lee-associates.com
 BRE# 01717094

TRAVIS HAINING
 Senior Vice President
 (949) 724-4711
 thaining@lee-associates.com
 BRE# 01483191

RYAN LAWLER
 Associate
 (949) 724-4718
 rlawler@lee-associates.com
 BRE# 01935961



AVAILABLE FOR LEASE
±18,920 SQ. FT. CREATIVE OFFICE BUILDING
75 DOPPLER | IRVINE, CA



For more information, please contact:

ALTON BURGESS
Senior Vice President
(949) 724-4722
aburgess@lee-associates.com
BRE# 01717094

TRAVIS HAINING
Senior Vice President
(949) 724-4711
thaining@lee-associates.com
BRE# 01483191

RYAN LAWLER
Associate
(949) 724-4718
rlawler@lee-associates.com
BRE# 01935961

LEE & ASSOCIATES
COMMERCIAL REAL ESTATE SERVICES
LEE & ASSOCIATES - NEWPORT BEACH, INC.
A member of the Lee & Associates Group of Companies