

FOR LEASE

±14,200 SF Freestanding Warehouse Building

2756 Main Street, Chula Vista, CA 91911



Property Features:

- ±14,200 SF Warehouse Space
- 1 Reception, 4 Offices & 2 Restrooms
- Drive Around Access
- Large Fenced Yard
- Sprinklered
- 11 Grade Level Door & 2 Dock Wells
- Walking Distance to Public Transportation and Numerous Retail Amenities

Monthly Lease Rate:

\$0.75 Gross/SF

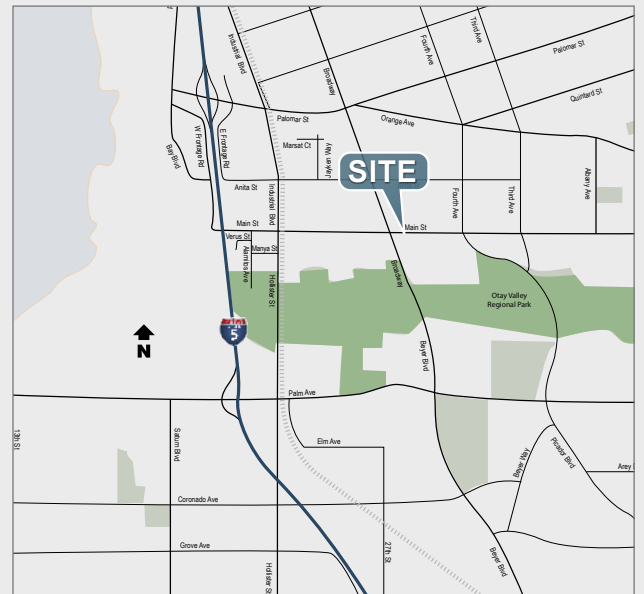

Michael Mossmer

Senior Vice President
Lic #00998326
858.458.3347
mmossmer@voitco.com

Curt Perry

Senior Associate
Lic #01466077
858.458.3304
cperry@voitco.com

4747 Executive Dr., Suite 800, San Diego, CA 92121
858.453.0505 | 858.408.3976 Fax | Lic #01333376 | www.voitco.com

Voit
REAL ESTATE SERVICES

MPG
MOSSMER
PERRY GROUP

FOR LEASE

±14,200 SF Freestanding Warehouse Building

2756 Main Street, Chula Vista, CA 91911

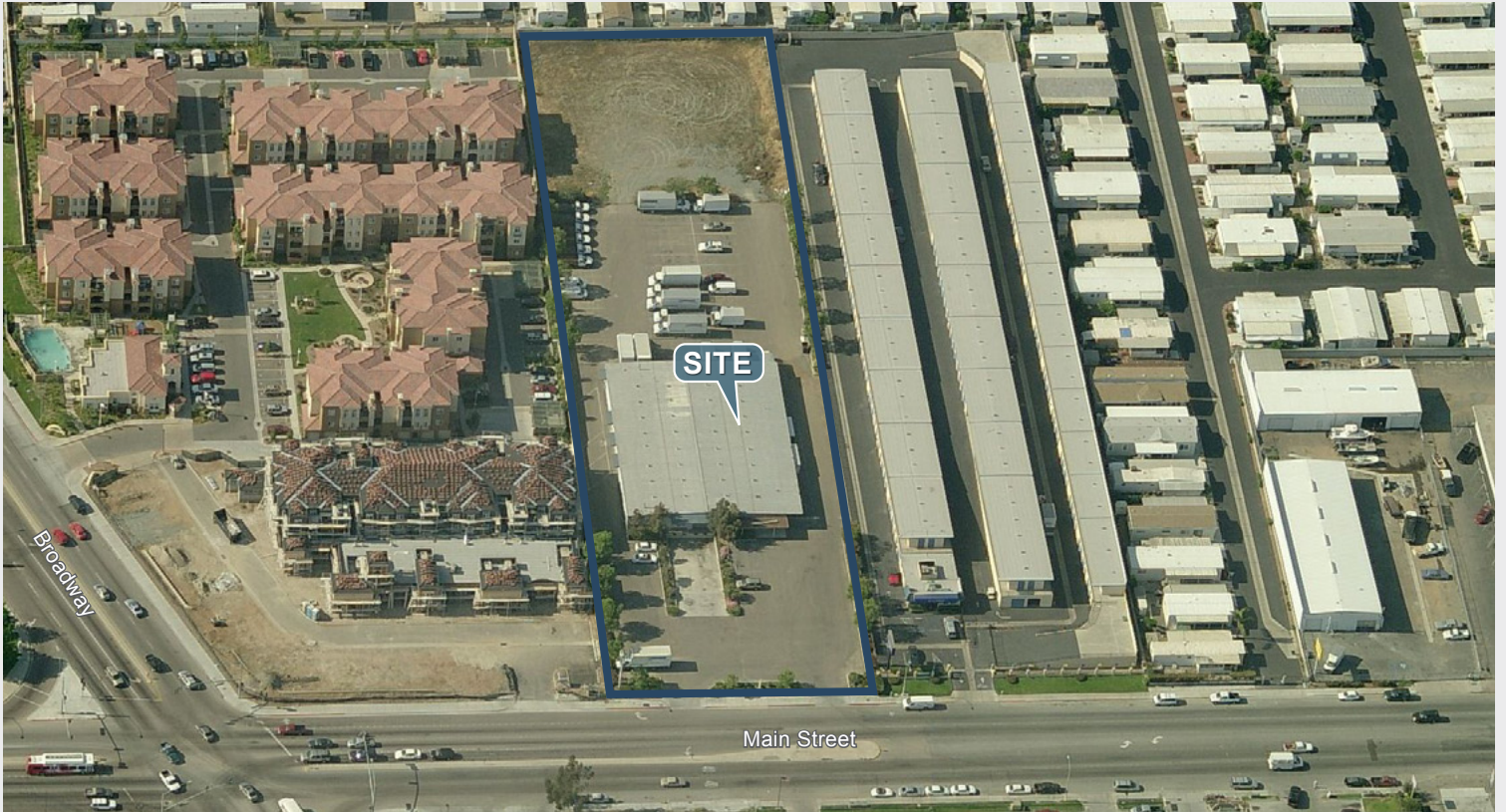

Michael Mossmer
Senior Vice President
Lic #00998326
858.458.3347
mmossmer@voitco.com

Curt Perry
Senior Associate
Lic #01466077
858.458.3304
cperry@voitco.com

4747 Executive Dr., Suite 800, San Diego, CA 92121
858.453.0505 | 858.408.3976 Fax | Lic #01333376 | www.voitco.com

Voit
REAL ESTATE SERVICES

MPG
MOSSMER
PERRY GROUP

FOR LEASE

±14,200 SF Freestanding Warehouse Building

2756 Main Street, Chula Vista, CA 91911



- 6 Miles to International Mexican Border
- 14 Miles to San Diego International Airport & Downtown San Diego

Michael Mossmer

Senior Vice President
Lic #00998326
858.458.3347
mmossmer@voitco.com

Curt Perry

Senior Associate
Lic #01466077
858.458.3304
cperry@voitco.com

4747 Executive Dr., Suite 800, San Diego, CA 92121
858.453.0505 | 858.408.3976 Fax | Lic #01333376 | www.voitco.com

Voit
REAL ESTATE SERVICES

MPG
MOSSMER
PERRY GROUP