

## Retail 24/7.

FOR LEASE :: SEATTLE, WA 98133

PRIME RETAIL SPACE

**AVAILABLE:** ±1,202 sq. ft.; \$2,550/Mo NNN (as-is)  
±1,070 sq. ft.; \$2,675/Mo NNN (as-is)

**HIGHLIGHTS:** Good visibility from Greenwood Avenue North

Quick access to Aurora Avenue North and I-5

Competitive marketplace rent

Average weekly traffic count along Greenwood Avenue North of 21,936 VPD

# 14419 GREENWOOD AVENUE NORTH

INTERSECTION OF GREENWOOD AVE. NORTH AND N. 145TH STREET

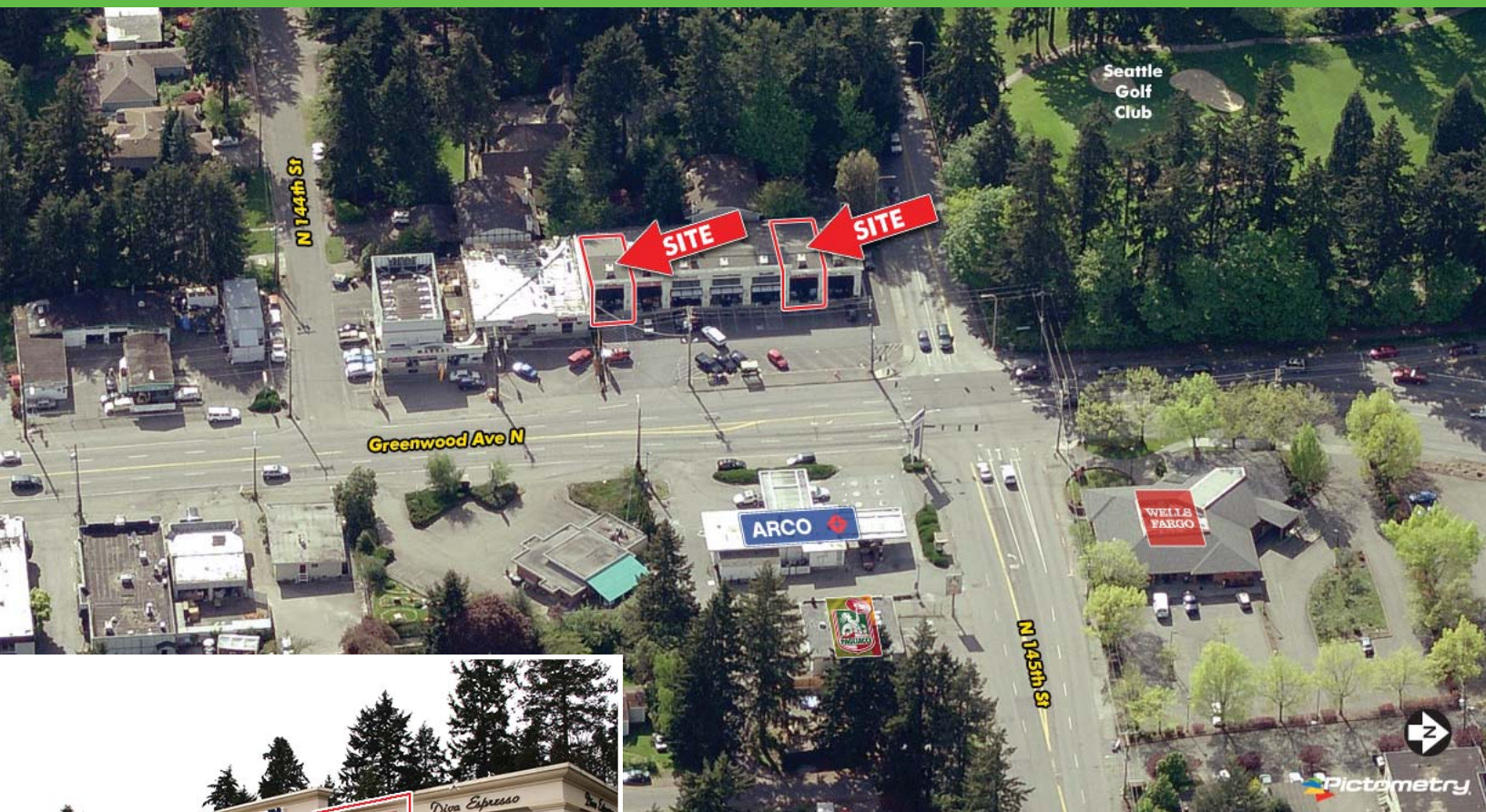

FOR MORE INFORMATION CONTACT:

**John F. Miller, Jr.**

Vice President

+1 206 292 6106

jfmiller@cbre.com

**CBRE**

FOR  
LEASE

Retail 24/7.

# 14419 GREENWOOD AVENUE NORTH

SEATTLE, WASHINGTON 98133

FLOOR  
PLAN  
± 1,070 sq. ft.  
Available



AREA  
MAP

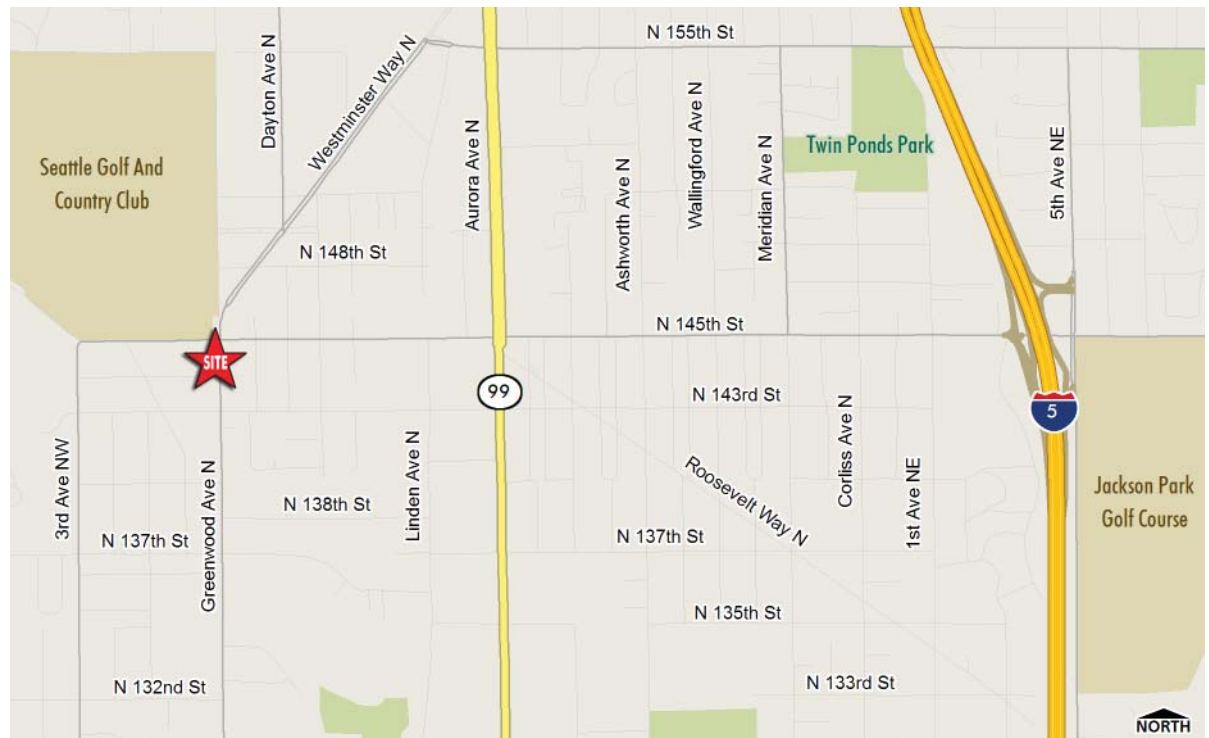

FOR MORE  
INFORMATION  
PLEASE  
CONTACT

**John F. Miller, Jr.**  
Vice President  
+1 206 292 6106  
jfmiller@cbre.com

CBRE, Inc. | 1420 Fifth Avenue | Suite 1700 | Seattle, WA 98101 | F 206.292.6033

[www.cbre.com/  
seattle](http://www.cbre.com/seattle)

© 2014 CBRE, Inc. This information has been obtained from sources believed reliable. We have not verified it and make no guarantee, warranty or representation about it. Any projections, opinions, assumptions or estimates used are for example only and do not represent the current or future performance of the property. You and your advisors should conduct a careful, independent investigation of the property to determine to your satisfaction the suitability of the property for your needs. Photos herein are the property of their respective owners and use of these images without the express written content of the owner is prohibited. CBRE and the CBRE logo are service marks of CBRE, Inc. and/or its affiliated or related companies in the United States and other countries. All other marks displayed on this document are the property of their respective owners. cqm 02-13-14

**CBRE**