

FOR SALE

Former Bank Branch

5730 UNIVERSITY BLVD W | JACKSONVILLE, FL

RETAIL



PROPERTY FEATURES

This former bank branch is located on University Blvd W. in between I-95 and Beach Blvd. University Blvd W. is a heavily commercialized corridor with several retail projects nearby including grocery stores such as Freshfield Farm, Harvey’s Supermarkets and Save-a-lot. Approximately 1 mile to the north is the 418 bed Memorial Hospital and the Brooks Rehabilitation Hospital. With over 390 feet of frontage on University Blvd. and access to the Barnes Rd. S traffic signal via a rear internal road, this is a great opportunity to repurpose the building or redevelop the entire site.

CONTACT US

Collis McGeachy
+1 904 630 6356
collis.mcgeachy@cbre.com

Bruce Jackson
+1 904 630 6345
bruce.jackson@cbre.com

PROPERTY DETAILS

Building Size:	6,424 SF w/ 4 drive-thru lanes
Land Size:	1.23 Acres
Zoning:	CCG-1
Year Built:	1974
Parcel ID:	152624-0030
2019 Annual RE Taxes:	\$22,014.04
Sales Price:	\$950,000.00 \$915,000.00

NOTE: Adjacent carwash to the west on 0.26 acres available for purchase (separately owned).

www.cbre.com/jacksonville

CBRE, Inc. | 225 Water Street | Suite 110 | Jacksonville, FL 32202



FOR SALE

Former Bank Branch

5730 UNIVERSITY BLVD W | JACKSONVILLE, FL



SURVEY

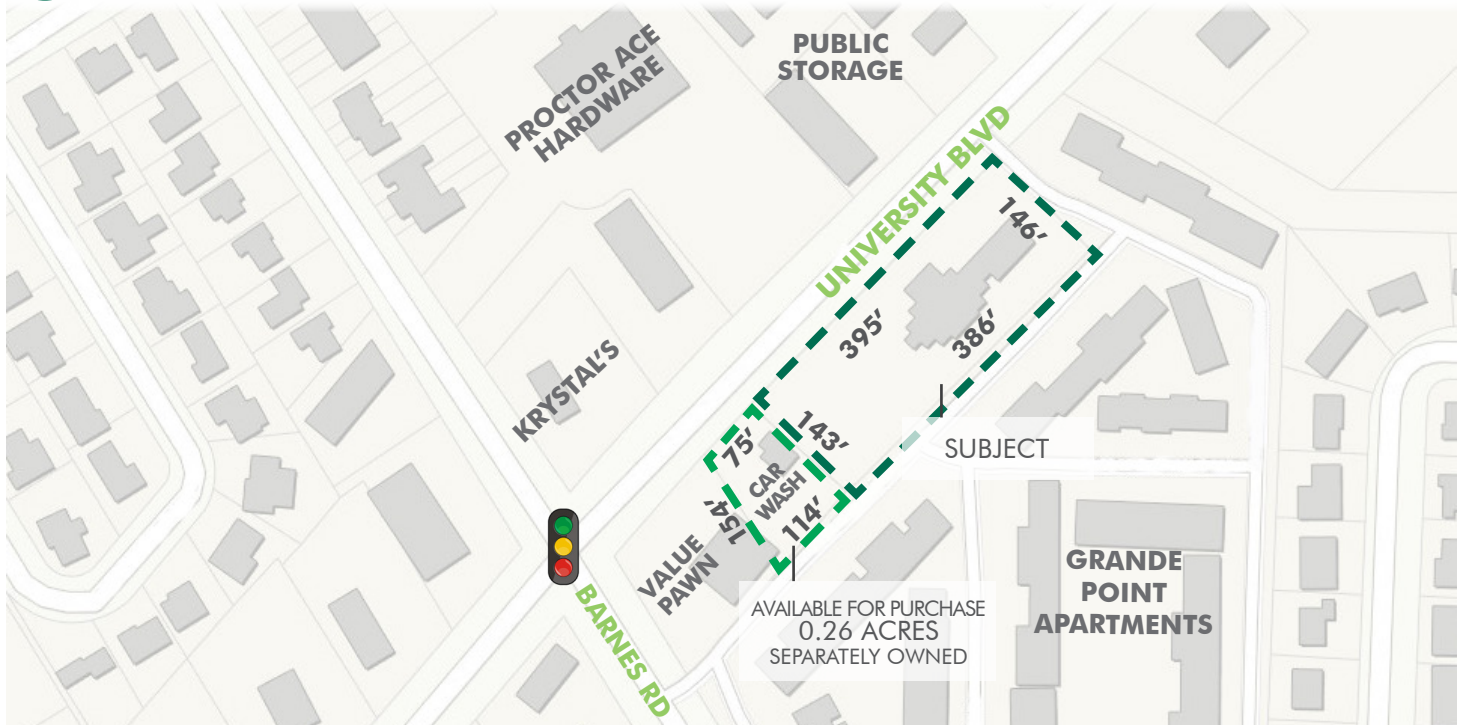

RETAIL



FOR SALE

Former Bank Branch

5730 UNIVERSITY BLVD W | JACKSONVILLE, FL

RETAIL

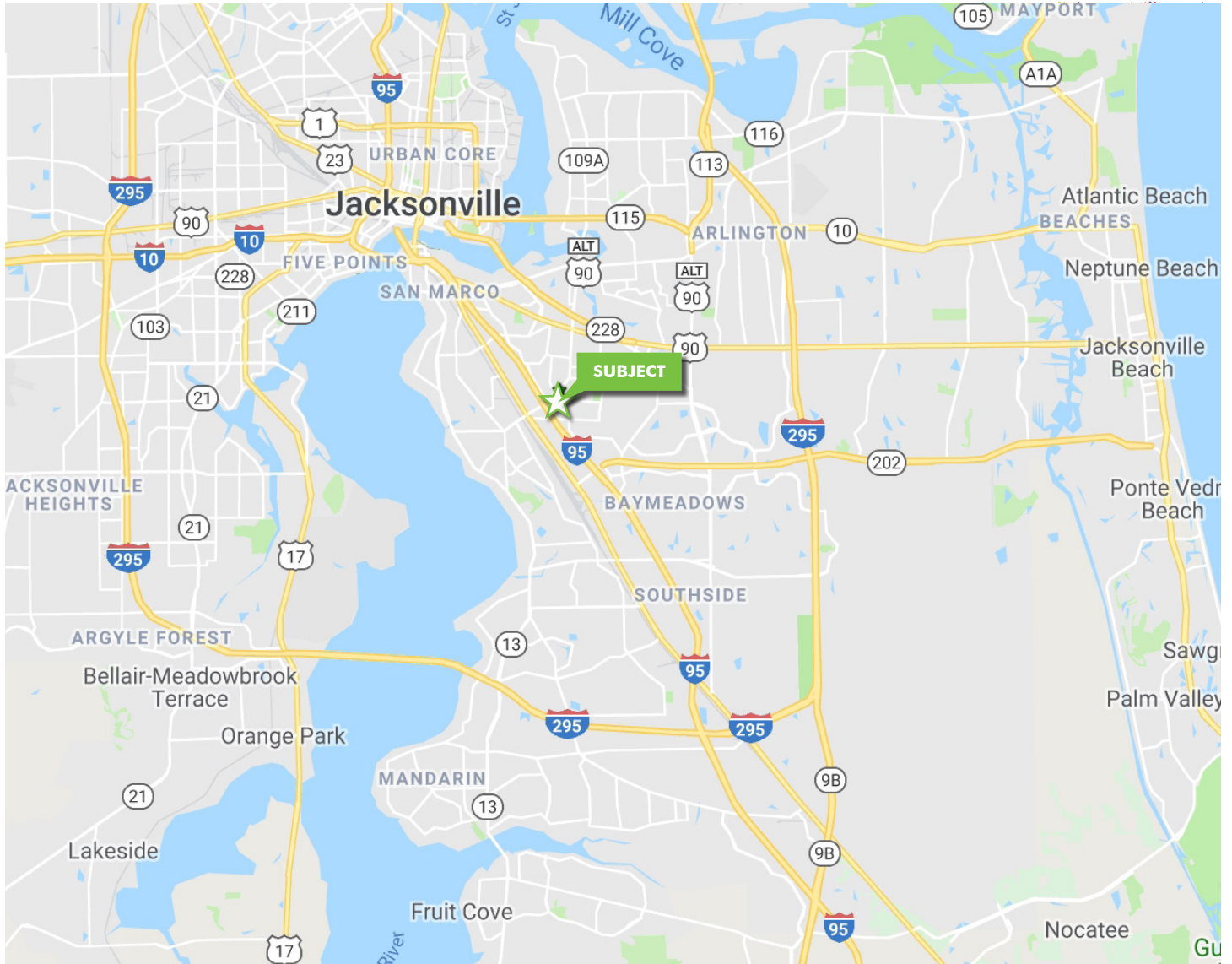

2019 Estimated Demographics	1 mile	3 miles	5 miles
Population	11,550	76,379	180,215
Median Age	41.2	39.7	37.0
Est. Population Growth Rate 2019-2024	1.39%	1.05%	1.21%
Average Household Income	\$53,747	\$64,300	\$65,266
Average Home Value	\$170,065	\$240,596	\$244,608

CONTACT US

Collis McGeachy

Vice President
 +1 904 630 6356
 collis.mcgeachy@cbre.com

Bruce Jackson

First Vice President
 +1 904 630 6345
 bruce.jackson@cbre.com

© 2020 CBRE, Inc. All rights reserved. This information has been obtained from sources believed reliable, but has not been verified for accuracy or completeness. You should conduct a careful, independent investigation of the property and verify all information. Any reliance on this information is solely at your own risk.

www.cbre.com/jacksonville