

500  
East 4<sup>th</sup> Street



500 East 4th Street Fort Worth, TX

### *Building Features*

- Spec Suites Under Construction with Class A Historic Finishes
- Located in Downtown Fort Worth; Two Blocks East of Sundance Square
- Immediate Access to Airport Freeway, I-30 & I-35
- Local Stabilized Ownership
- Document Storage Facility On-Site
- 3:1,000 Parking Ratio



1:1,000 Free Parking\*

### *Contact*

Geoff Shelton • 817.710.1113  
gshelton@hlfortworth.com

Marshall Mays • 817.632.6150  
mmays@hlfortworth.com

Matt Carthey • 817.710.1111  
mcarthey@hlfortworth.com



# 500 East 4<sup>th</sup> Street

## Available Space

### 500 East 4<sup>th</sup> - Floor 1

**Suite 150**  
**1,976 RSF**

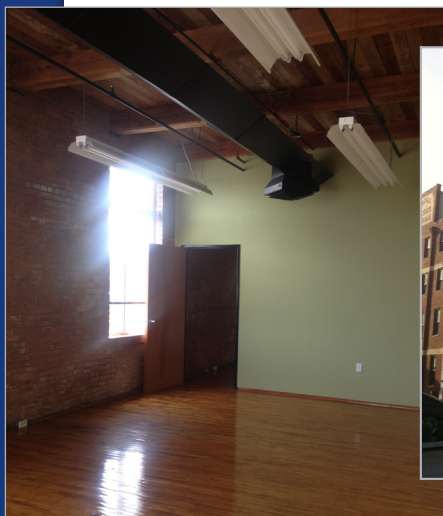
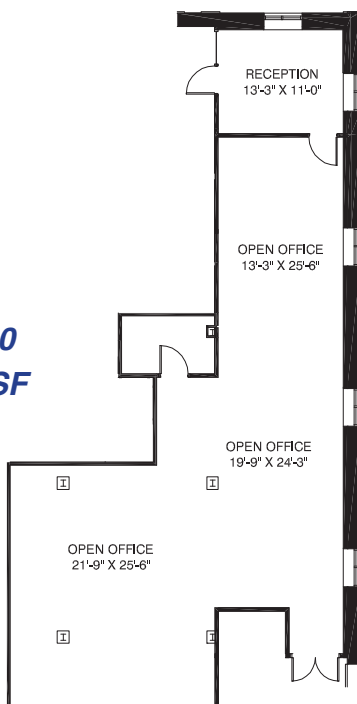

### Contact

Geoff Shelton • 817.710.1113  
gshelton@hlfortworth.com

Marshall Mays • 817.632.6150  
mmays@hlfortworth.com

Matt Carthey • 817.710.1111  
mcarthey@hlfortworth.com





# 500 East 4<sup>th</sup> Street

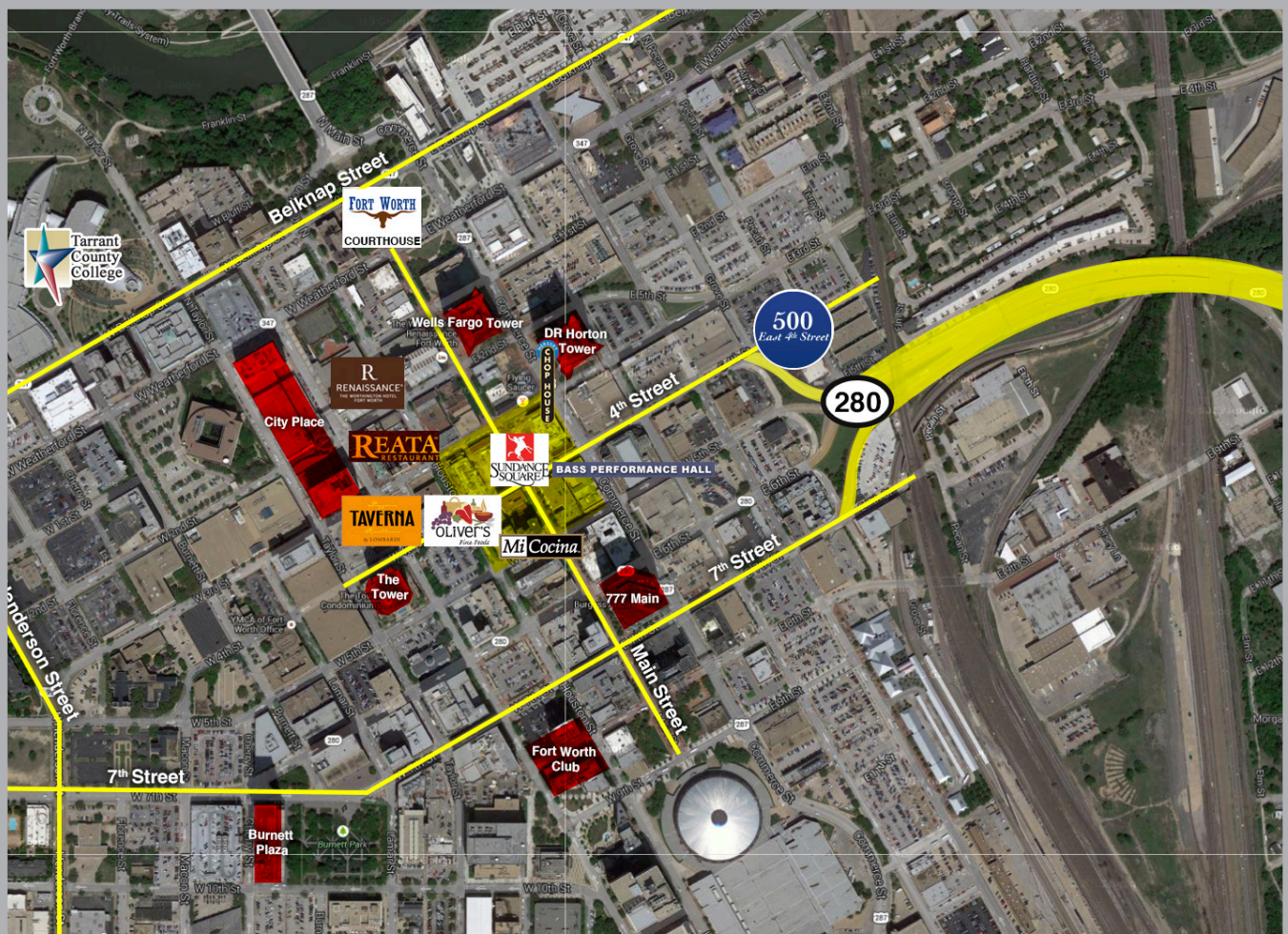

## Contact

Geoff Shelton • 817.710.1113  
gshelton@hlfortworth.com

Marshall Mays • 817.632.6150  
mmays@hlfortworth.com

Matt Carthey • 817.710.1111  
mcarthey@hlfortworth.com

