



PROPERTY HIGHLIGHTS

- Located on the NE Corner of 6 Mile and Newburgh Roads, Adjacent to FedEx
- 1,375 Sq. Ft. Available
- Tenants Include: Jersey Mike's Subs, H&R Block and Verizon
- 49 Parking Spaces
- East of I-96 Freeway
- Next to Busy Laurel Park Place Shopping Mall
- Traffic Counts on 6 Mile Road: 36,794 VPD

DEMOGRAPHICS

	1 MILE	3 MILES	5 MILES
Total Households	3,412	26,067	86,779
Total Population	9,256	67,065	209,863
Average HH Income	\$103,140	\$94,042	\$84,206



GREG MALLORY

248.855.1221
 gmallory@armadarealestate.com

7001 ORCHARD LAKE ROAD | WEST BLOOMFIELD TOWNSHIP | MI 48322
 248.855.1221 | ARMADAREALESTATE.COM



SITE PLAN

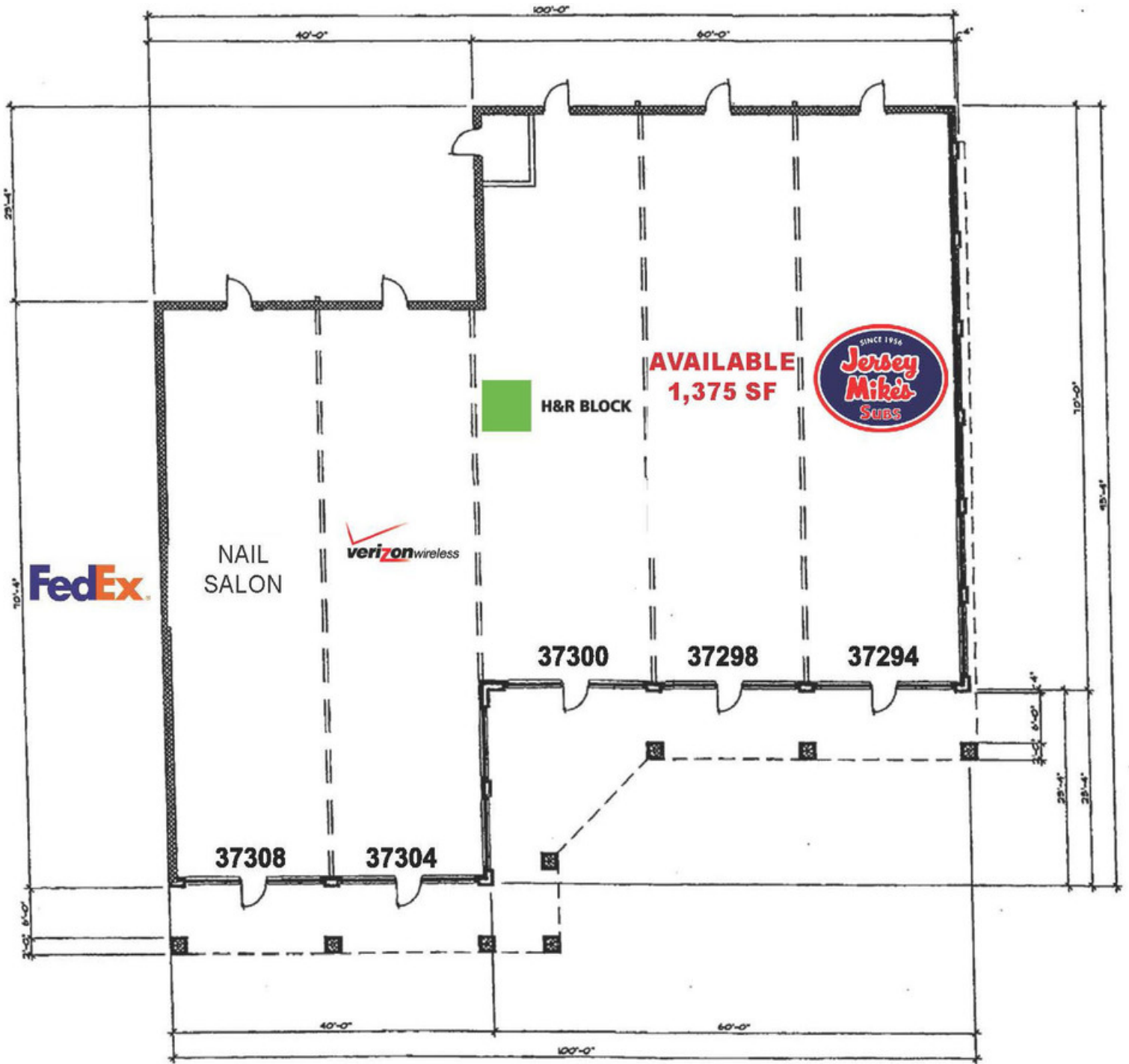

GREG MALLORY

248.855.1221
 gmallory@armadarealestate.com

7001 ORCHARD LAKE ROAD | WEST BLOOMFIELD TOWNSHIP | MI 48322
 248.855.1221 | ARMADAREALESTATE.COM



RETAIL MAP



GREG MALLORY

248.855.1221

gmallory@armadarealestate.com

7001 ORCHARD LAKE ROAD | WEST BLOOMFIELD TOWNSHIP | MI 48322

248.855.1221 | ARMADAREALESTATE.COM



