

Clocktower Village

999 Whitlock Ave SE
Marietta, Georgia 30064

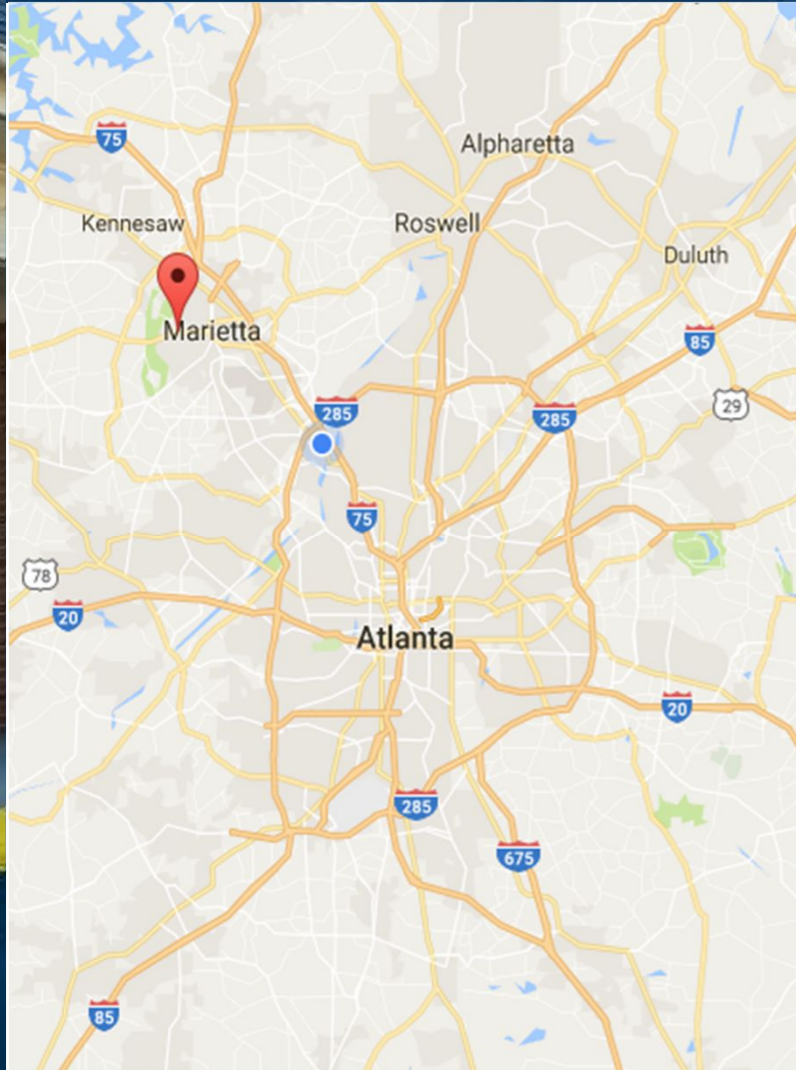

Leasing Contacts

Jon Flaig: (678) 501-5342

Marrissa Chanin: (678) 501-5341

Email: info@riverwoodproperties.com

Clocktower Village is a 27,590 SF property located on Whitlock Ave in the densely populated downtown Marietta area. The site offers an easily accessible entrance with plenty of parking for customers.

Intersection: Whitlock Ave SW & Burnt Hickory Rd NW

Daily Traffic Counts: 29,234 cars per day

Site Access: Property is accessible either on Whitlock Ave or on Old Dallas Rd.

Clocktower Village

1	Marietta Doggy Daycare	1,500
1A	<i>Retail Space Available</i>	<i>1,250</i>
2	<i>Retail Space Available</i>	<i>1,500</i>
3	<i>Retail Space Available</i>	<i>1,050</i>
4	<i>Retail Space Available</i>	<i>1,250</i>
5	Carriage House Catering	5,278
6	Dreams Come True Salon	1,046
7	<i>Doctors Office Available</i>	<i>1,753</i>
8	Optimal Hearing	1,000
9	Edward Jones	800
10	<i>Retail Space Available</i>	<i>892</i>
11	Center for Healthy and Healing	1,828
12	<i>Built Out Office Space Available</i>	<i>1,457</i>
13	Air Force Reserve	2,812
15	<i>Retail Space Available</i>	<i>2,243</i>
16	Air Force	2,406

GLA: 27,166 SF

Availability: 892-5,050 SF

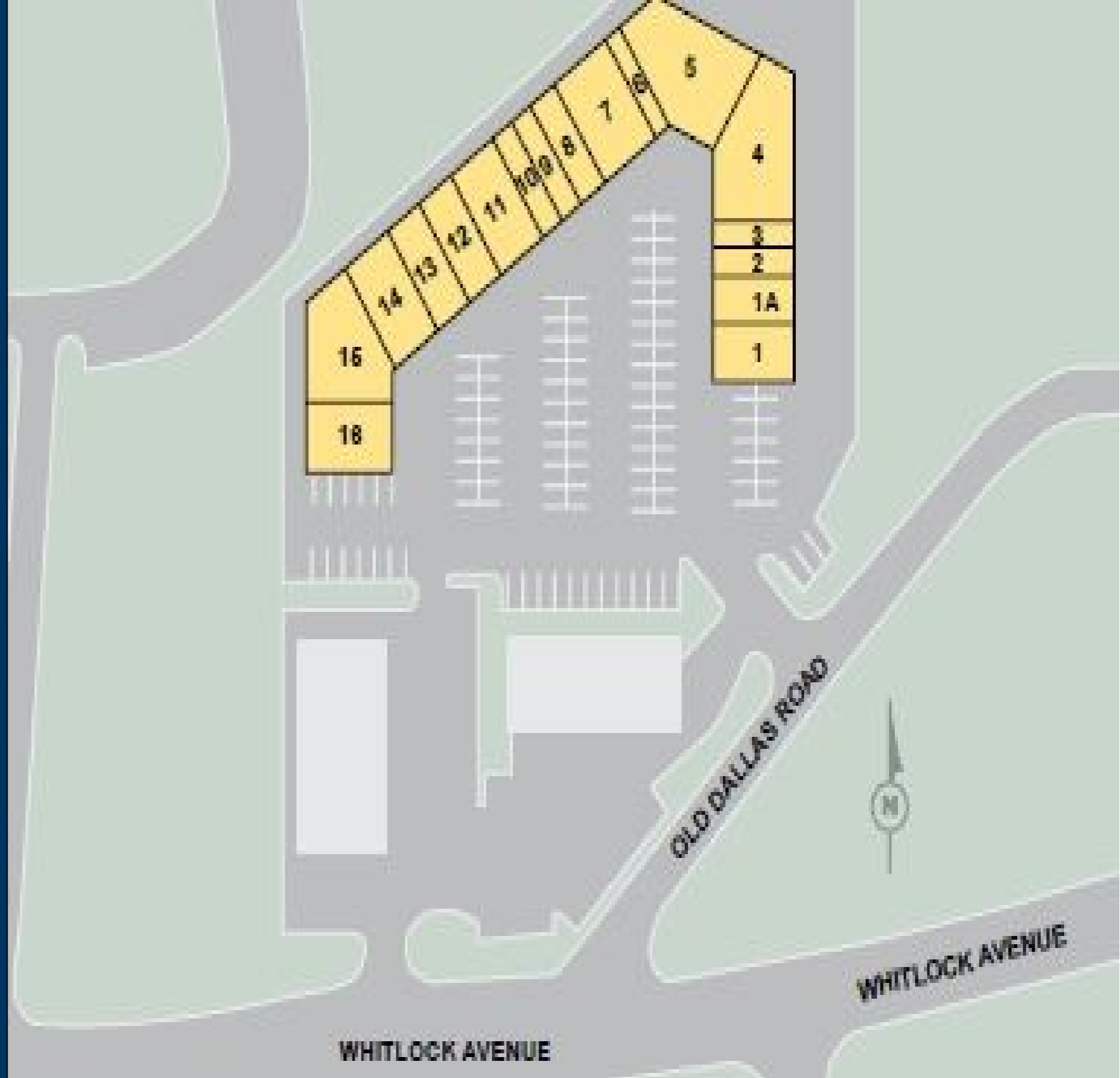

CLOCKTOWER VILLAGE

Site Plan

AREA DEMOGRAPHICS



2016
Population

1 MILE	6,645
3 MILE	53,946
5 MILE	174,454



Estimated Population
Growth

1 MILE	6.38%
3 MILE	6.90%
5 MILE	7.41%



Household 2016

1 MILE	2,867
3 MILE	20,138
5 MILE	64,533



Household
Income

1 MILE	\$92,316
3 MILE	\$75,139
5 MILE	\$73,300



CLOCKTOWER VILLAGE

Trade Area Overview

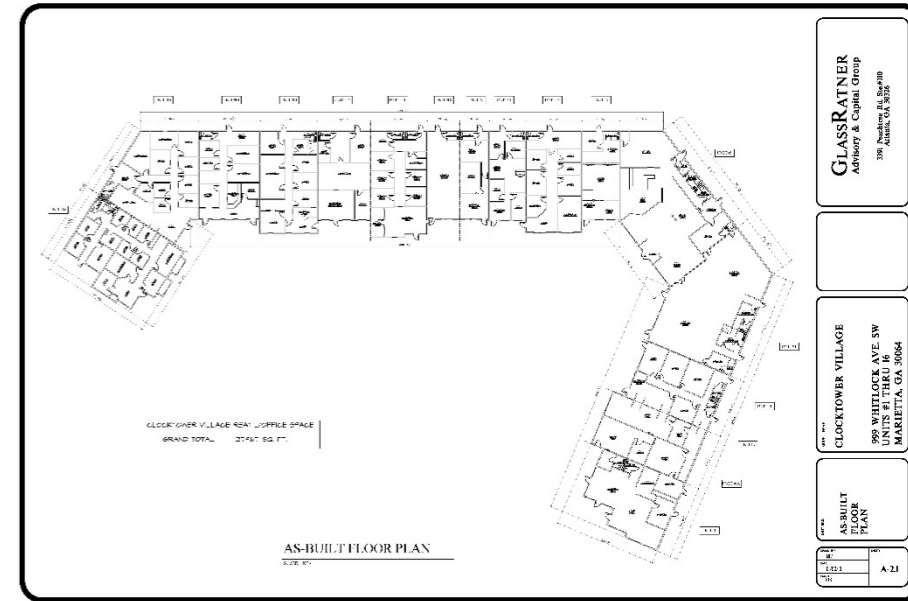

CLOCKTOWER VILLAGE

Property Photos and Site Plan

