

E. PACES FERRY ROAD & GRANDVIEW AVENUE

359 E. Paces Ferry Road, Atlanta, GA 30305

EXECUTIVE SUMMARY



LOCATION OVERVIEW

Prime restaurant opportunity with rooftop terrace



PROPERTY HIGHLIGHTS

- Planned Class A office tower anchored by State Bank
- 1 block east of Buckhead Atlanta
- 1 space available - 4,346 SF (located on the pin corner of Buckhead Avenue & Grandview Avenue)
- Estimated completion late 3rd Quarter 2017
- GA DOT Traffic Counts: East Paces Ferry Road - 7,550 AADT

DEMOGRAPHICS

	1 MILE	3 MILES	5 MILES
Population	20,594	133,072	333,280
Daytime Population	80,720	213,613	558,800
Average Household Income (\$)	124,248	131,567	123,619

EXCLUSIVE AGENT(S)

STEPHANIE MCCALL • stephanie.mccall@tscg.com • 770.955.2434

STACI SPANGLER • staci.spangler@tscg.com • 770.955.2434

RETAIL PROPERTY FOR LEASE

E. PACES FERRY ROAD & GRANDVIEW AVENUE

359 E. Paces Ferry Road, Atlanta, GA 30305

ADDITIONAL PHOTOS



EXCLUSIVE AGENT(S)

STEPHANIE MCCALL • stephanie.mccall@tscg.com • 770.955.2434

STACI SPANGLER • staci.spangler@tscg.com • 770.955.2434

No warranty expressed or implied has been made as to the accuracy of this information, no liability assumed for errors or omissions.

TSCGTM

E. PACES FERRY ROAD & GRANDVIEW AVENUE

359 E. Paces Ferry Road, Atlanta, GA 30305

SITE PLAN

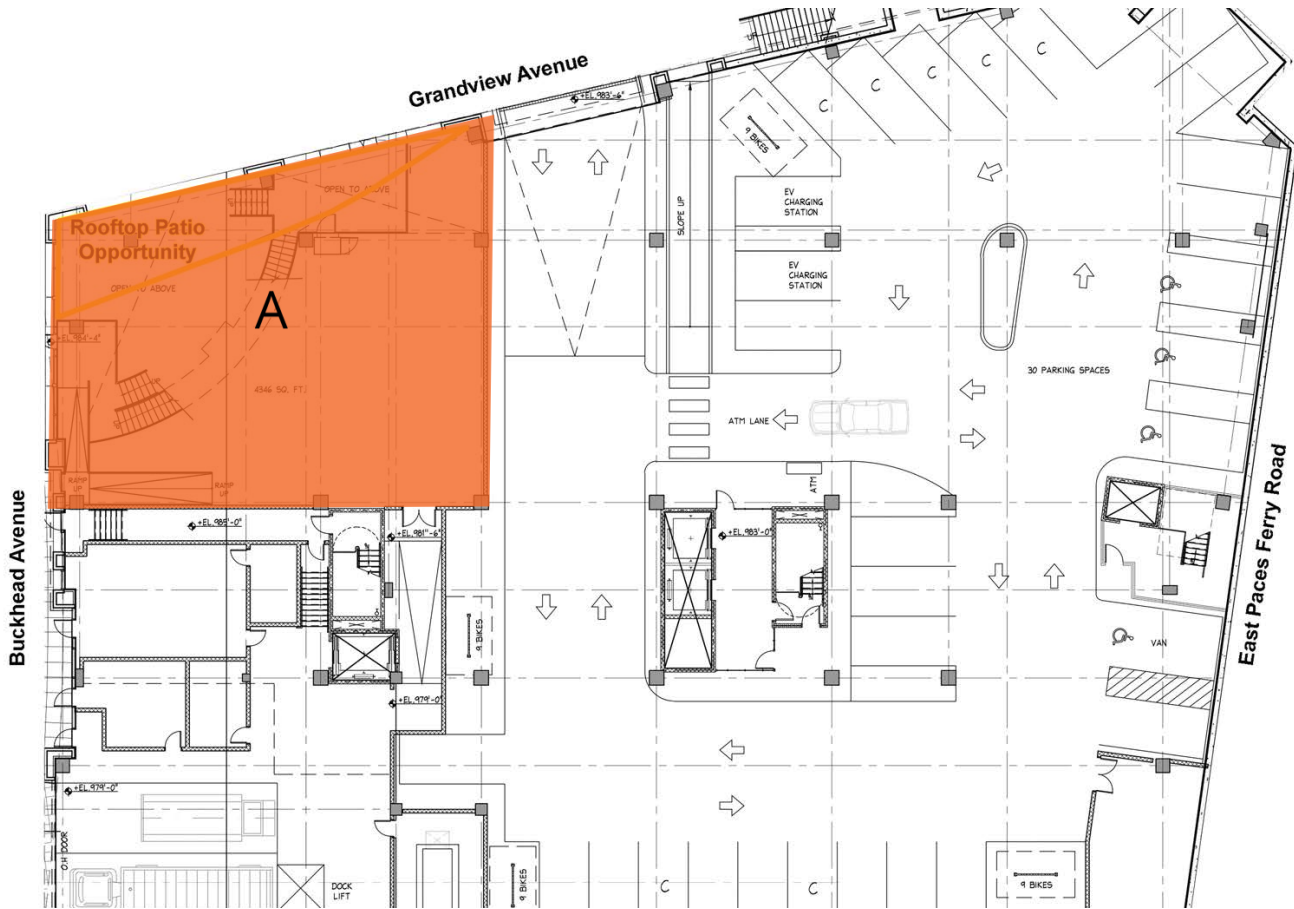

AVAILABLE

SUITE

TENANT NAME

SPACE SIZE

A

Available

4,346 SF

EXCLUSIVE AGENT(S)

STEPHANIE MCCALL • stephanie.mccall@tscg.com • 770.955.2434

STACI SPANGLER • staci.spangler@tscg.com • 770.955.2434