

# 822 E CENTERVILLE

## BIG BOX & PAD SITE

### GARLAND, TEXAS

SEC CENTERVILLE & BROADWAY

CHARLOTTE COOPER

JOHN ZIKOS

**30,109 SF  
Available**



LEASING | TENANT REPRESENTATION | LAND | INVESTMENT SALES | PROPERTY MANAGEMENT

### HIGHLIGHTS

- 5 Point intersection
- Dense population
- Freestanding building with pylon signage
- Co-tenancy with Ross's new concept dd's Discounts

2 MILE RADIUS

GARLAND RD

SATURN RD

MILLER RD

1<sup>ST</sup> ST

CENTERVILLE RD

KINGSLEY RD

Save A Lot  
Fiesta  
CVS

Walgreens

dds

DOLLAR TREE

Former  
Safeway

Former  
Super Foods

Former  
Safeway

Former  
Safeway

Former  
Safeway

Former  
Safeway

Former  
Safeway

Former  
Safeway

Former  
Safeway

Former  
Safeway

Former  
Safeway

Former  
Safeway

Former  
Safeway

Former  
Safeway

Former  
Safeway

Former  
Safeway

Former  
Safeway

Former  
Safeway

Former  
Safeway

Former  
Safeway

Former  
Safeway

Former  
Safeway

Former  
Safeway

Former  
Safeway

Former  
Safeway

SITE

26,995 VPD

34,145 VPD

BROADWAY BLVD

WAL-MART

Lake Ray Hubbard

# 822 E CENTERVILLE

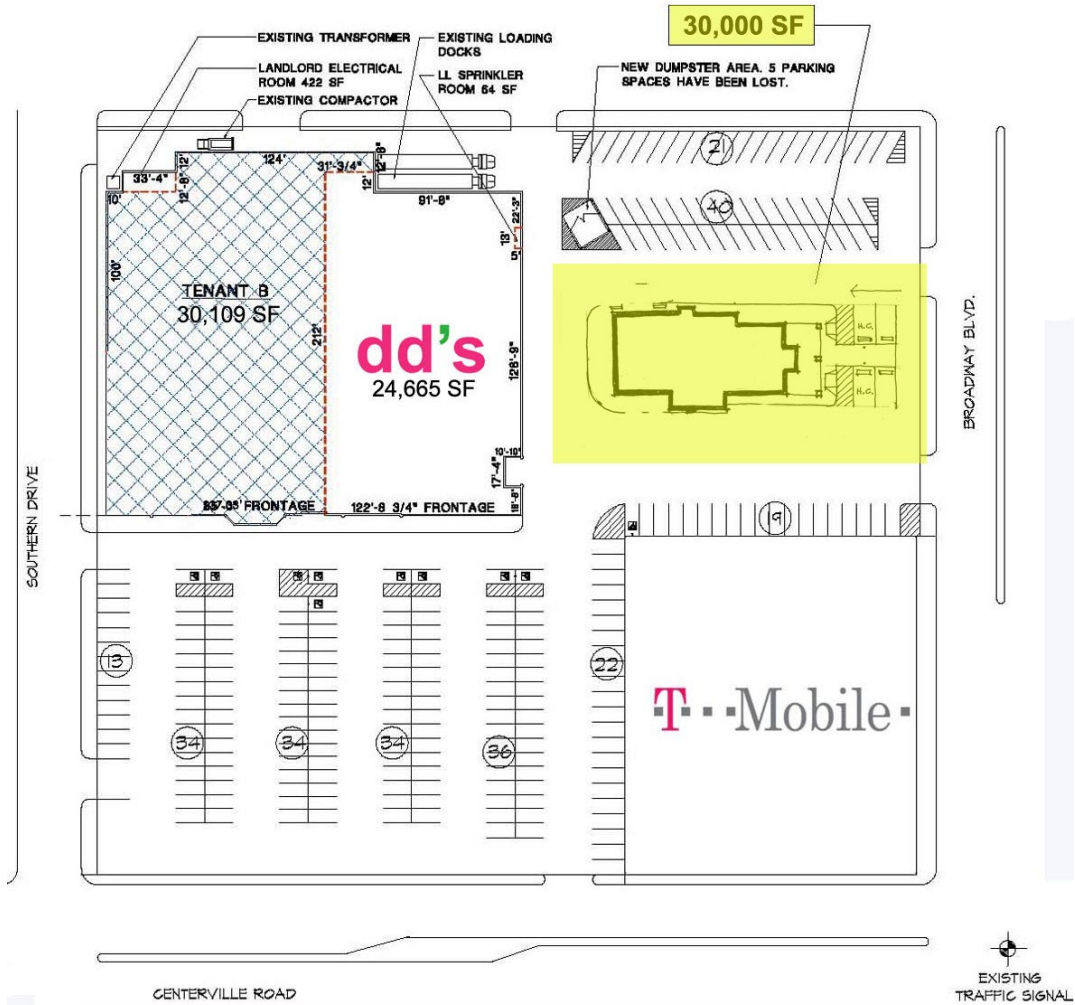

## PROPERTY INFORMATION

### LOCATION

Store #1504  
822 E Centerville  
Garland, Texas

### NNN

Tax \$1.32  
CAM \$0.34  
Ins. \$0.09  
Total \$1.75

### SIZE

30,109 SF (Pad Site Available)

## DEMOGRAPHICS

	1 MILE	3 MILE	5 MILE
2017 EST POPULATION	16,560	126,075	321,876
2017 EST AVG HH INCOME	\$72,691	\$65,165	\$67,932

## TRAFFIC COUNTS

BROADWAY	34,145 VPD
CENTERVILLE	27,208 VPD

