

FOR LEASE - 4,807 SF AVAILABLE

2560 TECHNOLOGY DRIVE

PLANO, TEXAS 75074



BUILDING HIGHLIGHTS

- 4,807 SF Available
- Currently in Shell Condition
- New Building (2016 Construction)
- 2.47/1,000 Parking Ratio
- SEC of Jupiter and Technology Rd
- Immediate access to President George Bush Turnpike and Central Expressway

LOCATION HIGHLIGHTS

- Plano Submarket

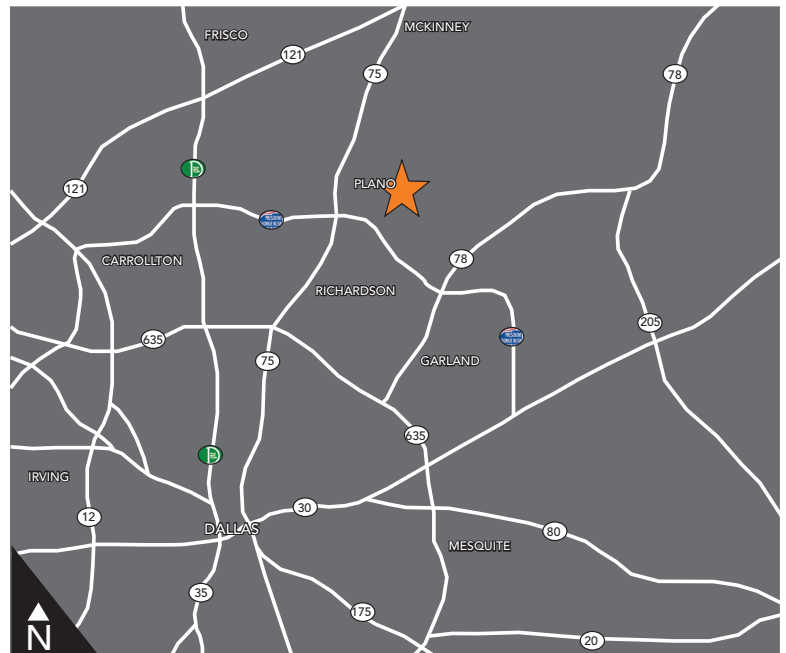

FOR INFORMATION CONTACT

EMILY RANKIN
214.446.4571
emily.rankin@transwestern.com

JOE WHITMER
214.446.4556
joe.whitmer@transwestern.com



The information provided herein was obtained from sources believed reliable; however, Transwestern makes no guarantees, warranties, or representations as to the completeness or accuracy thereof. The presentation of this property is submitted subject to errors, omissions, change of price or conditions, prior sale or lease, or withdrawal without notice. Copyright © 2017 Transwestern.

FOR LEASE - 4,807 SF AVAILABLE

2560 TECHNOLOGY DRIVE

PLANO, TEXAS 75074

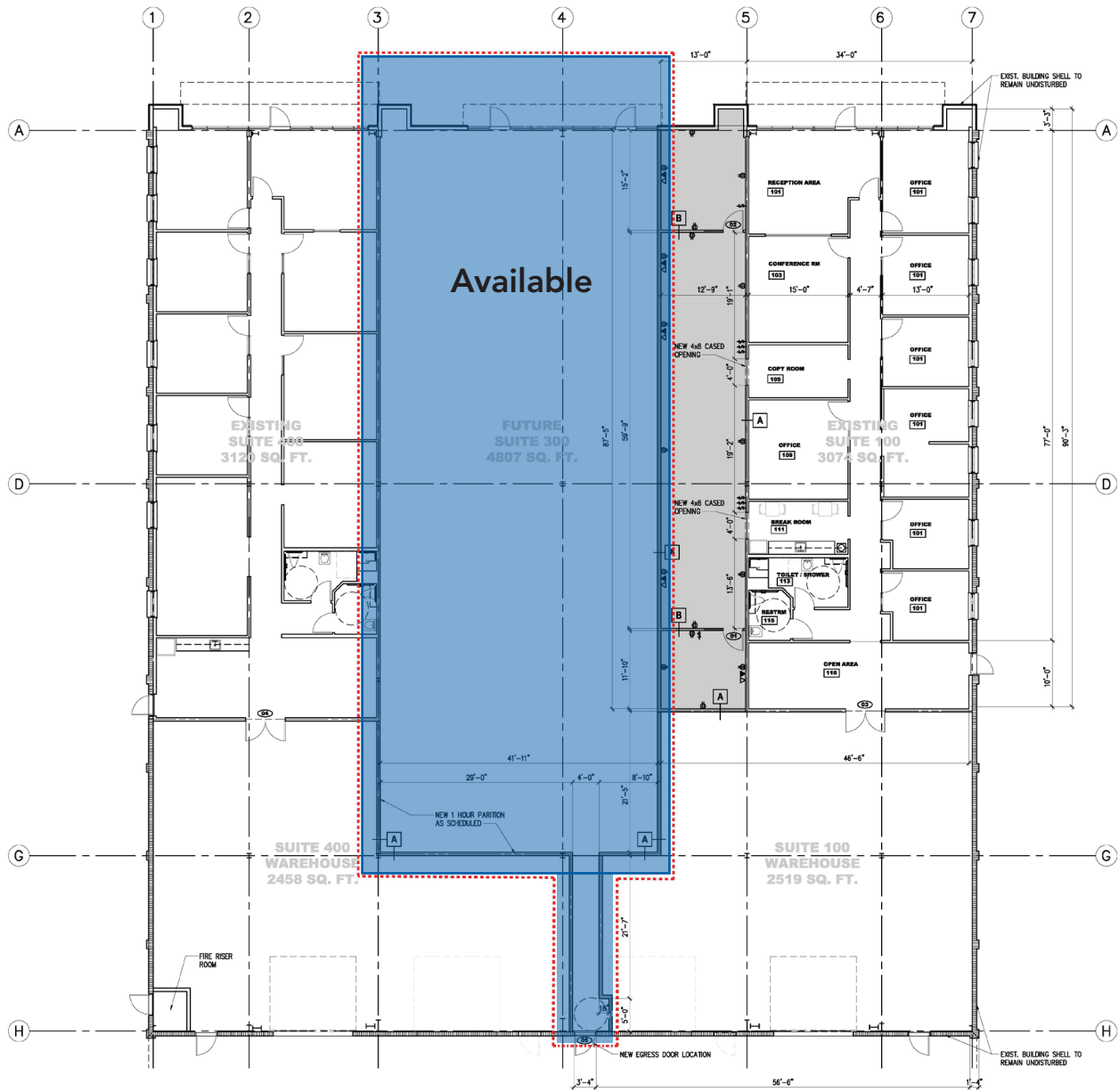

01 CONSTRUCTION PLAN
SCALE: 1/8" = 1' - 0"



FOR INFORMATION CONTACT

EMILY RANKIN
214.446.4571
emily.rankin@transwestern.com

JOE WHITMER
214.446.4556
joe.whitmer@transwestern.com



The information provided herein was obtained from sources believed reliable; however, Transwestern makes no guarantees, warranties, or representations as to the completeness or accuracy thereof. The presentation of this property is submitted subject to errors, omissions, change of price or conditions, prior sale or lease, or withdrawal without notice. Copyright © 2017 Transwestern.