

3640 NORTHGATE BLVD

S A C R A M E N T O , C A

OFFICE BUILDING FOR LEASE
Up to ±52,549 SF Available Immediately



Former call center space in a single-story building currently occupied in part by Wells Fargo Bank. We have up to ±52,549 contiguous square feet for lease. The space is divisible.

400 Capitol Mall, Suite 1800 - Sacramento, CA 95814
cushmanwakefield.com • CA License No: 00616335



3640 NORTHGATE BLVD

SACRAMENTO, CA

OFFICE BUILDING FOR LEASE
Up to ±52,549 SF Available Immediately

NATOMAS > OFFICE SPACE

3640 Northgate is located in the northeast quadrant of the popular and more expensive South Natomas marketplace, but offers office leasing opportunities consistent with North Natomas flex building rental rates.

BUILDING AMENITIES

- Single Story ± 69,783 SF building
- Up to ± 52,549 contiguous SF available Now
- Abundant Parking at 4.94/1,000 SF
- Direct Freeway Access to Highway 80
- Close to shopping, housing, restaurants and lodging
- Minutes to Downtown and the Sacramento International Airport (SMF)

LOCATION

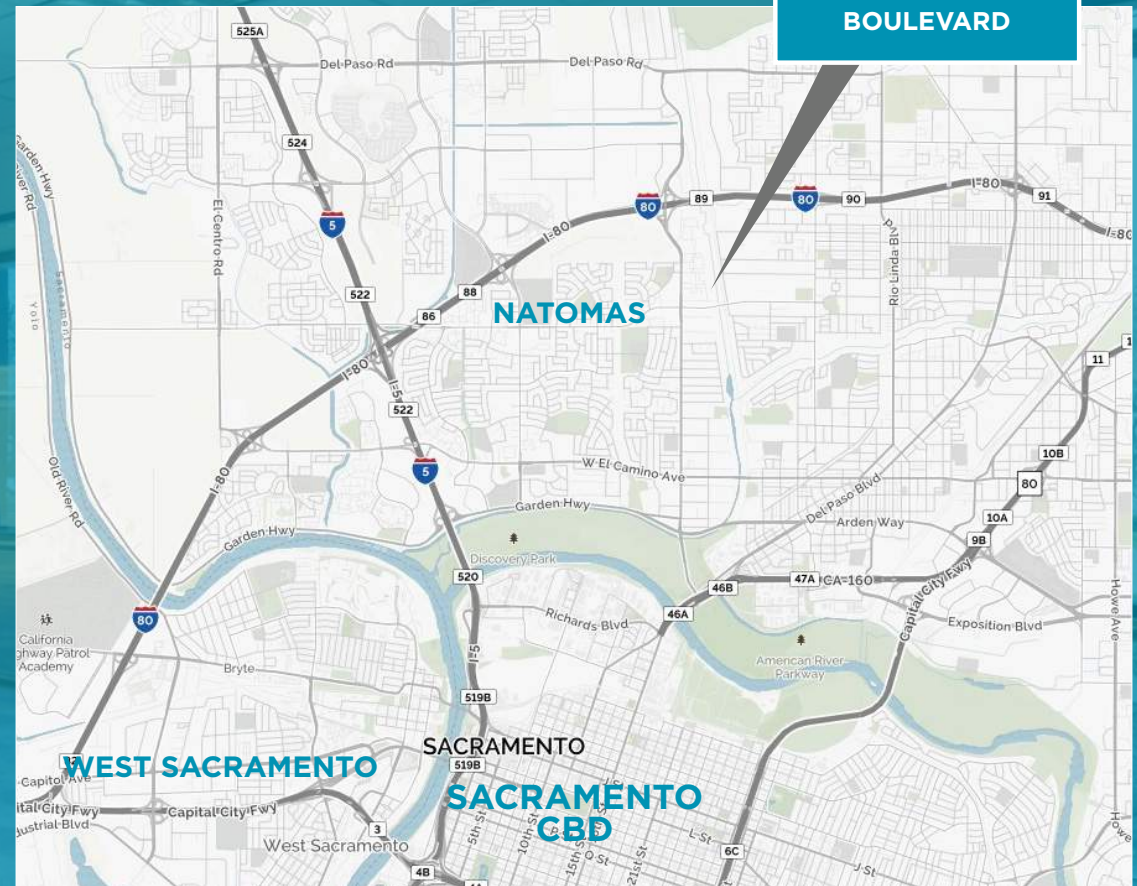

BRUCE HOHENHAUS, SIOR
Executive Director
(916) 288.4804
bruce.hohenhaus@cushwake.com
CA License No. 00677545

KEVIN PARTINGTON
Executive Director
(916) 288.4807
kevin.partington@cushwake.com
CA License No. 01199010

CHRIS SCHWARZE
Executive Director
(916) 288.4803
chris.schwarze@cushwake.com
CA License No. 01291261

400 Capitol Mall, Suite 1800 - Sacramento, CA 95814
cushmanwakefield.com • CA License No: 00616335 • Tel: 916 288 4800



3640 NORTHGATE BLVD

SACRAMENTO, CA

OFFICE BUILDING FOR LEASE
Up to ±52,549 SF Available Immediately

FLOOR PLANS

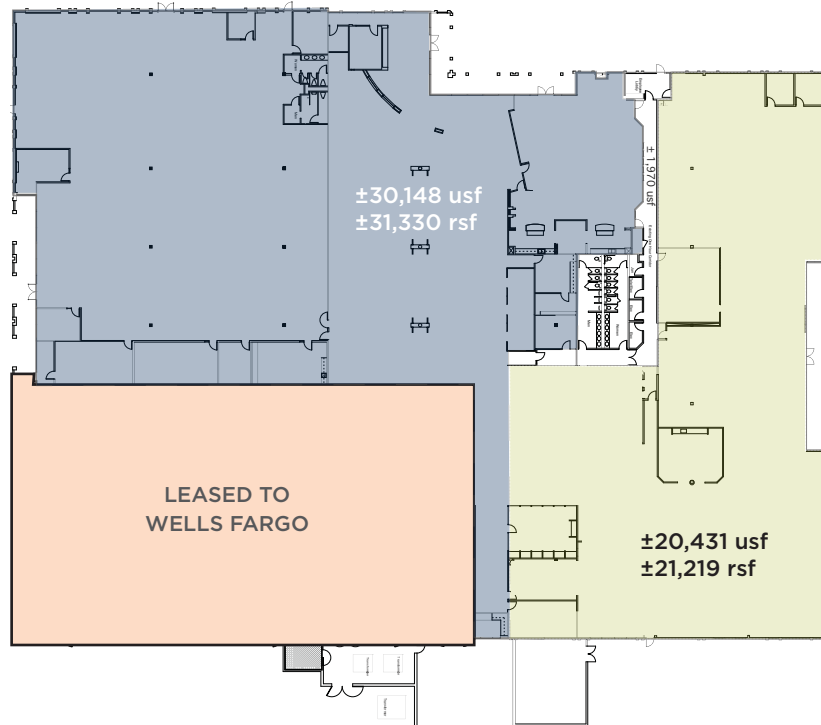

SITE PLAN

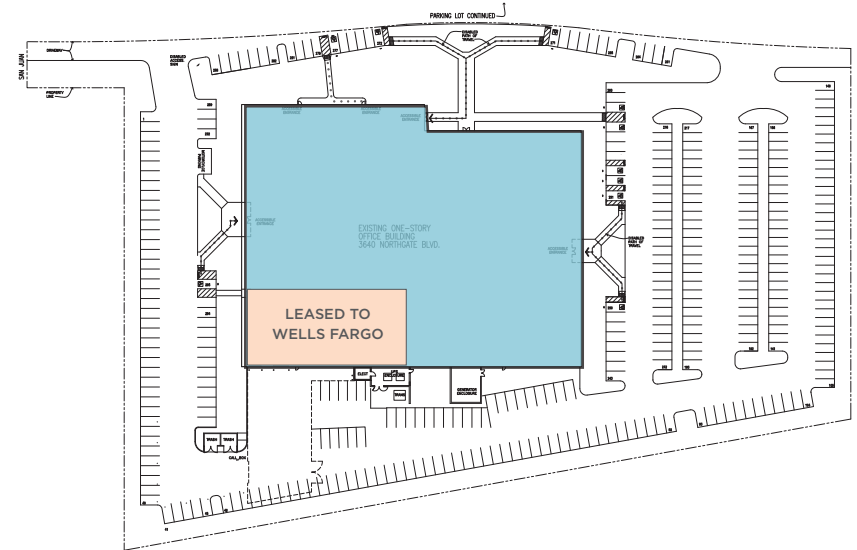

4.94/1,000 PARKING

UP TO ±52,549 SF AVAILABLE IMMEDIATELY
(DIVISIBLE AS SHOWN)

BRUCE HOHENHAUS, SIOR
Executive Director
(916) 288.4804
bruce.hohenhaus@cushwake.com
CA License No. 00677545

KEVIN PARTINGTON
Executive Director
(916) 288.4807
kevin.partington@cushwake.com
CA License No. 01199010

CHRIS SCHWARZE
Executive Director
(916) 288 4803
chris.schwarze@cushwake.com
CA License No. 01291261

400 Capitol Mall, Suite 1800 - Sacramento, CA 95814
cushmanwakefield.com • CA License No: 00616335 • Tel: 916 288 4800



3640
NORTHGATE BLVD
SACRAMENTO, CA



BRUCE HOHENHAUS, SIOR
Executive Director
(916) 288.4804
bruce.hohenhaus@cushwake.com
CA License No. 00677545

KEVIN PARTINGTON
Executive Director
(916) 288.4807
kevin.partington@cushwake.com
CA License No. 01199010

CHRIS SCHWARZE
Executive Director
(916) 288 4803
chris.schwarze@cushwake.com
CA License No. 01291261

400 Capitol Mall, Suite 1800 - Sacramento, CA 95814
cushmanwakefield.com • CA License No: 00616335 • Tel: 916 288 4800



3640 NORTHGATE BLVD

SACRAMENTO, CA

OFFICE BUILDING FOR LEASE
Up to ±52,549 SF Available Immediately



15MINS TO SACRAMENTO INTERNATIONAL AIRPORT

12MINS TO SACRAMENTO CENTRAL BUSINESS DISTRICT (CBD)

NEIGHBORHOOD AMENITIES

HOTELS		FOOD SERVICES	
1. EXTENDED STAY AMERICA HOTEL	1. 524 MEXICAN RESTAURANT	3. CARL'S JR	5. MCDONALD'S
2. ECONO LODGE SAC. NORTH HOTEL	2. IHOP	4. TACO BELL	

BRUCE HOHENHAUS, SIOR
Executive Director
(916) 288.4804
bruce.hohenhaus@cushwake.com
CA License No. 00677545

KEVIN PARTINGTON
Executive Director
(916) 288.4807
kevin.partington@cushwake.com
CA License No. 01199010

CHRIS SCHWARZE
Executive Director
(916) 288 4803
chris.schwarze@cushwake.com
CA License No. 01291261

400 Capitol Mall, Suite 1800 - Sacramento, CA 95814
cushmanwakefield.com • CA License No: 00616335 • Tel: 916 288 4800



3640 NORTHGATE BLVD

SACRAMENTO, CA

OFFICE BUILDING FOR LEASE

Up to ±52,549 SF Available Immediately

BRUCE HOHENHAUS, SIOR

Executive Director
(916) 288.4804
bruce.hohenhaus@cushwake.com
CA License No. 00677545

KEVIN PARTINGTON

Executive Director
(916) 288.4807
kevin.partington@cushwake.com
CA License No. 01199010

CHRIS SCHWARZE

Executive Director
(916) 288.4803
chris.schwarze@cushwake.com
CA License No. 01291261

400 Capitol Mall, Suite 1800 - Sacramento, CA 95814
cushmanwakefield.com • CA License No: 00616335

