

UNIQUE MOUNTAIN LAKES LOCATION

11,563 SF

(D I V I S I B L E)

OFFICE

AVAILABLE FOR LEASE

Available space

Floor	RSF	Type of space	Rent
1	7,751 RSF	Floor to ceiling glass and partially furnished	\$19.75 + TE
2	2,092 RSF	Significant windowline with potential for 4 windowed offices	\$19.75 + TE
2	1,720 RSF	Build to your unique style	\$19.75 + TE



Fred Hyatt
+1 973 829 4688
fred.hyatt@am.jll.com

[333]
ROUTE 46
MOUNTAIN LAKES



Building highlights

- One of the only office buildings located in Mountain Lakes
- Recently renovated new grand entrance with grand center staircase
- Abundant parking
- Exterior monument signage available
- Common covered tailboard loading docks
- On-site ownership and property management
- On-site daycare – Bright Horizons

Location

- Conveniently located on Route 46 West bound
- Easy access to Interstate 80, the Garden State Parkway, Interstates 280, 287, Route 2 and 23
- Only 1 mile to downtown Denville – restaurants and shopping

First floor plan

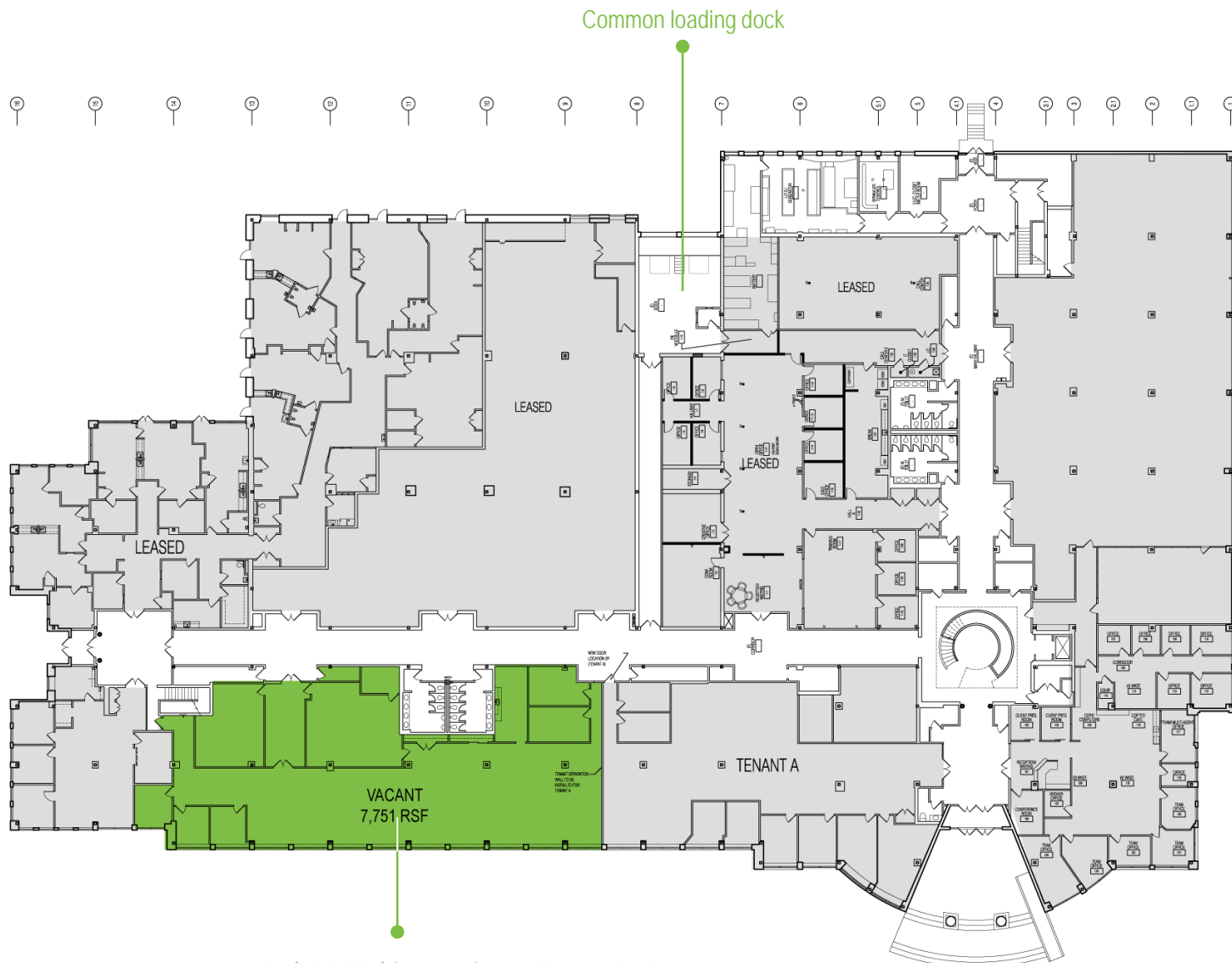

Fred Hyatt
+1 973 829 4688
fred.hyatt@am.jll.com

7,751 RSF(Divisible) | Vacant | Partially Furnished

Second floor plan



2,092 RSF | Vacant

1,720 RSF | Vacant



Fred Hyatt
+1 973 829 4688
fred.hyatt@am.jll.com

Downtown Denville amenities map

- Dining
- Arts & Entertainment
- Retail



Fred Hyatt
+1 973 829 4688
fred.hyatt@am.jll.com

[333]

ROUTE 46

MOUNTAIN LAKES

Conveniently located on Route 46 West bound

Easy access to Interstate 80, the Garden State Parkway, Interstates 280, 287, Route 2 and 23

1 mile to downtown Denville

28 miles to Newark Liberty International Airport

30 miles to Manhattan

Local and regional map

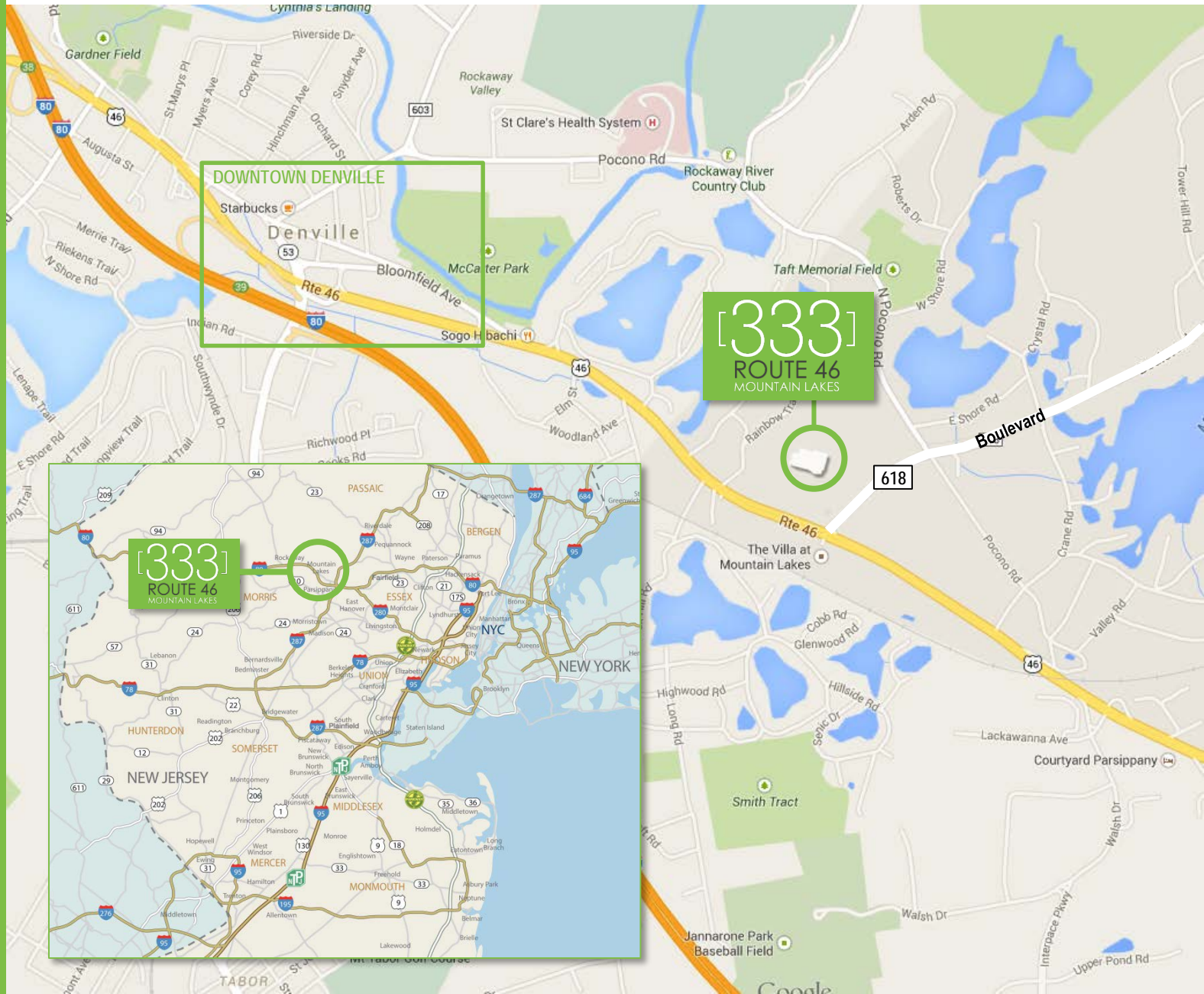

Fred Hyatt
+1 973 829 4688
fred.hyatt@am.jll.com

[333]

ROUTE 46

MOUNTAIN LAKES

CONTACT

For more information about available space



Fred Hyatt
+1 973 829 4688
fred.hyatt@am.jll.com