



860 LATOUR COURT

NAPA VALLEY COMMONS

±34,944 SF
industrial/flex building

AVAILABLE



THE DOWLING-BRACCO TEAM OF JLL

WWW.860LATOURCOURT.COM



860 LATOUR COURT

NAPA VALLEY COMMONS

property details

High identity building with signage opportunity

Ample power with 1,000 amps @ 277/480 volt

1 grade-level, 1 dock-high door

18 - 20' clear height

Two (2) back-up power generators (700 KVA and 150 KVA)

Opportunity for wine production, office, R&D, data center, industrial and/or manufacturing use



11/11/2019



Fl

Da

W

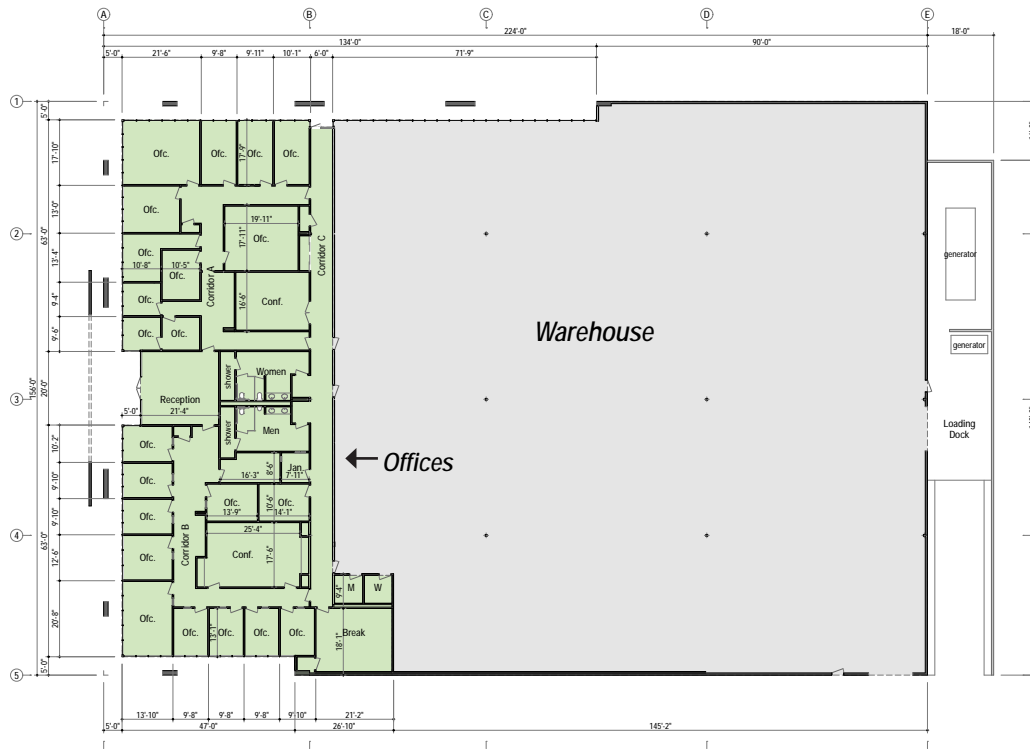

hypothetical floor plan a

±9,000 SF office

±26,000 SF warehouse



hypothetical floor plan b

±5,300 SF office
±29,700 SF warehouse

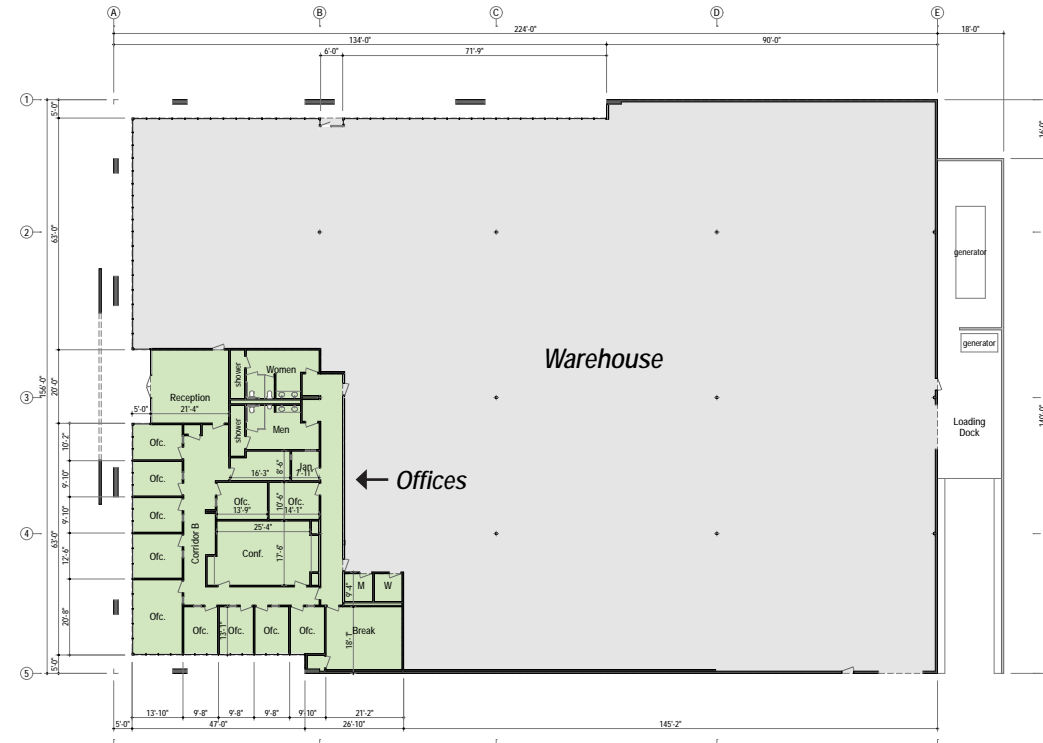

napa valley's premier business park

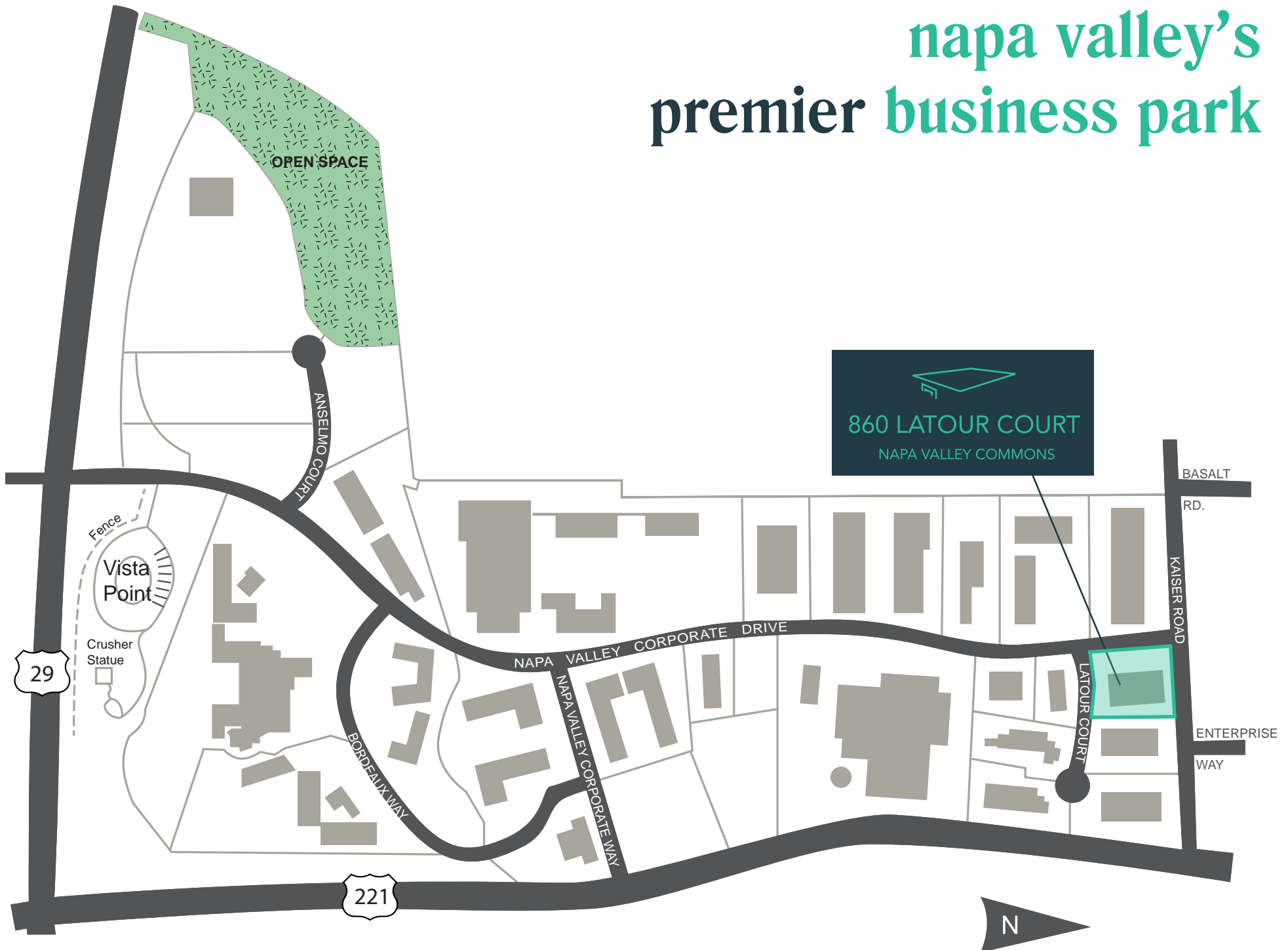

napa valley commons

Napa Valley Commons is located at the apex of the Highway 29 and 221, marking the official entrance into the Southern District of Napa Valley. Featuring 246 acres of expansive, landscaped grounds, Napa Valley Commons is home to a signature collection of companies.

Learn more at www.napavalleycommons.com



LA TAVOLA



J. LOHR
VINEYARDS & WINES



DARJOUSH





860 LATOUR COURT

NAPA VALLEY COMMONS

Tenants at Napa Valley Commons will enjoy an expansion of their onsite amenities in Summer of 2018 with the addition of Meritage Commons. Located directly across the street, Meritage Commons will feature 145 guest rooms inclusive of 39 suites, an outdoor pool area, and a food and wine village. This will complement the existing Meritage Resort by introducing new amenities that guests and Napa Valley residents can enjoy, including tasting rooms, an expansive event lawn for social gatherings and concerts, a demonstration kitchen, and boutique market.



napa access

Located approximately 2.5 miles to downtown Napa with immediate access to Highway 29, 860 Latour Court provides unparalleled amenity and transportation access.



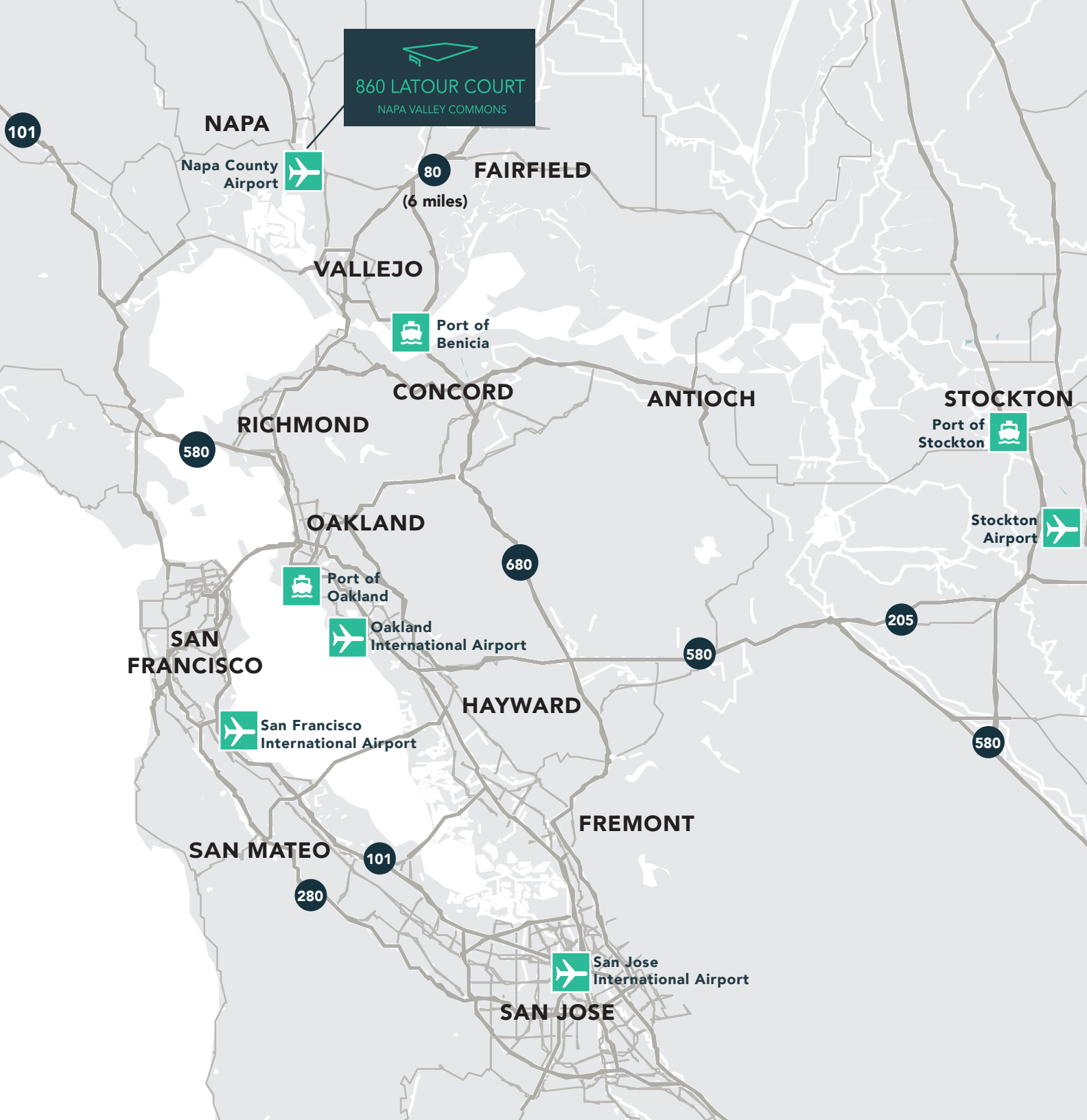

matt bracco

matt.bracco@am.jll.com

+1 925 948 1305

RE License No: 01185434

chris neeb

chris.neeb@am.jll.com

+1 707 495 7777

RE License No: 01324612

glen dowling

glen.dowling@am.jll.com

+1 707 421 2900

RE License No: 00890450



THE DOWLING-BRACCO TEAM OF JLL

www.860LATOURCOURT.com

DBREA.COM | JLL.COM

©2018 Jones Lang LaSalle IP, Inc. All rights reserved. All information contained herein is from sources deemed reliable; however, no representation or warranty is made to the accuracy thereof. Jones Lang LaSalle Brokerage, Inc. Real Estate License #: 018562