

Site No. : 1532

Site Name : SUNSET MALL

Location : PORTLAND, OR

Date : 08.24.12

Drawn By : GB

Lease Outline Drawing

NOTE: DIMENSIONS AND CONDITIONS SHOWN ARE A GRAPHIC REPRESENTATION OF THE PROPERTY. SOME EXISTING INTERIOR TENANT IMPROVEMENTS ARE NOT SHOWN. IT IS THE RESPONSIBILITY OF THE TENANT OR HIS AGENT TO FIELD VERIFY ALL DIMENSIONS AND CONDITIONS PRIOR TO DESIGN AND CONSTRUCTION OF TENANT IMPROVEMENTS. THIS DRAWING HAS BEEN ELECTRONICALLY TRANSMITTED.

±2,000 S.F.

Gross Leasable Area

ZONING

		CHECKED	NEEDS REVIEW	NOT CHECKED
MUNICIPAL	Zone			
	Use			
	Setbacks			
	Bulk			
ESMTS	Landscape			
	Utility			
	Traffic			
SITE	Leasholds			
	Traffic			
	Retention			
UTILITIES	Floodplain			
	Water			
	Gas			
	Sanitary			
	Electric			

The information presented herein is intended for use by Kimco Realty Corporation, for the purposes of schematic planning only and should not be used as a construction document. Owner, contractor and /or tenant are responsible to verify all dimensions and conditions prior to permit or construction. This information represents a preliminary interpretation of various issues as related to the site under review, and should not be considered a comprehensive report. Information may have been obtained verbally or from other sources including the internet. No testing, surveying, or on-site investigations have been performed as part of this work.

1532_LOD_13551
 _REVISED

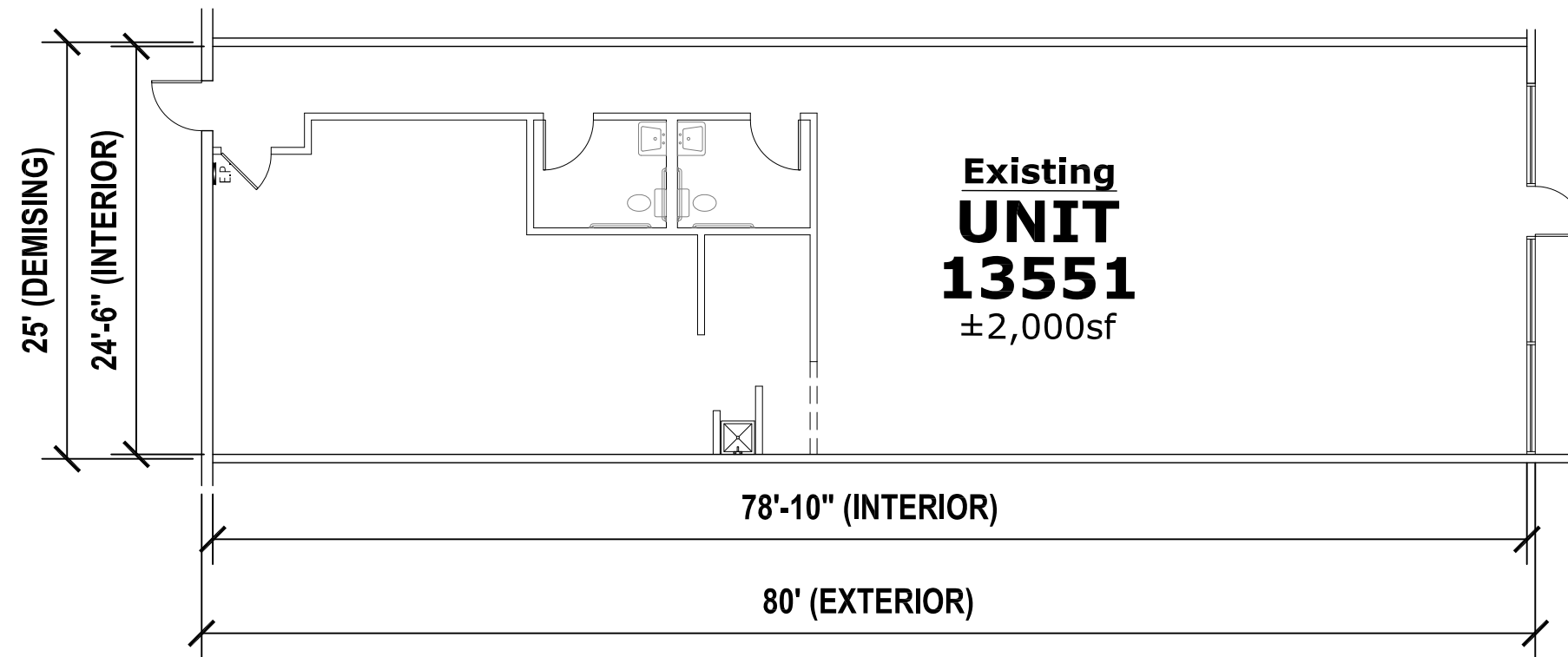

1 EXISTING DEMISING PLAN

SCALE: 1" = 10.00'

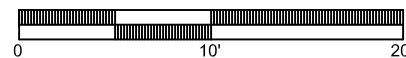

NOTES:

1.0 Extg. site plan, building areas, and parking calculations derived from 1532.dwg Flyer CAD file per KIMCO Realty.