

1.10 ± ACRE SITE AVAILABLE FOR SALE

RETAIL DEVELOPMENT SITE FOR SALE

BUILDING FEATURES	
Lot Size	1.10 ± Acres
Zoning	Retail Business District (C) Neighborhood Services (NS)

Property Highlights

- 1.10 + Acre lot with potential to expand
- Excellent retail development opportunity
- Site consists of four (4) parcels
- Frontage on Union Road and Como Park Boulevard
- Located at a signalized intersection
- Adjacent to AppleTree Business Park, a 460,000 ± SF multi-tenanted Office Park
- Just 1.3 ± miles to Walden Galleria, Super Regional Mall



For more information, contact:
MILTON M. DEBOTH
 Associate Real Estate Broker
 716.852.7500 x110 - office
mdeboth@pyramidbrokerage.com

RICHARD J. SCHECHTER
 Associate Real Estate Broker
 716.852.7500 x102 – office
rschechter@pyramidbrokerage.com

14 Lafayette Square, Suite 1900
 Buffalo, New York 14203
 phone: +1 716 852-7500

pyramidbrokerage.com

DEMOGRAPHIC	1 MILE	3 MILE	5 MILE
Population	5,425	89,263	272,461
Average Household Income	\$53,582	\$57,864	\$58,206

TRAFFIC COUNTS	
Union Road	22,388 AADT
Como Park Boulevard	5,545 AADT

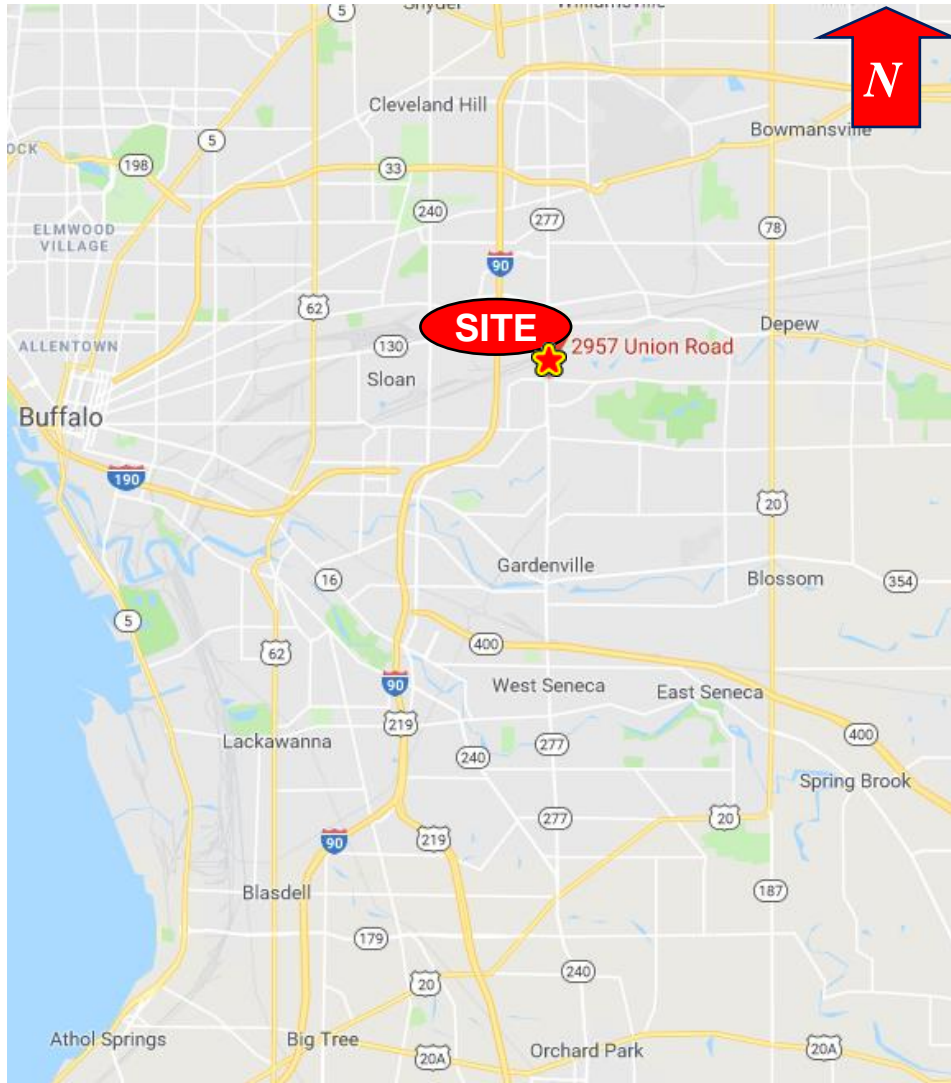

Location Map

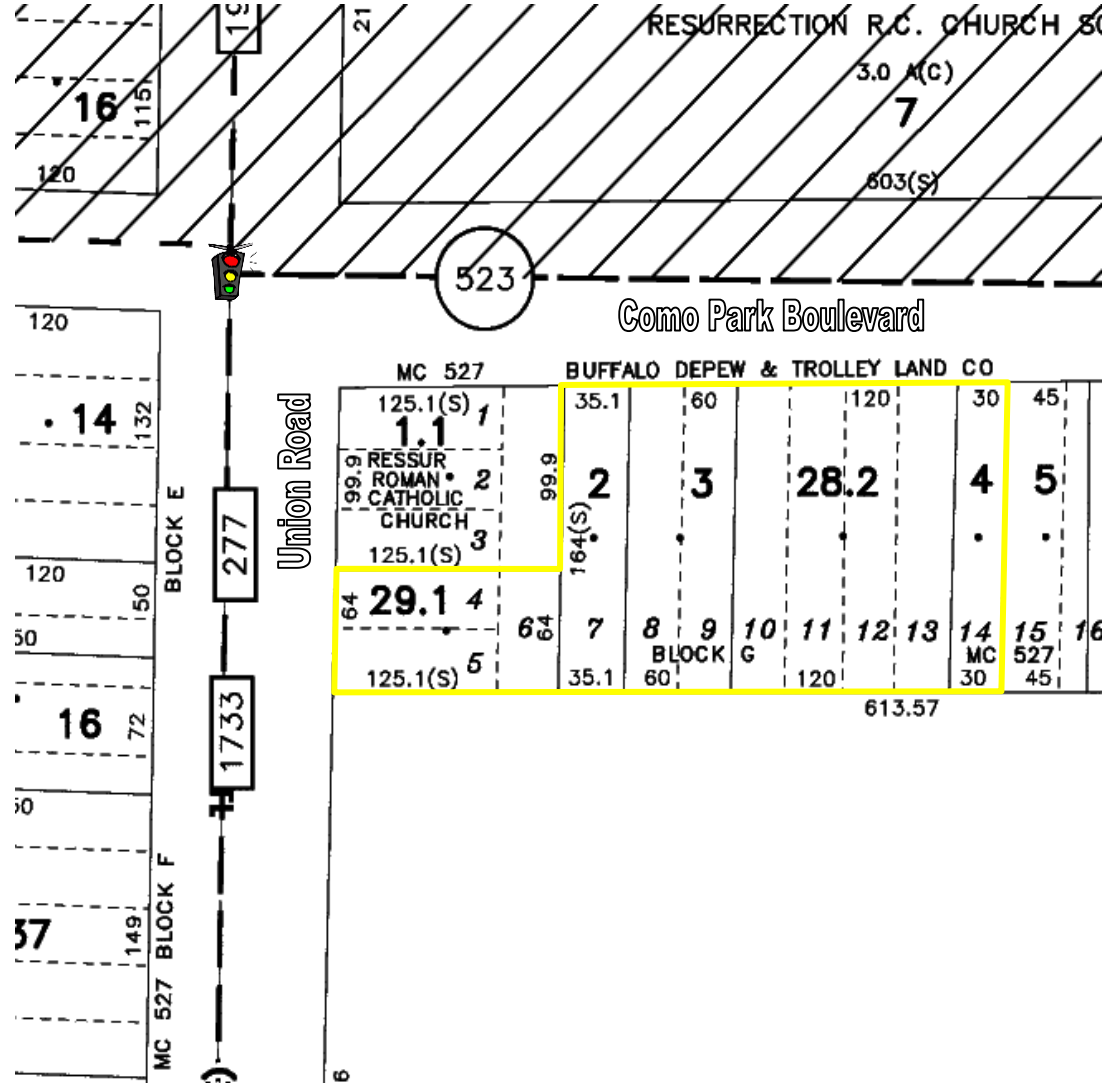

Tax Map