

# FOR LEASE

## North Seattle Office Space



**3200 NE 125th St.  
Seattle, WA 98125**

*Space Available:*

Type	Size	\$/SF/YR	Lease
Ground Floor	3,580 - 3,075	\$15.00	Mod. Gross
Basement	2,093	\$9.00	Mod. Gross
East Bldg	443	\$18.00	Mod. Gross

### PROPERTY FEATURES:

- Ground floor: 3,580 sf - 3,075 sf
- Basement : 2,093 sf
- East Bldg: 443 sf
- Consists of reception area, open work areas and private offices
- Ground floor space looks out onto central courtyard
- 48 on-site parking stalls available to tenants on a first-come-first-serve basis
- Basement includes a shower and large kitchenette
- Ideally looking for non-profit corporations



**FOR MORE INFORMATION PLEASE CONTACT:**

**Brian Mayer**

206.838.2852

[bmayer@ewingandclark.com](mailto:bmayer@ewingandclark.com)

**EWING & CLARK**  
INCORPORATED

*This information has been obtained from sources believed reliable. While we do not doubt its accuracy, we have not verified it and make no guarantee, warranty or representation about it. It is your responsibility to independently confirm its accuracy and completeness.*

2110 Western Ave., Seattle, WA 98121  
[www.EwingandClark.com](http://www.EwingandClark.com)

# FLOOR PLAN

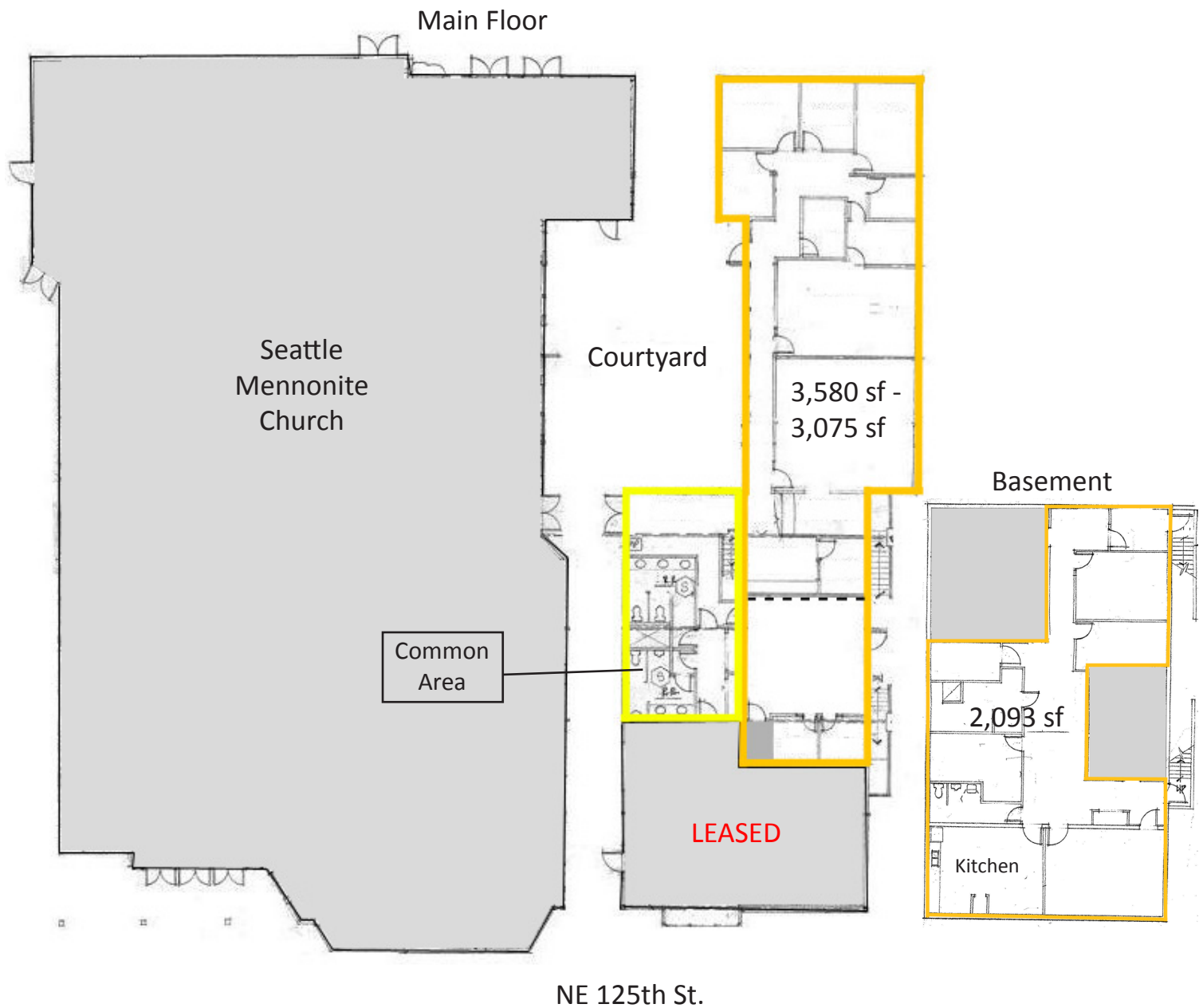



# AERIAL VIEW

