

VILLAGE MEDICAL ARTS PLAZA

341 MAGNOLIA AVENUE, SUITE 203, CORONA, CA 92879

MEDICAL OFFICE

FOR LEASE



For More Information, please contact:

EUGENE HILL

eugeneh@cbcsocalgroup.com
(951) 852-1546
CalBRE License # 01361763

BRETT LARSON, JD

brettl@cbcsocalgroup.com
(951) 532-4713
CalBRE License # 01947115



27720 JEFFERSON AVENUE, SUITE 100-B
TEMECULA, CA 92590
(951) 200-7683
www.cbcsocalgroup.com

www.cbcsocalgroup.com

Coldwell Banker Commercial and the Coldwell Banker Commercial Logo are registered service marks licensed to Coldwell Banker Commercial Affiliates. Each Office is Independently Owned and Operated. All information contained herein has been obtained from sources deemed reliable. However, no warranty or guarantee is made as to the accuracy of the information.

CalBRE License # 01998652

VILLAGE MEDICAL ARTS PLAZA

341 MAGNOLIA AVENUE, SUITE 203, CORONA, CA 92879

MEDICAL OFFICE

FOR LEASE

FEATURES

- Fully built - out \pm 3,500 SF medical office suite featuring:
 - Large Waiting Room
 - Reception Area
 - Five (5) large exam rooms
 - Nurse's station
 - Interior restroom with shower
 - Separate physician entrance
- Located in one of Corona's premier medical buildings near the intersection of Magnolia Avenue and Ontario Avenue
- Professionally managed
- Elevator - served
- Abundant parking - 5 spaces per 1,000 leasable square feet
- Diverse tenant mix within the project
- Less than 2 miles from both Corona Regional Medical Center and Corona Regional Rehabilitation Center



VILLAGE MEDICAL ARTS PLAZA



www.cbcsocalgroup.com

27720 JEFFERSON AVENUE, SUITE 100-B
TEMECULA, CA 92590
(951) 200-7683
www.cbcsocalgroup.com

For More Information, please contact:

EUGENE HILL

eugeneh@cbcsocalgroup.com
(951) 852-1546
CalBRE License # 01361763

BRETT LARSON, JD

brettl@cbcsocalgroup.com
(951) 532-4713
CalBRE License # 01947115

Coldwell Banker Commercial and the Coldwell Banker Commercial Logo are registered service marks licensed to Coldwell Banker Commercial Affiliates. Each Office is Independently Owned and Operated. All information contained herein has been obtained from sources deemed reliable. However, no warranty or guarantee is made as to the accuracy of the information.

CalBRE License # 01998652

VILLAGE MEDICAL ARTS PLAZA

341 MAGNOLIA AVENUE, SUITE 203, CORONA, CA 92879

MEDICAL OFFICE

FOR LEASE

FLOOR PLAN

SUITE	RENTABLE SQ. FT.	LEASE RATE	LEASE TYPE
203	±3,500	\$2.35 per SF/mo.	NNN*

*NNN fees estimated at \$0.79 per SF/mo. Includes electricity

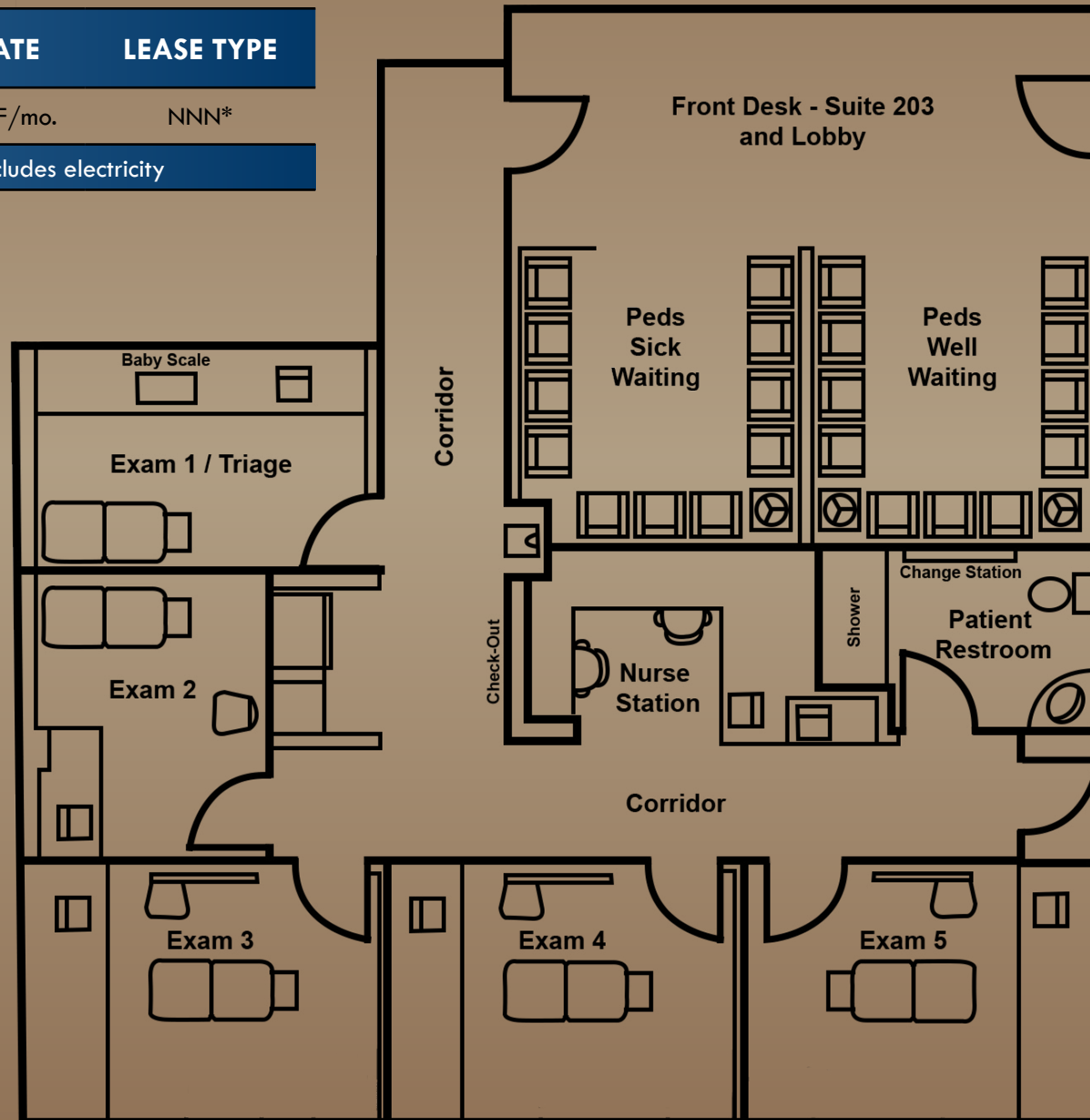

VILLAGE MEDICAL ARTS PLAZA

341 MAGNOLIA AVENUE, SUITE 203, CORONA, CA 92879

MEDICAL OFFICE

FOR LEASE

SUITE 203



VILLAGE MEDICAL ARTS PLAZA

341 MAGNOLIA AVENUE, SUITE 203, CORONA, CA 92879

MEDICAL OFFICE

FOR LEASE

AERIAL

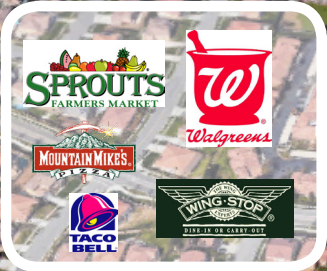

VILLAGE MEDICAL ARTS PLAZA

341 MAGNOLIA AVENUE, SUITE 203, CORONA, CA 92879

MEDICAL OFFICE
FOR LEASE

LOCATION

Village Medical Arts Plaza is located in the City of Corona, the gateway to California's Inland Empire. Located on the western edge of Riverside County, the region is accessed via Interstate 15, the 91 Freeway, and the 71 Freeway. Village Medical Arts Plaza is located along a major thoroughfare and is in close proximity to two regional hospitals.

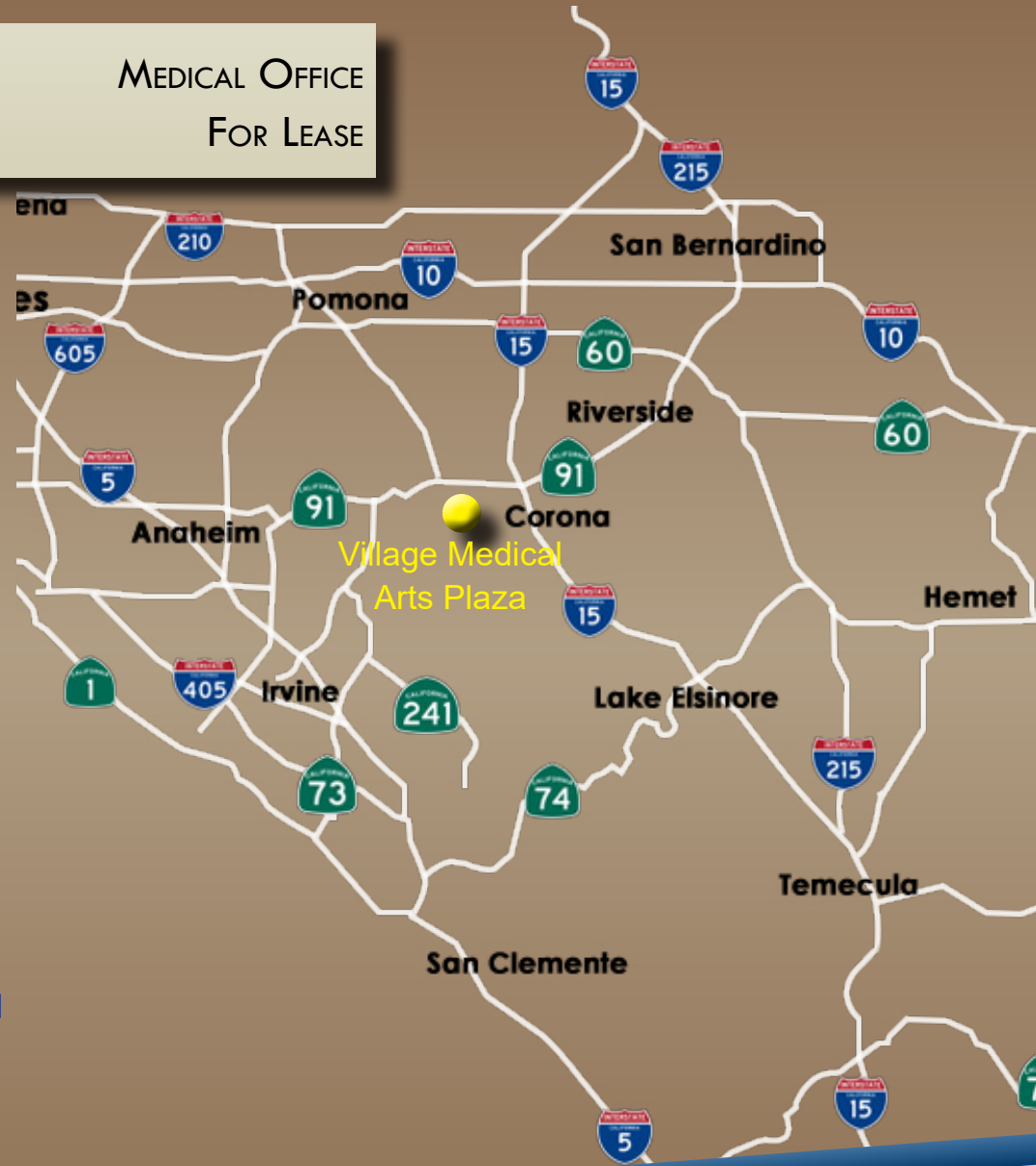
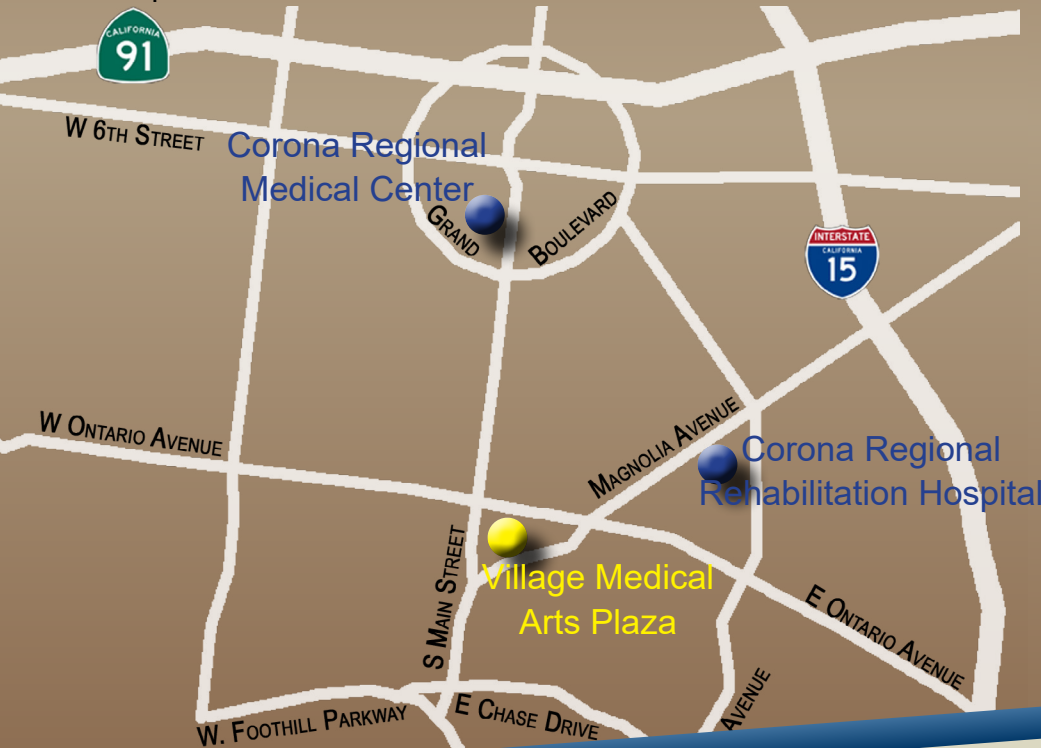

For More Information, please contact:

EUGENE HILL

eugeneh@cbcsocalgroup.com
(951) 852-1546
CalBRE License # 01361763

BRETT LARSON, JD

brettl@cbcsocalgroup.com
(951) 532-4713
CalBRE License # 01947115



27720 JEFFERSON AVENUE, SUITE 100-B
TEMECULA, CA 92590
(951) 200-7683
www.cbcsocalgroup.com

www.cbcsocalgroup.com

Coldwell Banker Commercial and the Coldwell Banker Commercial Logo are registered service marks licensed to Coldwell Banker Commercial Affiliates. Each Office is Independently Owned and Operated. All information contained herein has been obtained from sources deemed reliable. However, no warranty or guarantee is made as to the accuracy of the information.

CalBRE License # 01998652



For More Information, please contact:

EUGENE HILL

eugeneh@cbcsocalgroup.com
(951) 852-1546
CalBRE License # 01361763

BRETT LARSON, JD

brettl@cbcsocalgroup.com
(951) 532-4713
CalBRE License # 01947115



SC

27720 JEFFERSON AVENUE, SUITE 100-B
TEMECULA, CA 92590
(951) 200-7683
www.cbcsocalgroup.com

www.cbcsocalgroup.com

Coldwell Banker Commercial and the Coldwell Banker Commercial Logo are registered service marks licensed to Coldwell Banker Commercial Affiliates. Each Office is Independently Owned and Operated. All information contained herein has been obtained from sources deemed reliable. However, no warranty or guarantee is made as to the accuracy of the information.

CalBRE License # 01998652