

2711 FAIRVIEW

2711 FAIRVIEW AVENUE | ROSEVILLE, MN



FOR LEASE



AVAILABLE SPACE:

3,985 SF

LEASE RATE:

\$18.00 PSF GROSS
+ UTILITIES

TERM:

FLEXIBLE

PROPERTY HIGHLIGHTS

- Cost effective move-in ready space
- Highly flexible lease terms
- Easy access to 35W & Snelling Avenue
- Close proximity to Rosedale Center and Rosedale Commons Shopping Center
- Ample parking



2711 FAIRVIEW AVENUE

ROSEVILLE, MINNESOTA

FLOOR PLAN - 3,985 SF

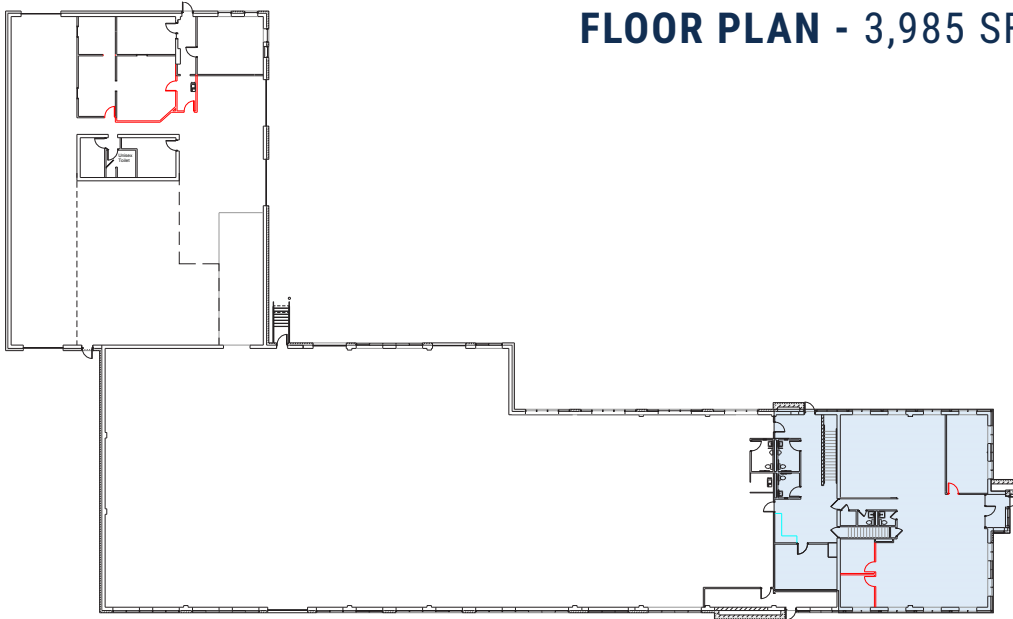

STEVE SHEPHERD S10R
Managing Director

T +1 612 430 9973
steve.shepherd@ngkf.com

JAY CHMIELESKI
Managing Director

T +1 612 430 9982
jay.chmielecki@ngkf.com

www.ngkf.com

The information contained herein has been obtained from sources deemed reliable but has not been verified and no guarantee, warranty or representation, either express or implied, is made with respect to such information. Terms of sale or lease and availability are subject to change or withdrawal without notice.

