

# Alafaya Corporate Center – East Market

3,852 RSF Available



## Property Highlights

- 2100 North Alafaya Trail
- 3,852 Rentable Square Feet Available
- Direct Alafaya Trail Building and Monument Signage
- Adjacent to the Central Florida Research Park and University of Central Florida
- Close Proximity to SR 408 and SR 417
- No After Hours Air Charges
- 100% Office Space with 1+% Common Area Factor

For Information Contact:

Mike Fess, Faith Pamplin, or Emily Bower

1300 N. Semoran Blvd. Suite 225, Orlando, FL 32807

Office: 407.660.4949 | Fax: 407.660.4995

[mikefess@equitypartners.net](mailto:mikefess@equitypartners.net), [faithpamplin@equitypartners.net](mailto:faithpamplin@equitypartners.net),

[emilybower@equitypartners.net](mailto:emilybower@equitypartners.net)

# Alafaya Corporate Center – East Market

3,852 RSF Available

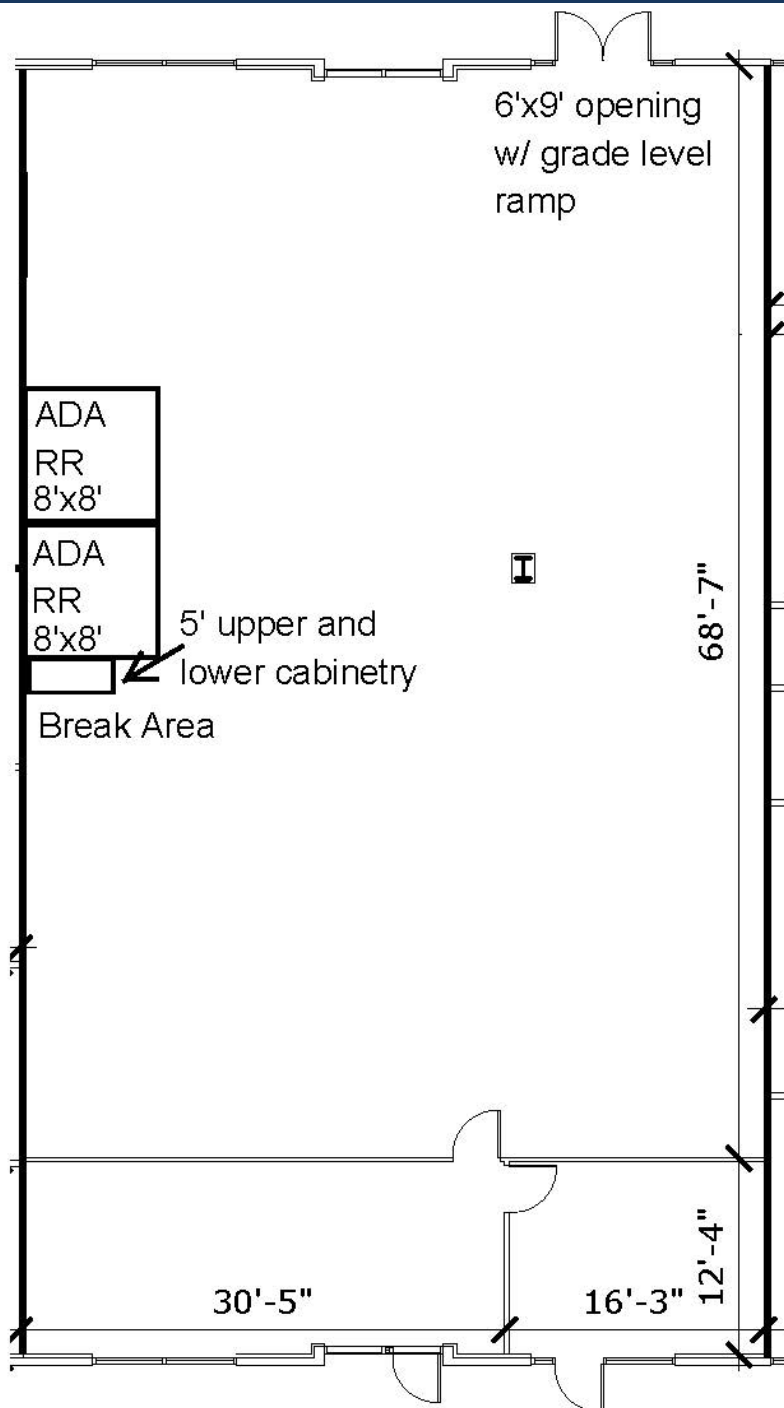

For Information Contact:

Mike Fess, Faith Pamplin, or Emily Bower

1300 N. Semoran Blvd. Suite 225, Orlando, FL 32807

Office: 407.660.4949 | Fax: 407.660.4995

[mikefess@equitypartners.net](mailto:mikefess@equitypartners.net), [faithpamplin@equitypartners.net](mailto:faithpamplin@equitypartners.net),

[emilybower@equitypartners.net](mailto:emilybower@equitypartners.net)