



## Industrial For Sale

**Property Name:**

**Location:** 2427 E. Judd Road

**City, State:** Burton, MI

**Cross Streets:** Quinlin Dr.

**County:** Genesee

**Zoning:** M-1

### BUILDING SIZE / AVAILABILITY

<b>Building Type:</b>	Built	<b>Mezzanine:</b>	N/A
<b>Total Building Sq. Ft.:</b>	13,020	<b>Available Shop Sq. Ft.:</b>	11,340
<b>Available Sq. Ft.:</b>	13,020	<b>Available Office Sq. Ft.:</b>	1,680
		<b>Office Dim:</b>	N/A
		<b>Shop Dim:</b>	N/A

### PROPERTY INFORMATION

<b>Freestanding:</b>	Yes	<b>Year Built:</b>	1964 (Retrofit: 1975)
<b>Clear Height:</b>	9' - 14'	<b>Rail:</b>	No
<b>Grade Level Door(s):</b>	2: 12 x 14	<b>Security:</b>	No
<b>Truckwells or Docks:</b>	0	<b>Interior:</b>	N/A
<b>Exterior Construction:</b>	Insulated Siding	<b>Lighting:</b>	Fluorescent
<b>Structural System:</b>	Steel	<b>Bay Sizes:</b>	N/A
<b>Air-Conditioning:</b>	Office	<b>Restrooms:</b>	3
<b>Heating:</b>	Gas	<b>Cranes:</b>	No
<b>Availability:</b>	Immediately	<b>Parking:</b>	Ample
<b>Power (Amps/Volts):</b>	N/A	<b>Roof:</b>	Gable
		<b>Floors:</b>	N/A
		<b>Floor Drains:</b>	No
		<b>Acreage:</b>	1.150
		<b>Land Dimensions:</b>	N/A

### PRICING INFORMATION

<b>Sale Price:</b>	\$625,000 (\$48.00/sqft)	<b>Deposit:</b>	N/A	<b>TD:</b>	N/A
<b>Taxes:</b>	\$8,898.77 (2020)	<b>Options:</b>	N/A	<b>Assessor #:</b>	N/A
<b>Parcel #:</b>	59-32-527-004				

### COMMENTS

Fenced lot.

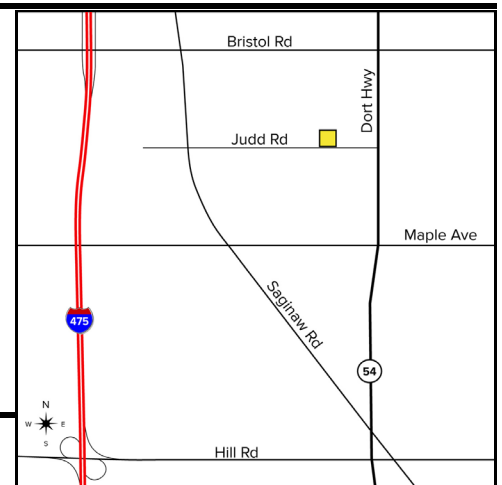

**Broker:** SIGNATURE ASSOCIATES

**Agent(s):**

Chris Monsour, (248) 948-0107, cmonsour@signatureassociates.com

Joe Stack, (248) 359-0615, jstack@signatureassociates.com