

RETAIL SPACE FOR LEASE

GREENTREE PLAZA

3,044 SF – 11,600 SF

1153 S. Milwaukee Ave.

Libertyville, Illinois

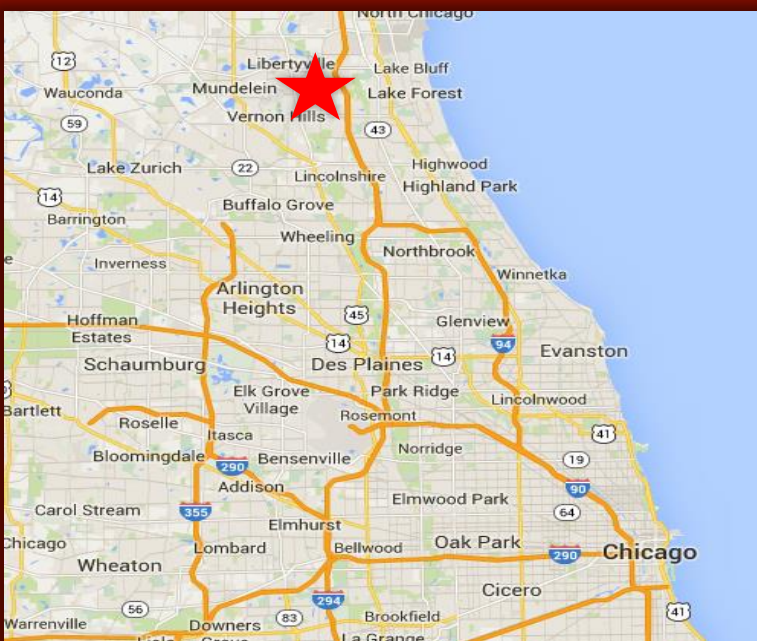

- 108,000 sf center on Milwaukee Ave.
- Great access, visibility and parking with 33,500 VPD along Milwaukee Ave.
- Available spaces: 3,044 sf, 4,350sf, and 11,600 sf
- Join Xsport Fitness, Xgolf, Bakers Square, O'Reilly's Furniture, Pho House, 4 Paws Animal Hospital and Coldwell Banker.
- Located in Libertyville's "motor row" and primary shopping corridor
- Population: 1-mile 8,884 3-mile 58,392
- Strong demos: 1-mile HHI is \$122,724

GreenTree Plaza, Libertyville, Illinois

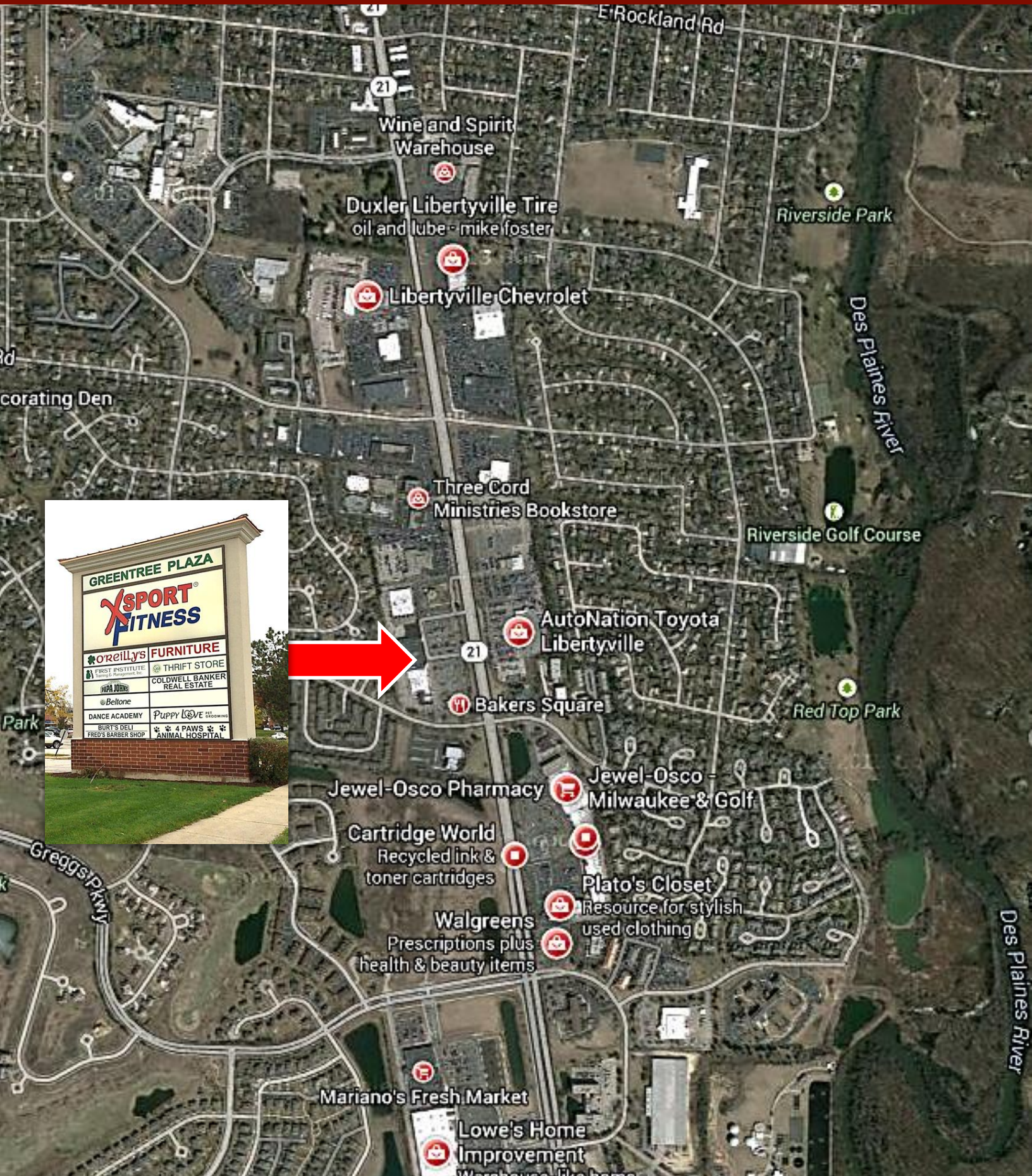

GreenTree Plaza, Libertyville, Illinois

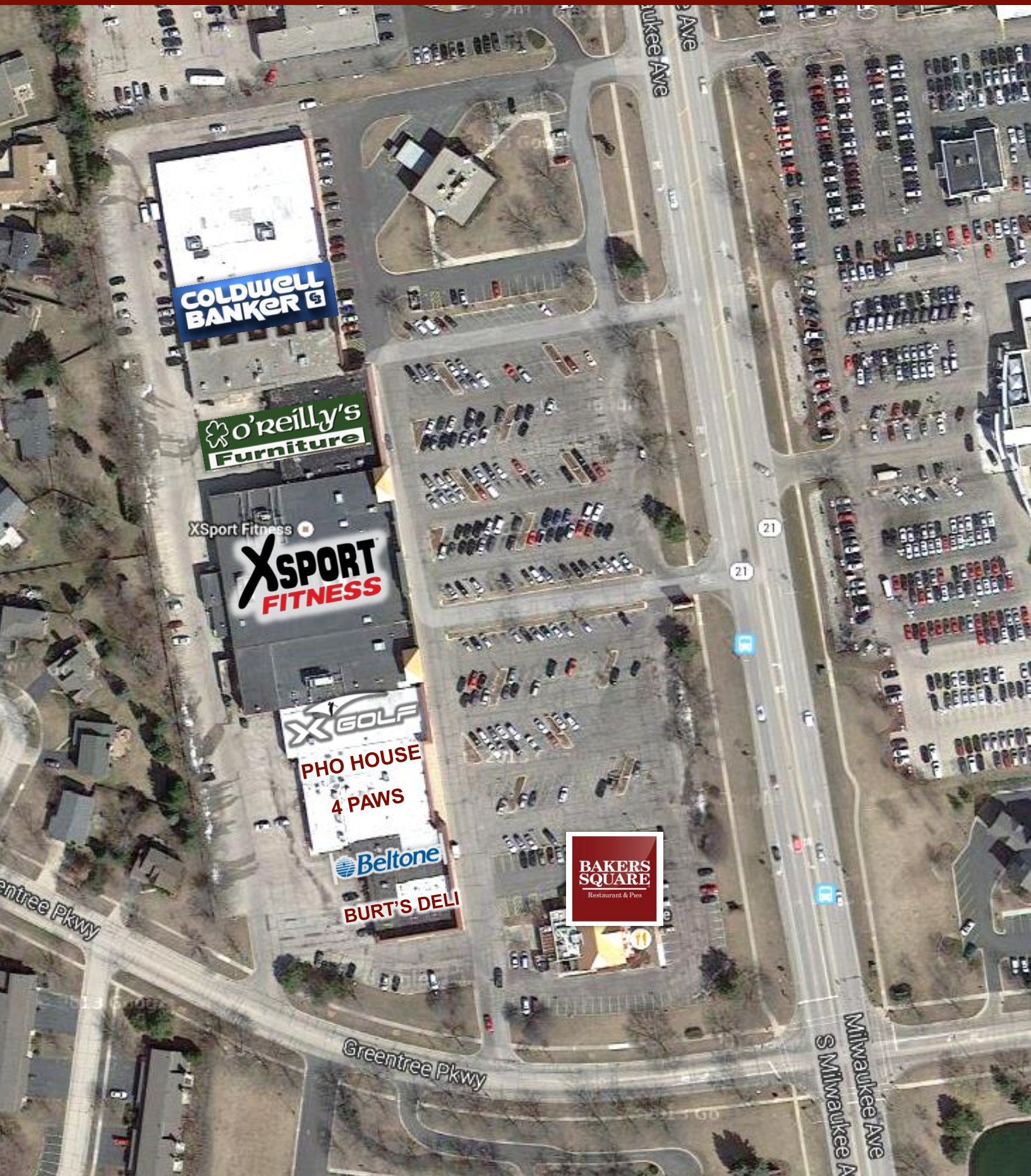



GreenTree Plaza, Libertyville, Illinois

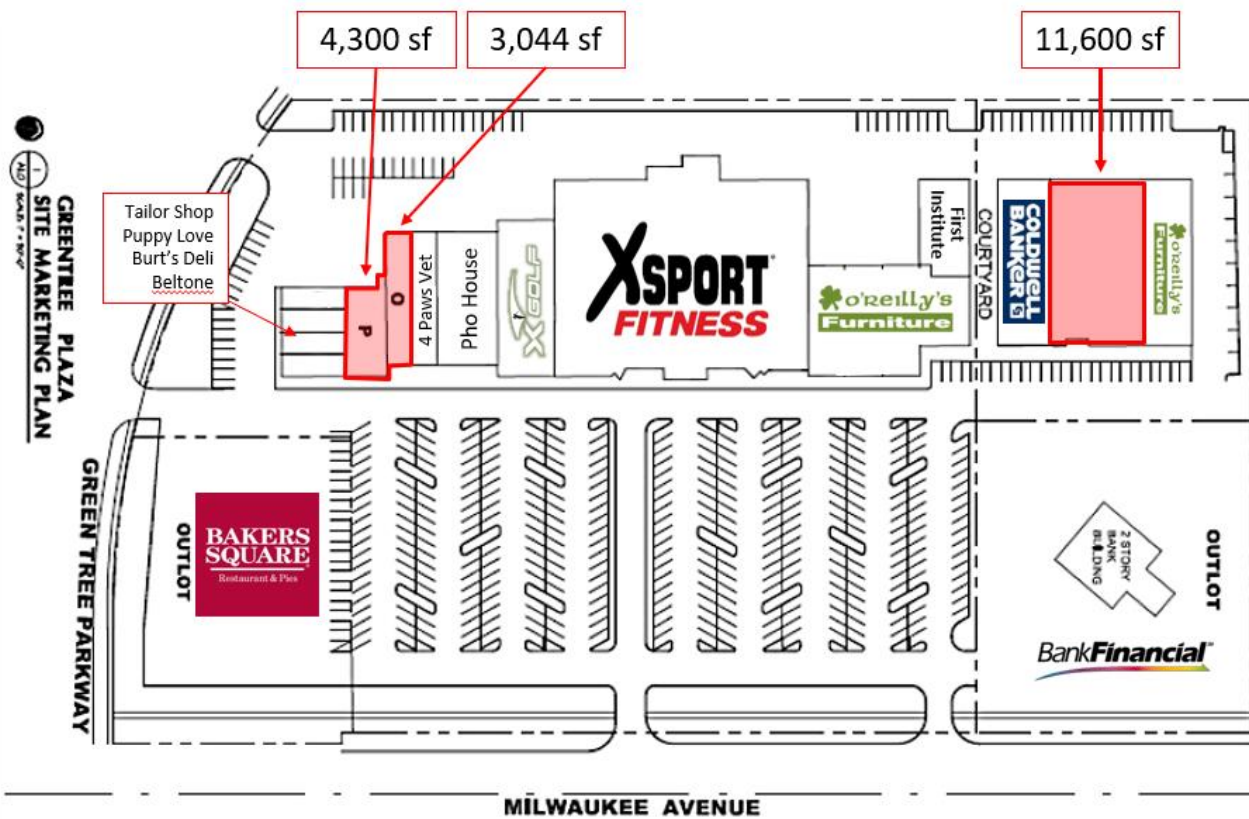



GreenTree Plaza, Libertyville, Illinois

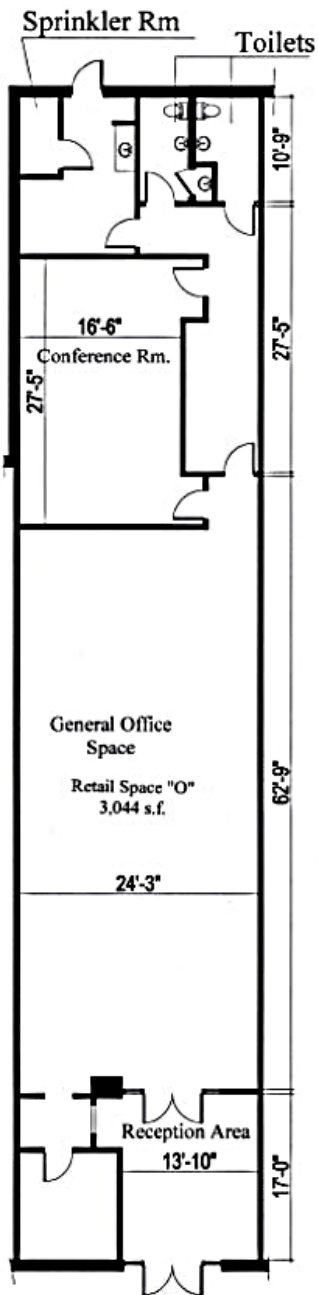

AVAILABLE: 3,044 SF

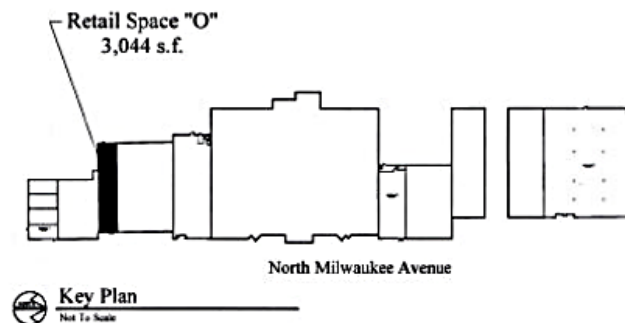



GreenTree Plaza, Libertyville, Illinois

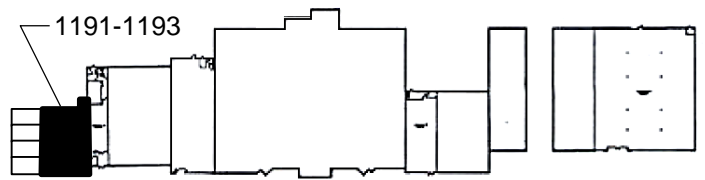
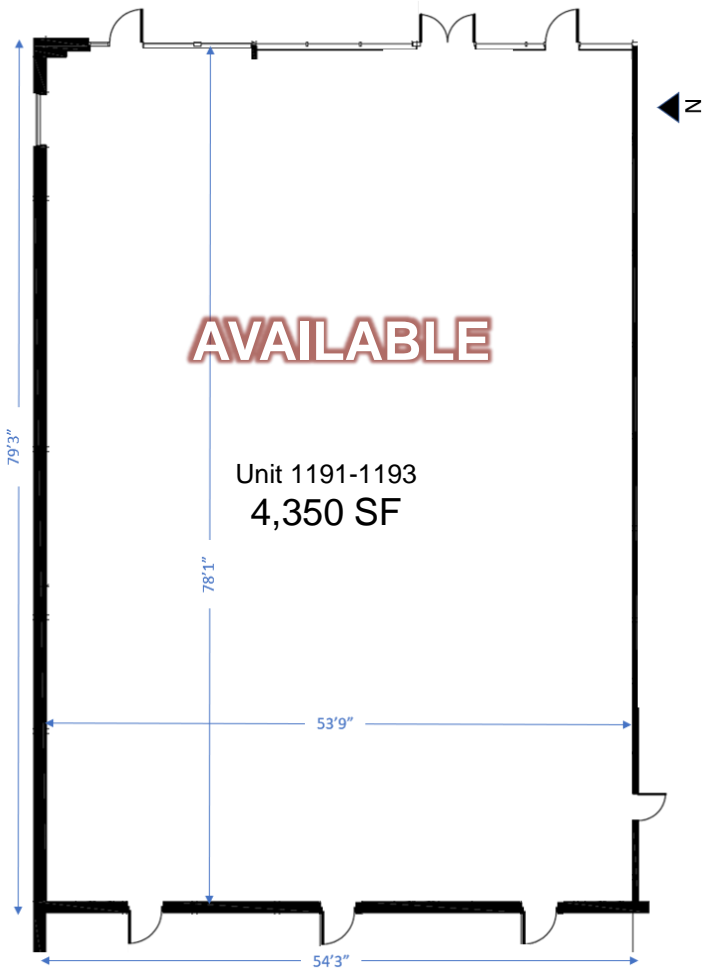

North Milwaukee Avenue

Key Plan
Not To Scale



GreenTree Plaza, Libertyville, Illinois

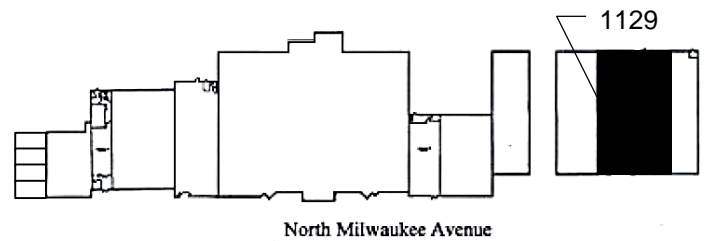
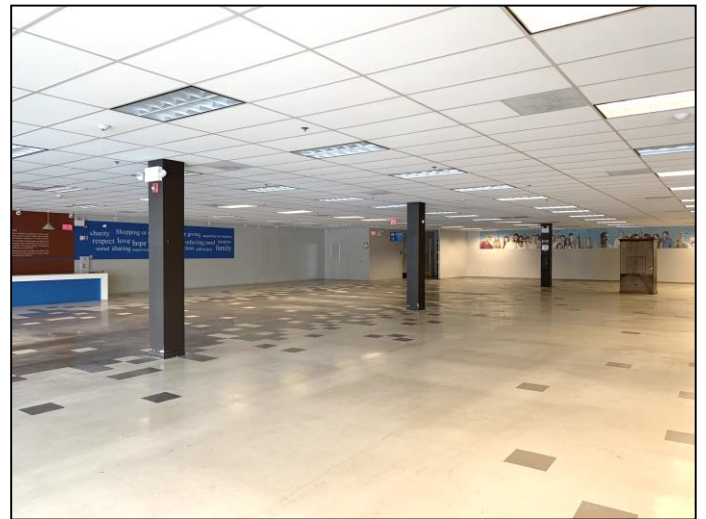
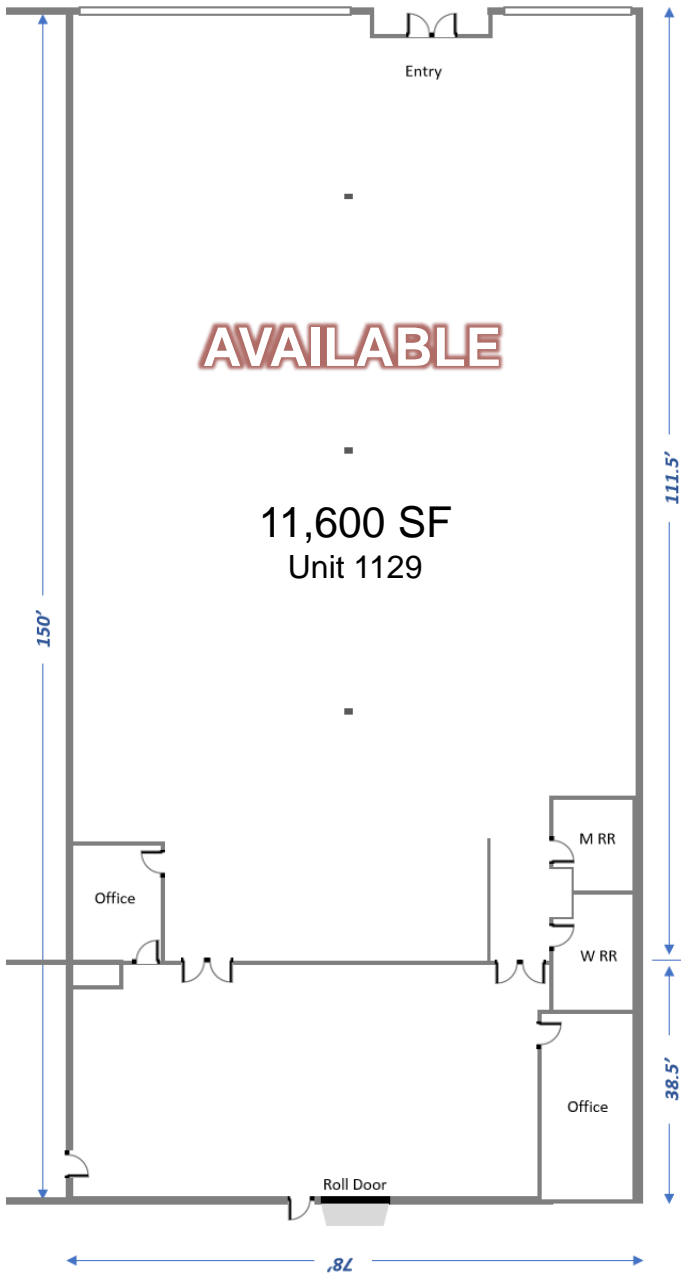

Key Plan
Not To Scale