

BRAND NEW CONSTRUCTION

950 West Baptist Road, Monument, CO 80132



SPACE FOR LEASE JACKSON CREEK MARKET VILLAGE

- 1,994 SF space is available and would be perfect for a future restaurant or medical office
- Situated on West Baptist Road just past the light at Jackson Creek Parkway with ample parking and gorgeous mountain views
- Property is located adjacent to King Soopers anchored shopping center

PROPERTY DETAILS

NNN Estimate	\$8.69/PSF
Lease Rate	\$30.00-\$32.00/PSF
Building Size	4,991 SF
Space Available	1,994 SF

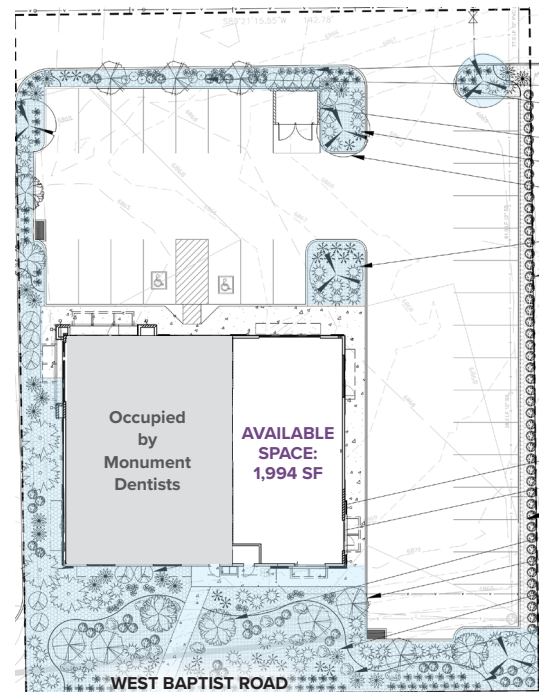



PLEASE CONTACT:

Dan Rodriguez

Vice President

+1 719 471 6046

dan.rodriguez@cbre.com

© 2020 CBRE, Inc. All rights reserved. This information has been obtained from sources believed reliable, but has not been verified for accuracy or completeness. You should conduct a careful, independent investigation of the property and verify all information. Any reliance on this information is solely at your own risk. CBRE and the CBRE logo are service marks of CBRE, Inc. All other marks displayed on this document are the property of their respective owners, and the use of such logos does not imply any affiliation with or endorsement of CBRE. Photos herein are the property of their respective owners. Use of these images without the express written consent of the owner is prohibited.

2020 ESTIMATED DEMOGRAPHICS

	1 MILE	3 MILE	5 MILE
Population	7,826	29,045	58,791
Households	2,447	9,780	18,505
Average Household Income	\$156,218	\$150,494	\$153,285

2020 TRAFFIC COUNTS

West Baptist Road at Jackson Creek Parkway	10,595 vpd
East Baptist Road at West Baptist Road	9,373 vpd