

2111 west walnut hill

IRVING, TEXAS • 75038

YOUR LOGO HERE

±81,089 SF FLEX BUILDING | FOR SALE OR LEASE

 TRANSWESTERN®

BUILDING FACTS

Building Size:	± 81,089 SF Total ± 38,557 SF (Air-conditioned Office/Production area) ± 42,532 SF (Warehouse)
Acreage:	± 5.684 Acres (247,593 SF)
Year Built:	1979
Clear Height:	20'
Zoning:	PUD 4024
Parking:	230 surface spaces (2.84/1000)
Loading Doors:	7 Dock Doors
Secured Truck Court:	145' depth
Roof:	TPO single-ply membrane over 2" rigid insulation and ½" HD cover board, R-30 minimum (2019). 20 year NDL (no dollar limit) certified warranty, 2 year labor warranty
Electricity:	1,140 amp; 277/480 volt; 3 phase 4 wire service
Sale Price:	\$75.00/SF (+/- \$6,081,675) (subject to change without prior notice)
Lease Price:	\$6.50 NNN (+/- \$1.35 estimated OPEX + E + J)

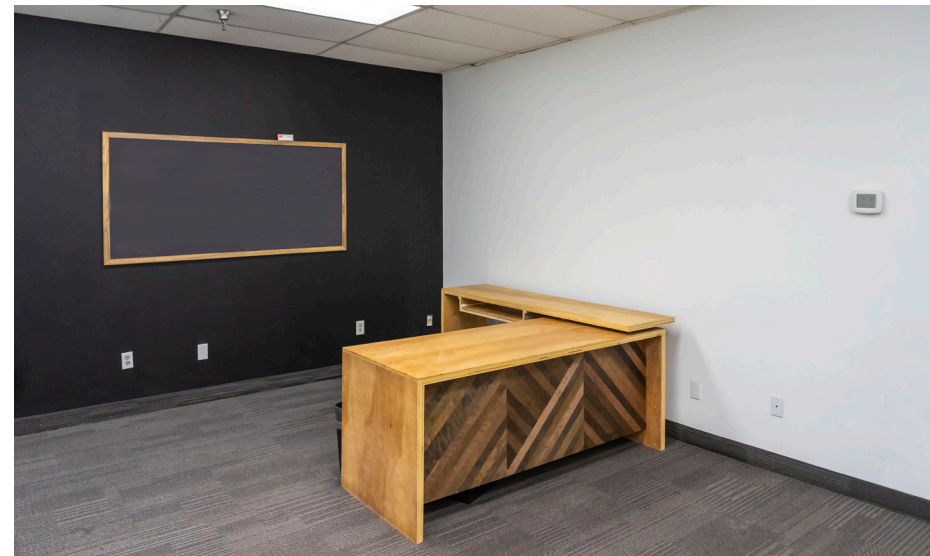

FLOOR PLAN

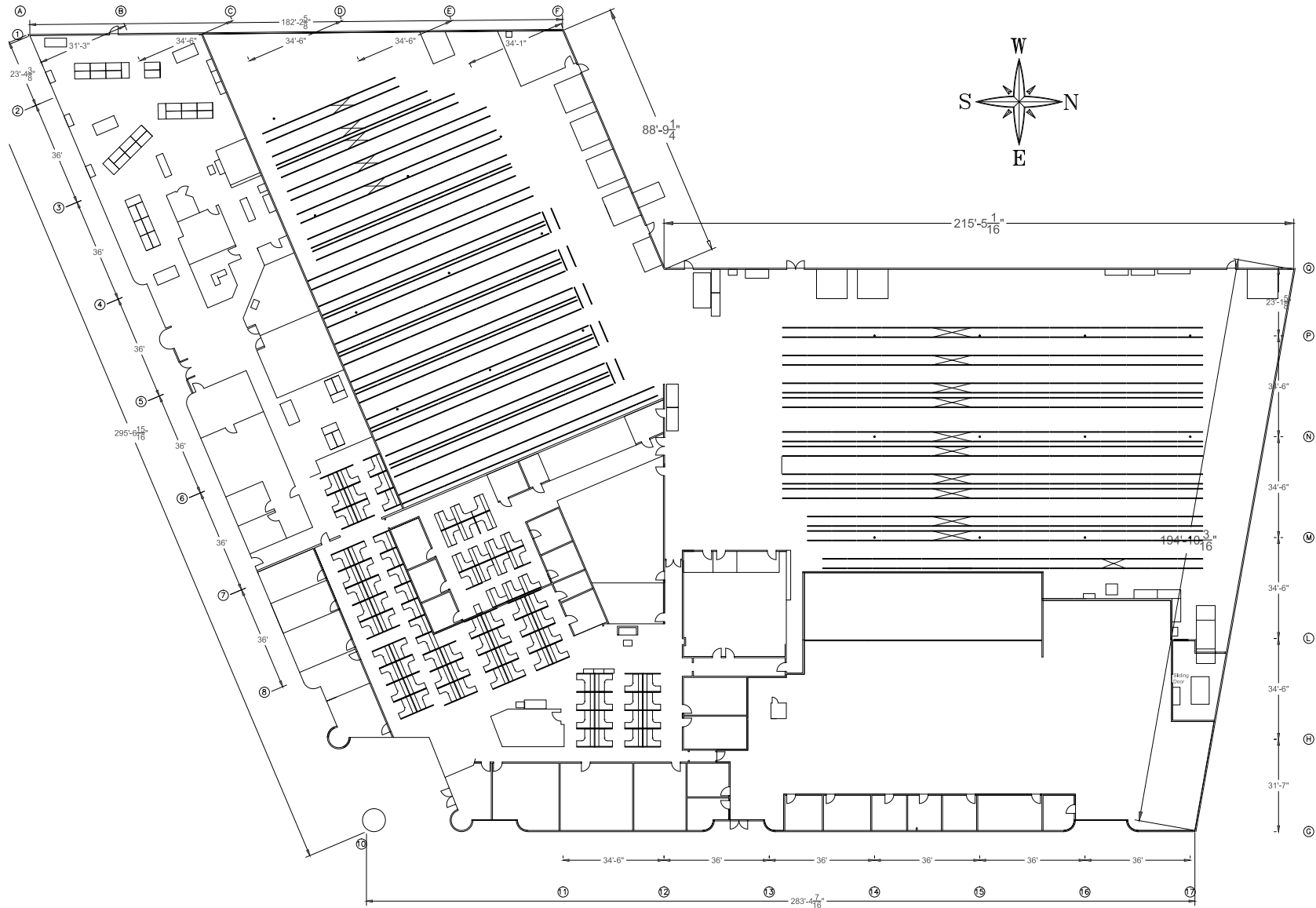

SITE PLAN AND LOCATION

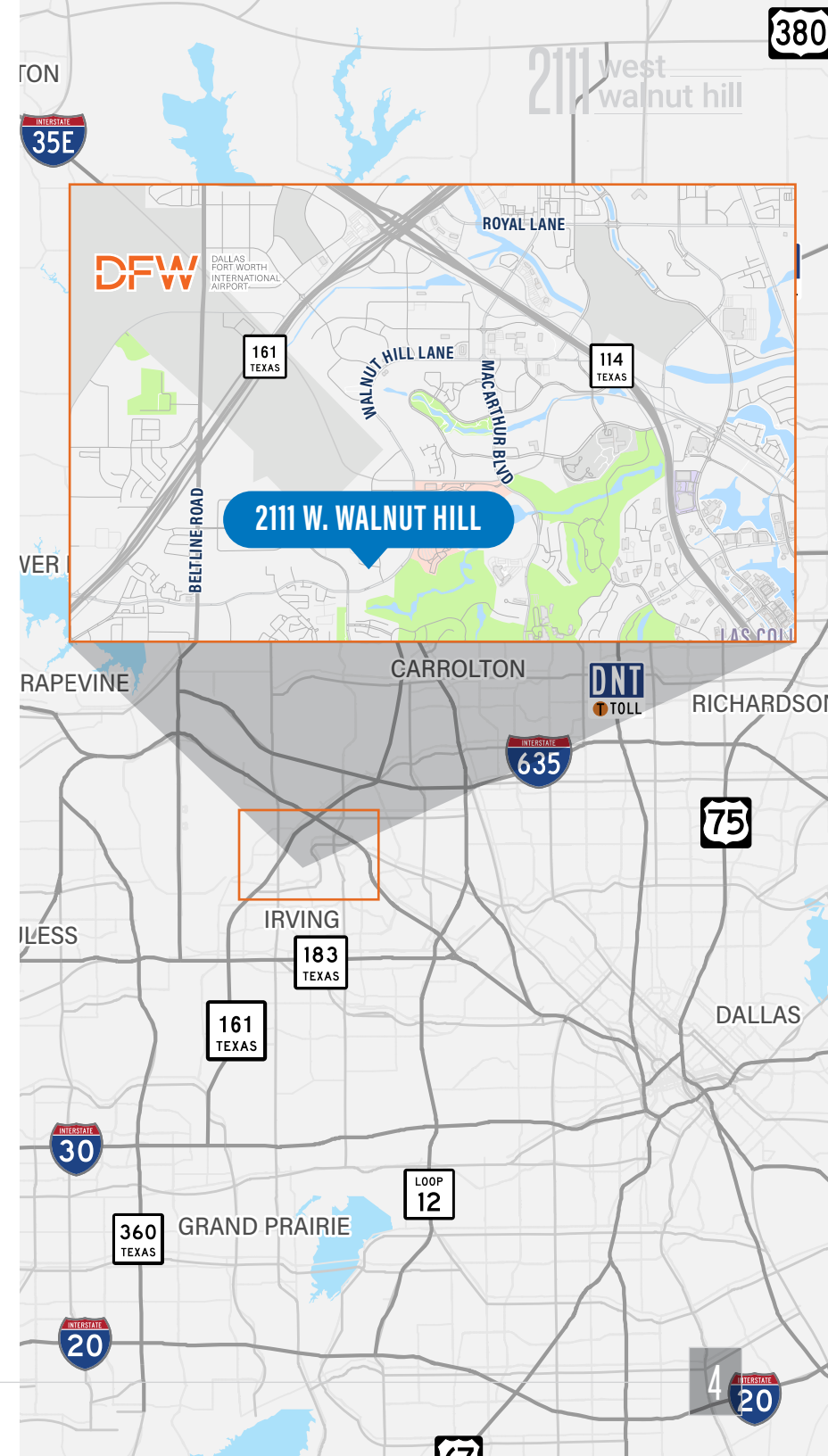

2111 west walnut hill

±81,089 SF FLEX BUILDING | FOR SALE OR LEASE

FOR ADDITIONAL INFORMATION

JORDAN WADE

Vice President

214.446.4531

jordan.wade@transwestern.com

NORA HOGAN, CCIM, SIOR

Principal

214.446.4509

nora.hogan@transwestern.com

CLAYTON JOHNSON

Associate

214.292.6426

clayton.johnson@transwestern.com

JOHN FULTON, SIOR

Principal

972.774.2518

john.fulton@transwestern.com



The information provided herein was obtained from sources believed reliable; however, Transwestern makes no guarantees, warranties, or representations as to the completeness or accuracy thereof. The presentation of this property is submitted subject to errors, omissions, change of price or conditions, prior sale or lease, or withdrawal without notice. Copyright © 2019 Transwestern.