



Well Maintained / Locally Owned

FOR LEASE
OFFICE SPACE
IMMEDIATELY AVAILABLE
Spirit Investments
816-898-9565



Office Intensive Layout

Spacious Conference Room



Well Lit Office Suites

Includes Full Kitchen



Inner Offices Include Lots of Glass

Call 816-898-9565 for More Info - 6300 Equitable Rd., Kansas City, MO 64120

Office Space For Lease

4500 Sq Ft

Now Available

6300 Equitable Rd.
Kansas City, MO
64120

Spirit
Investments
LLC

816-898-9565

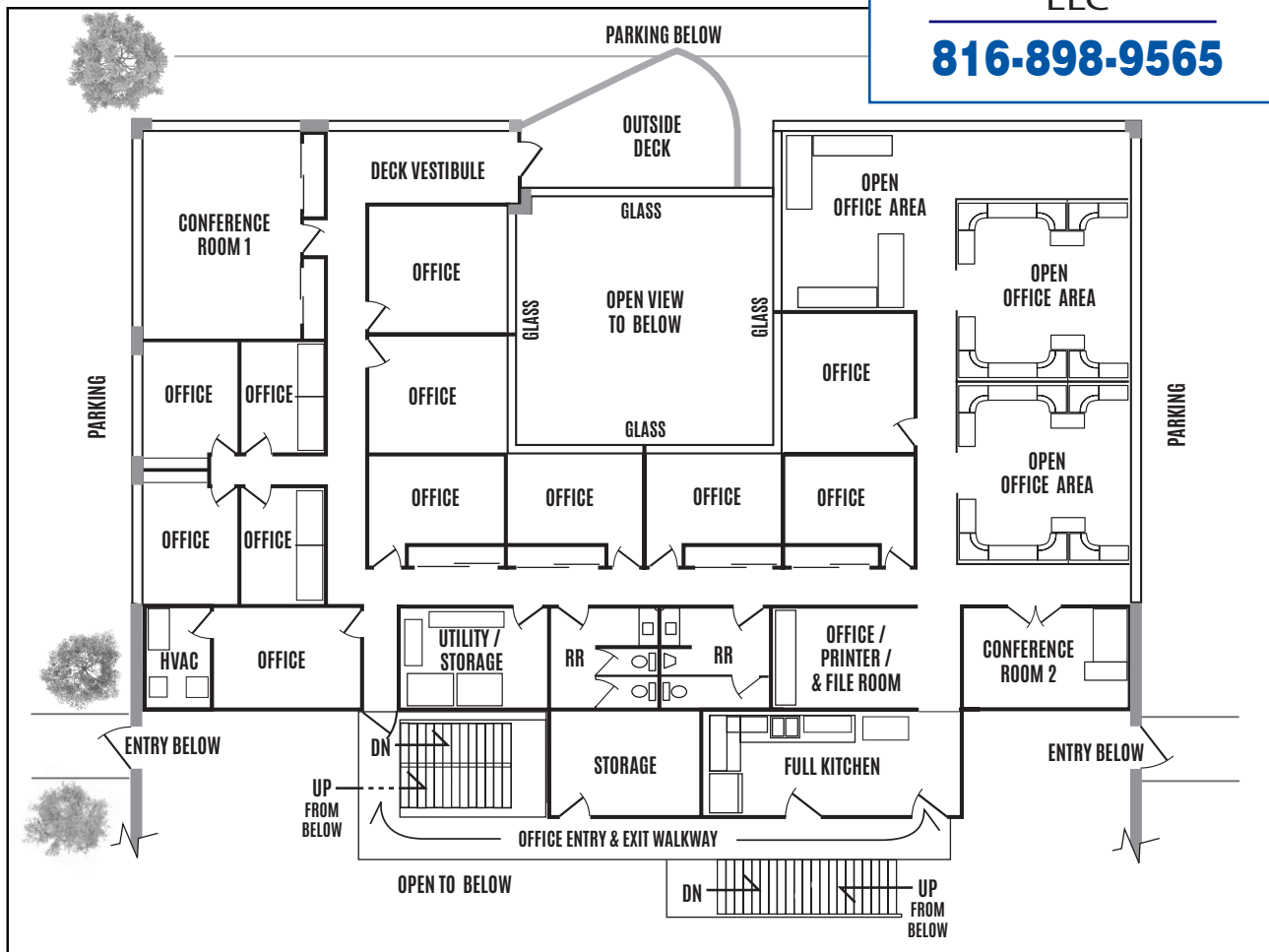

Features

- Construction: Reinforced concrete
- Office intensive layout
- Well lit, glass walled and open floor-plan office area
- 35+ Parking spaces available
- Great access to I-435
- 9 minutes to downtown KCMO
- 30 minutes to KCI Airport
- Affordable lease rate.
12 to 24 mo. lease terms considered.

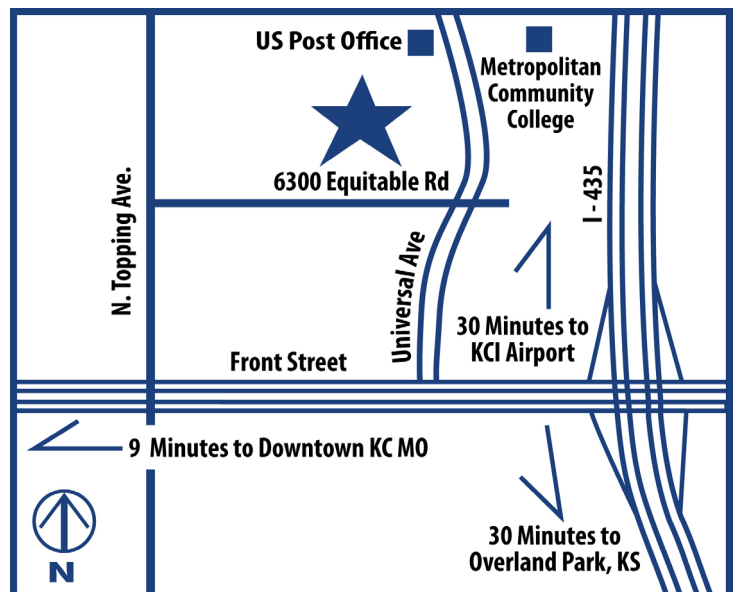

Call 816-898-9565 for More Info - 6300 Equitable Rd., Kansas City, MO 64120