

FOR LEASE > INDUSTRIAL SPACE

8,295 SF to 12,720 SF Industrial



26820 HOBIE CIRCLE, SUITES A / A-2, MURRIETA, CA 92562



Property Features:

- > Approximately 4,400 SF of HVAC office/flex space
- > Four (4) grade-level loading doors
- > 600 amps, 120/208 volt, 3 phase power
- > 18' minimum clearance
- > Drive around truck access
- > Metal halide lighting throughout warehouse
- > MU-2 (Multiple Use) zoning
- > Suites A & A-2 Can Be Leased Separately
- > **LEASE RATE: \$0.59/SF Modified Gross**

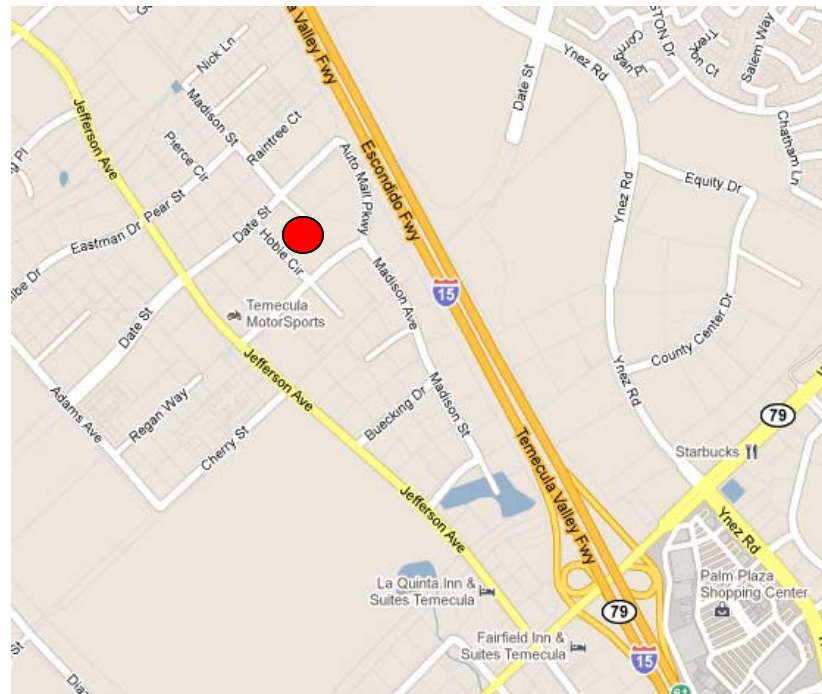

MIKE PAPPAS
951 695 3770
mike.pappas@colliers.com
Lic# 00981543

COLLIERS INTERNATIONAL
5901 Priestly Drive, Suite 100
Carlsbad, CA 92008
www.colliers.com/temecula

26820 Hobie Circle, Suites A / A-2 > Site Plan

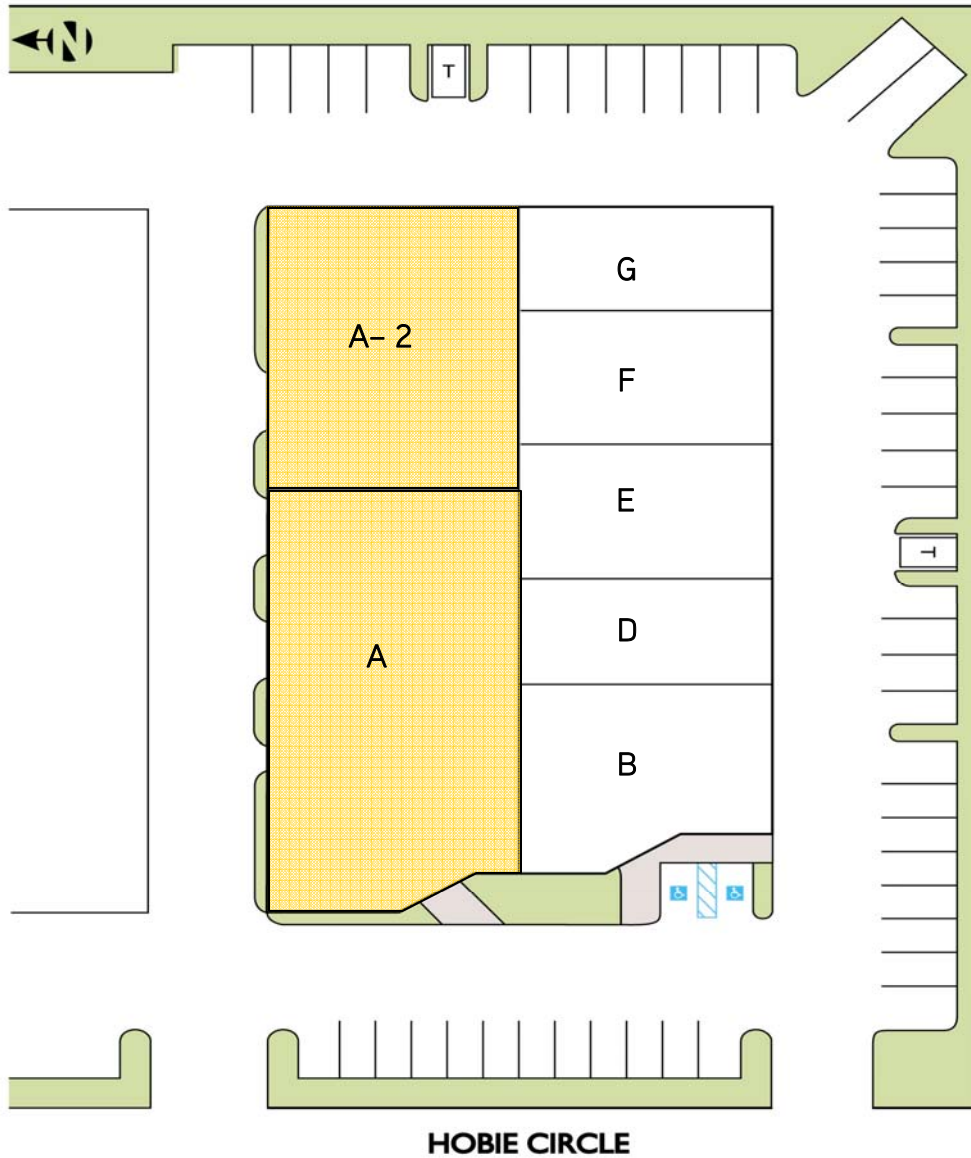

Contact Us

MIKE PAPPAS
951 695 3770
mike.pappas@colliers.com
Lic# 00981543

COLLIERS INTERNATIONAL
5901 Priestly Drive, Suite 100
Carlsbad, CA 92008
www.colliers.com/temecula

This document has been prepared by Colliers International for advertising and general information only. Colliers International makes no guarantees, representations or warranties of any kind, expressed or implied, regarding the information including, but not limited to, warranties of content, accuracy and reliability. Any interested party should undertake their own inquiries as to the accuracy of the information. Colliers International excludes unequivocally all inferred or implied terms, conditions and warranties arising out of this document and excludes all liability for loss and damages arising there from. Colliers International is a worldwide affiliation of independently owned and operated companies.

