

# SETON BUSINESS PARK

5601 Metro Drive, Baltimore, MD 21215  
Baltimore City



## FOR LEASE

### NEARBY RETAILERS:



- ±14,000 SF of office space
- Premier entrance to Seton Business Park
- Convenient to Rogers Station Metro Stop
- Public transportation (MTA) to the building
- Free and abundant surface parking
- ±31,000 cars/day on Northern Parkway
- Hub Zone qualified

Jesse Schwartzman  
jschwartzman@klnb.com  
443-632-2067

100 West Road, Suite 505  
Baltimore, MD 21204  
[klnb.com](http://klnb.com)



# SETON BUSINESS PARK

5601 Metro Drive, Baltimore, MD 21215  
Baltimore City

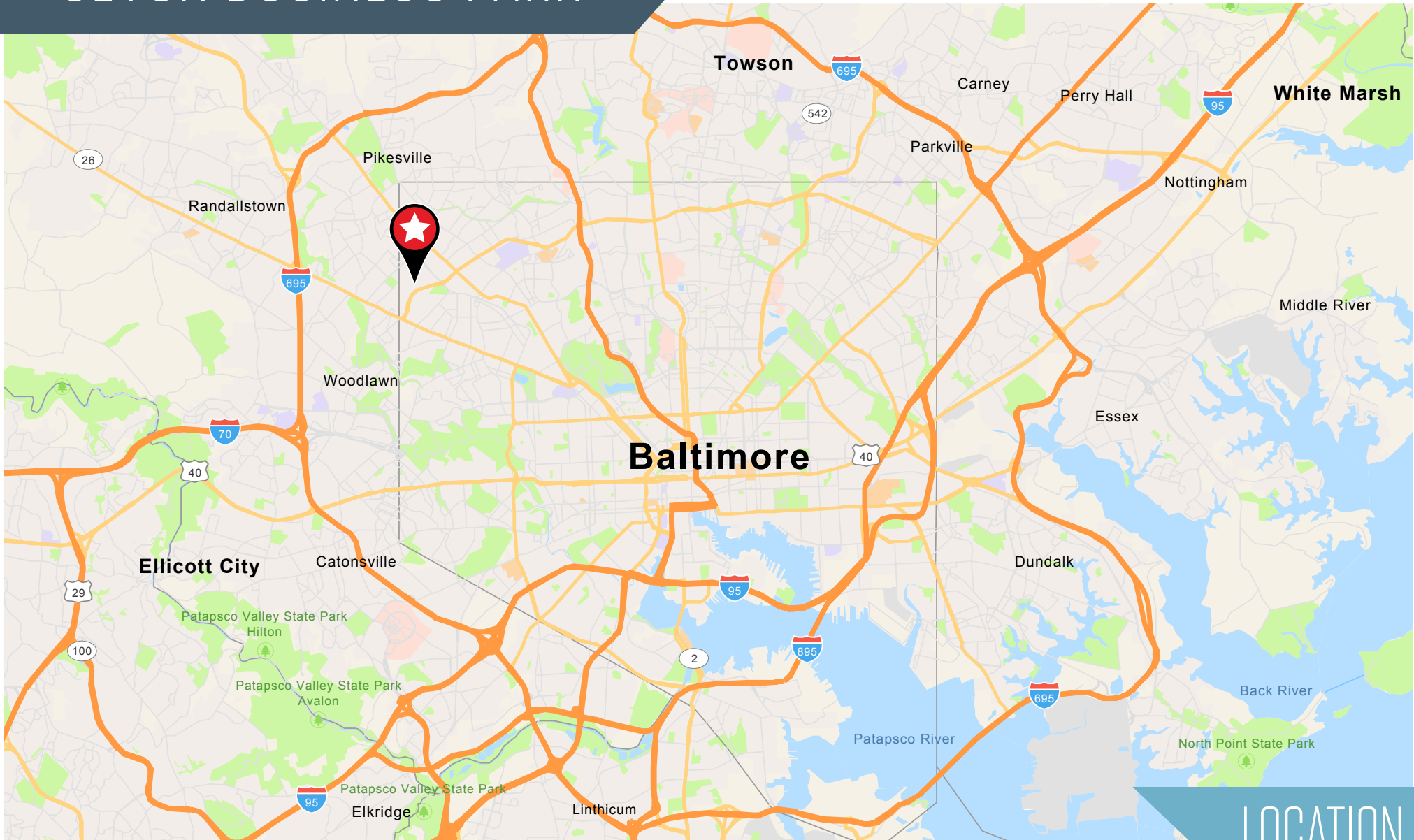

LOCATION

Jesse Schwartzman  
jschwartzman@klnb.com  
443-632-2067

100 West Road, Suite 505  
Baltimore, MD 21204  
klnb.com



# SETON BUSINESS PARK

5601 Metro Drive, Baltimore, MD 21215  
Baltimore City



BIRD'S-EYE AERIAL

Jesse Schwartzman  
jschwartzman@klnb.com  
443-632-2067

100 West Road, Suite 505  
Baltimore, MD 21204  
klnb.com



# SETON BUSINESS PARK

5601 Metro Drive, Baltimore, MD 21215  
Baltimore City

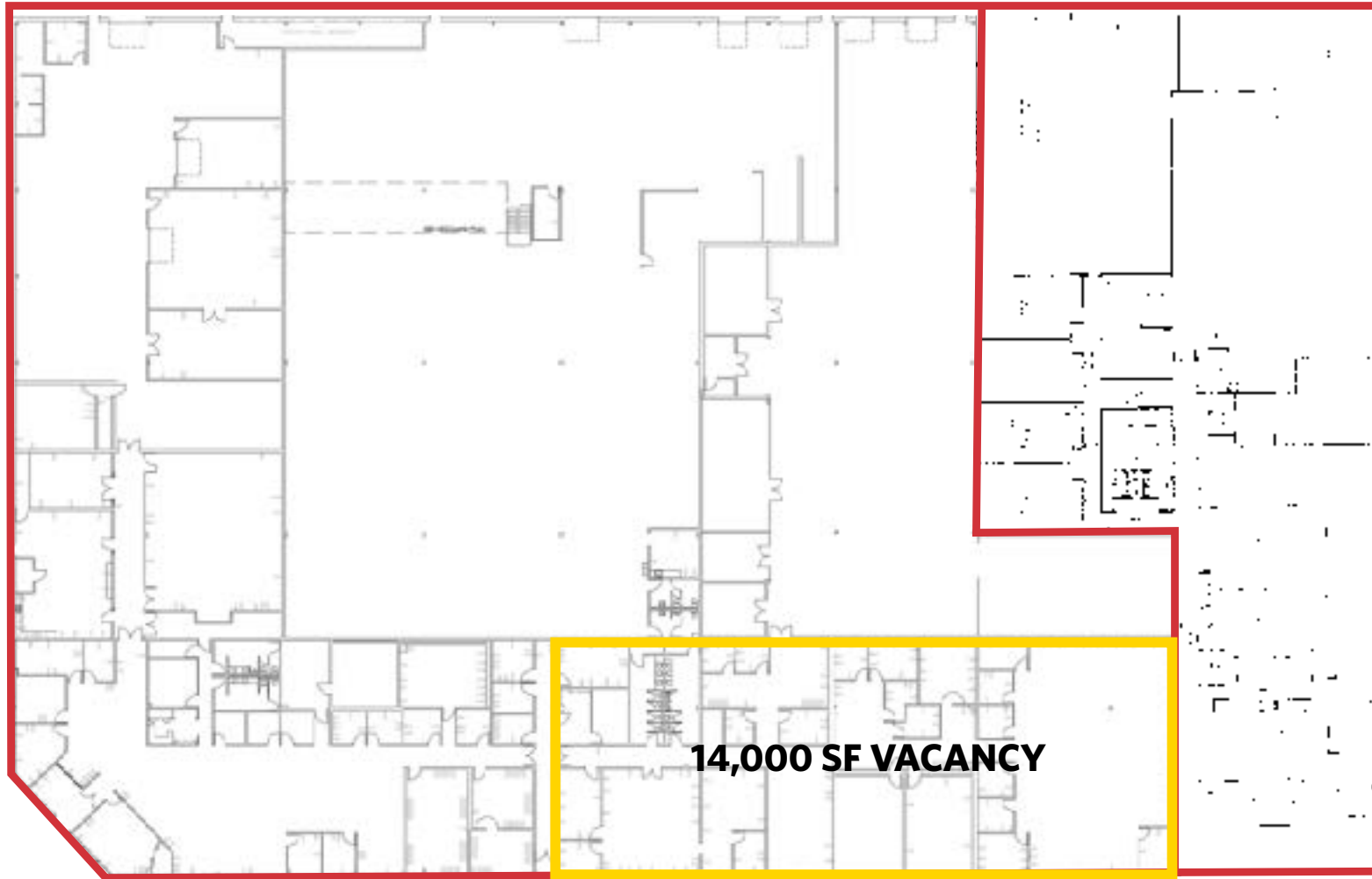

FLOOR PLAN

Jesse Schwartzman  
jschwartzman@klnb.com  
443-632-2067

100 West Road, Suite 505  
Baltimore, MD 21204  
klnb.com

**NA**klnb

# SETON BUSINESS PARK

5601 Metro Drive, Baltimore, MD 21215  
Baltimore City

[CLICK TO VIEW PROPERTY WEBSITE](#)

For More Information, Please Contact:

**Jesse Schwartzman**

[jschwartzman@klnb.com](mailto:jschwartzman@klnb.com)

443-632-2067

100 West Road, Suite 505  
Baltimore, MD 21204

[klnb.com](http://klnb.com)

 [facebook.com/KLNB](https://facebook.com/KLNB)

 [@KLNBLLC](https://twitter.com/KLNBLLC)

 [linkedin.com/company/klnb](https://linkedin.com/company/klnb)

 [instagram.com/klnbllc](https://instagram.com/klnbllc)

While we have no reason to doubt the accuracy of any of the information supplied, we cannot, and do not, guarantee its accuracy. All information should be independently verified prior to a purchase or lease of the property. We are not responsible for errors, omissions, misuse, or misinterpretation of information contained herein and make no warranty of any kind, express or implied, with respect to the property or any other matters.

**NAI**klnb