

LAST SPACE REMAINING AT THE NEW 599 LEX

25 FT CEILINGS ON THE 52ND STREET FOOD CORRIDOR

139
E 52ND
STREET
AT 599 LEX



SUBWAY
ENTRANCE
6 E M

40 FEET FRONTAGE

bxp Boston
Properties

**CUSHMAN &
WAKEFIELD**

Colliers
INTERNATIONAL

139

**E 52ND
STREET**

AT 599 LEX

PROPERTY DETAILS

SPECS

AVAILABLE SPACE

1,304 SF
GROUND FLOOR

40 FT
FRONTAGE

25 FT
CEILING HTS

**POSSESSION
IMMEDIATE**

**LEASE TYPE
DIRECT**

**ASKING RENT
UPON REQUEST**

- Can be vented
- Located adjacent to the lobby of a Class-A 1 million SF office tower
- Landlord to endorse tenant application for outdoor seating
- Join Sweetgreen (coming soon), Amazon Go, Sugarfish, By Chloe, Little Collins and more at the newly revamped Boston Properties' campus
- Interior and exterior signage possibilities
- Centrally located in the 52nd Street Food corridor: Urban Space, Field's Good Chicken, Dig Inn, Chipotle, Chop't, Subway, Ground Central, PotBelly, Starbucks, etc.

139
E 52ND
STREET

AT 599 LEX

FLOORPLANS
GROUND FLOOR

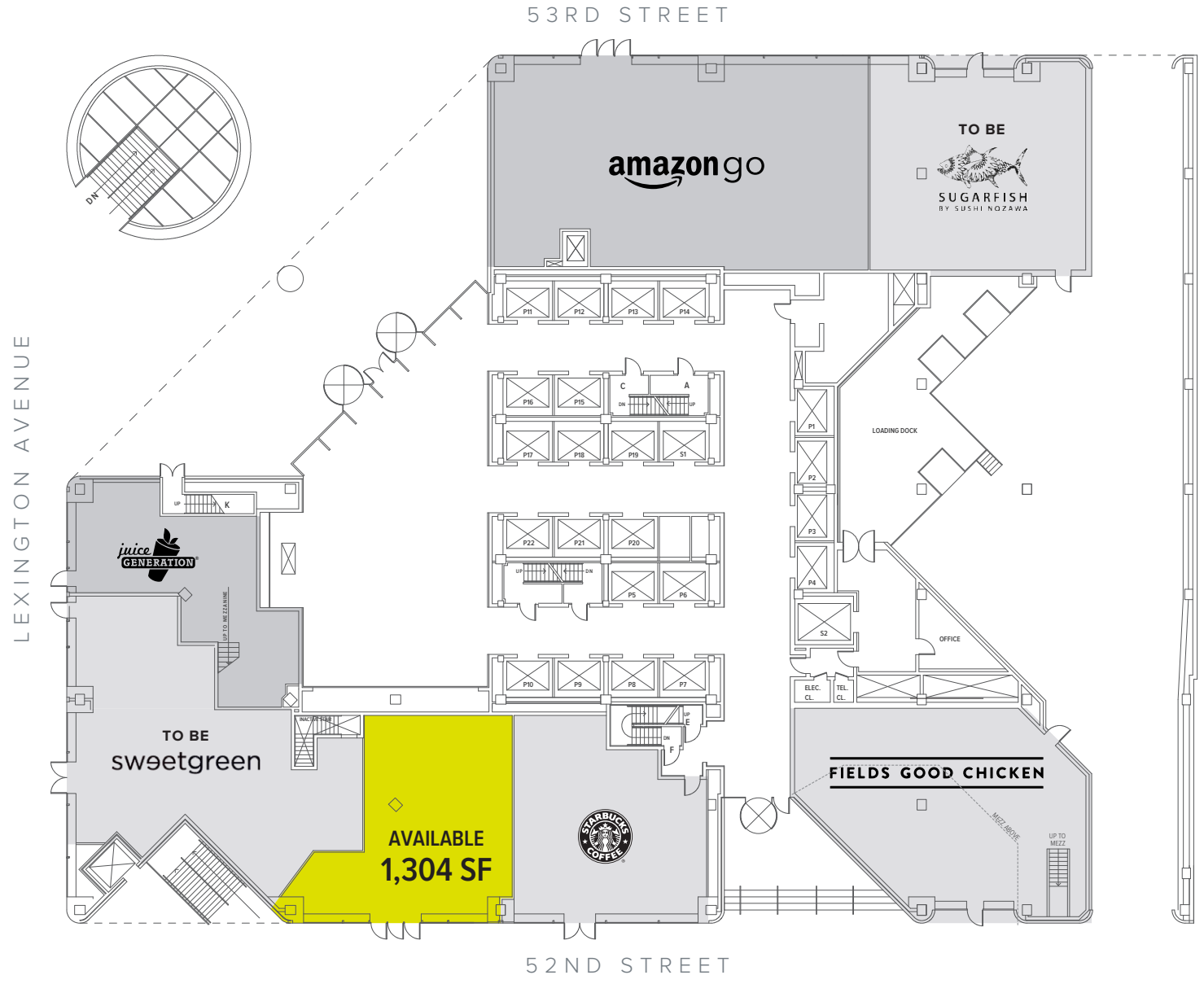

139
E 52ND
STREET

AT 599 LEX

AREA MAP

bxp Boston Properties
399 PARK AVENUE
1.7MM SF CLASS A
OFFICE BUILDING UNDER
REDEVELOPMENT

BY CHLOE

TO BE
LITTLE COLLINS
CVS

LE JARDINIER

PRET A MANGER

LE RELAIS DE VENISE
L'ENTRECOTE

OFFICES

SUBWAY
ENTRANCE

URBAN SPACE

SCHNIFFER'S

GODIVA CAFE

STARBUCKS

ST. PETER'S
CHURCH

bxp Boston Properties
601 LEXINGTON
1.7MM SF CLASS A
OFFICE BUILDING
AND FOOD HALL/
RESTAURANT UNDER
REDEVELOPMENT

53RD STREET

SUBWAY
ENTRANCE
G E M

AMAZON GO

TO BE
SUGARFISH

JUICE GENERATION

TO BE
SWEETGREEN

bxp Boston Properties
599 LEX

139
E 52ND
STREET
AT 599 LEX

52ND STREET

PARIS BAGUETTE

THE MILL

MAISON KAYSER

DUANE READE

51ST STREET

FRESH & CO

NEUHAUSE CHOCOLATIER

DOUBLE TREE HOTEL

EUPHORIE COSMETICS

DEMARCO COFFEE

THE NATIONAL

LEXINGTON AVENUE

NEIGHBORING
RETAILERS INCLUDE:

SWEETGREEN (COMING SOON)

STARBUCKS

FIELD'S GOOD CHICKEN

DIG INN

CHIPOTLE

POT BELLY SANDWICH SHOP

CHOP'T

GROUND CENTRAL COFFEE

JUICE PRESS

AMAZON GO

SUGARFISH (COMING SOON)

LITTLE COLLINS (COMING SOON)

MAISON KAYSER

URBANSPACE

139
E 52ND
STREET | AT 599 LEX

CONTACTS

STEVEN SOUTENDIJK
STEVEN.SOUTENDIJK@CUSHWAKE.COM
212 713 6845

DAVID A. GREEN
DAVID.A.GREEN@COLLIERS.COM
212 716 3599

MOLLY SANDZA
MOLLY.SANDZA@CUSHWAKE.COM
212 841 7955

TOMMY BOTSARIS
TOMMY.BOTSARIS@COLLIERS.COM
212 716 3649



©2020 CUSHMAN & WAKEFIELD. ALL RIGHTS RESERVED. THE INFORMATION CONTAINED IN THIS COMMUNICATION IS STRICTLY CONFIDENTIAL. THIS INFORMATION HAS BEEN OBTAINED FROM SOURCES BELIEVED TO BE RELIABLE BUT HAS NOT BEEN VERIFIED. NO WARRANTY OR REPRESENTATION, EXPRESS OR IMPLIED, IS MADE AS TO THE CONDITION OF THE PROPERTY (OR PROPERTIES) REFERENCED HEREIN OR AS TO THE ACCURACY OR COMPLETENESS OF THE INFORMATION CONTAINED HEREIN, AND SAME IS SUBMITTED SUBJECT TO ERRORS, OMISSIONS, CHANGE OF PRICE, RENTAL OR OTHER CONDITIONS, WITHDRAWAL WITHOUT NOTICE, AND TO ANY SPECIAL LISTING CONDITIONS IMPOSED BY THE PROPERTY OWNER(S). ANY PROJECTIONS, OPINIONS OR ESTIMATES ARE SUBJECT TO UNCERTAINTY AND DO NOT SIGNIFY CURRENT OR FUTURE PROPERTY PERFORMANCE.