



FOR LEASE

Parkview B Medical Office

1151 East 3900 South / Salt Lake City, Utah 84124



Turnkey medical suite located directly across the street from St. Mark's Hospital



Alison Beddard
Senior Director
+1 801 303 5568
alison.beddard@cushwake.com

Anna Kaessner
Associate
+1 801 303 5447
anna.kaessner@cushwake.com

170 South Main Street, Suite 1600
Salt Lake City, UT 84101
Main +1 801 322 2000
Fax +1 801 322 2040
cushmanwakefield.com



Front Lobby



Exam Room

Property Highlights

- Lease Rate: \$21.00 RSF, Full Service
- Suite 299B: 9,252 RSF
- Building Parking: 225 stalls
- Centrally located medical office building
- Tenant improvements negotiable
- Signage available

Suite Features →

- 9,252 RSF Turn Key Medical Suite
- 22 exam rooms with sinks
- 6 restrooms
- 2 break areas

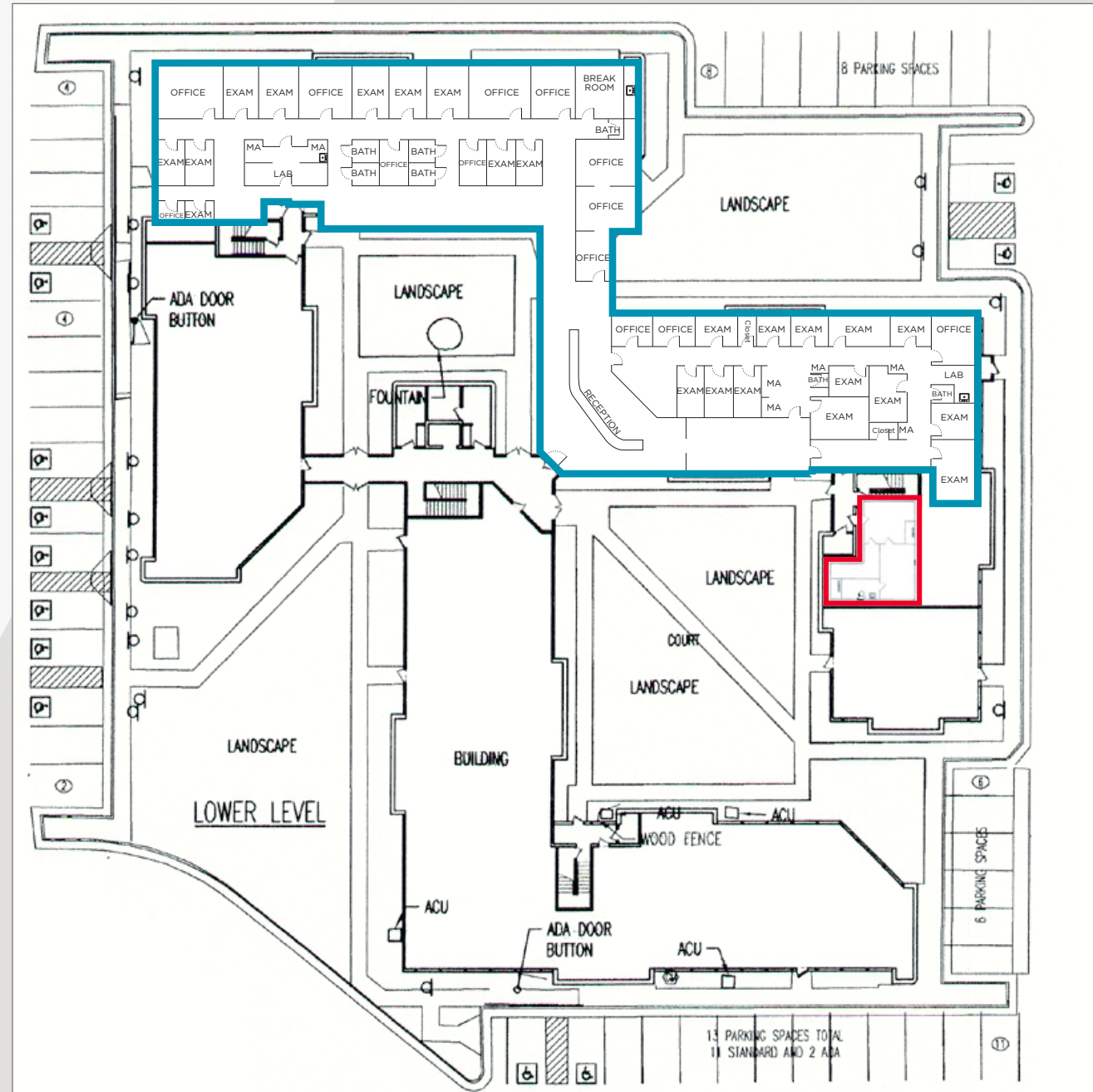

13 PARKING SPACES TOTAL
 11 STANDARD AND 2 ADA

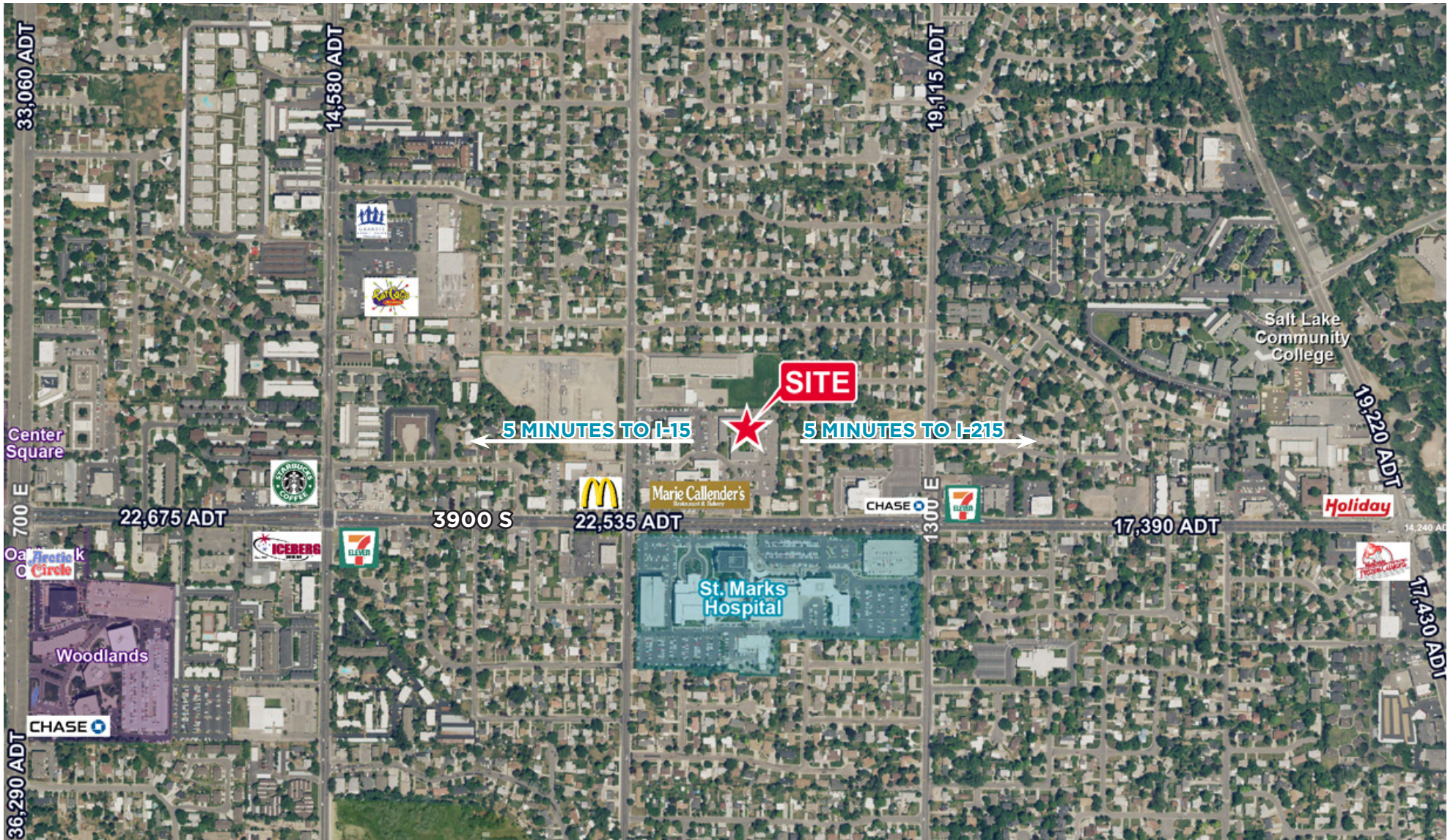

Alison Beddard
Senior Director
+1 801 303 5568
alison.beddard@cushwake.com

Anna Kaessner
Associate
+1 801 303 5447
anna.kaessner@cushwake.com

170 South Main, Suite 1600
Salt Lake City, UT 84101
Main +1 801 322 2000
Fax +1 801 322 2040
cushmanwakefield.com