

FOR SALE

±20,087 Square Feet

Voit

REAL ESTATE SERVICES



580 S. Melrose Street, Placentia

Property Features

- High Image Freestanding Building
- ±7,929 Sq. Ft. of Well Appointed Two Story Office Area
- Two (2) Interior Truckwells
- One (1) Ground Level Loading Door (12' x 14')
- 225 Amps of 480 Volt Power (Verify)
- 22' Minimum Warehouse Clearance
- Drive Around Building
- 37 Parking Stalls (Verify)
- Fire Sprinklers (.33 GPM/3,000 Sq. Ft.)
- Abundant Glass Line
- Desirable East Anaheim/Placentia Location
- Street Frontage on Corner Parcel
- Excellent Access to 91, 57 and 55 Freeways
- Shop Restrooms
- Bonus Warehouse Mezzanine Storage

Mike Vernick, CCIM, SIOR
Vice President
714.935.2354
mvernick@voitco.com
Lic. #01420885

Morgan Hill
Associate
714.935.2322
mhill@voitco.com
Lic #01877356

Mike Hefner, SIOR
Executive Vice President
714.935.2331
mhefner@voitco.com
Lic #00857352

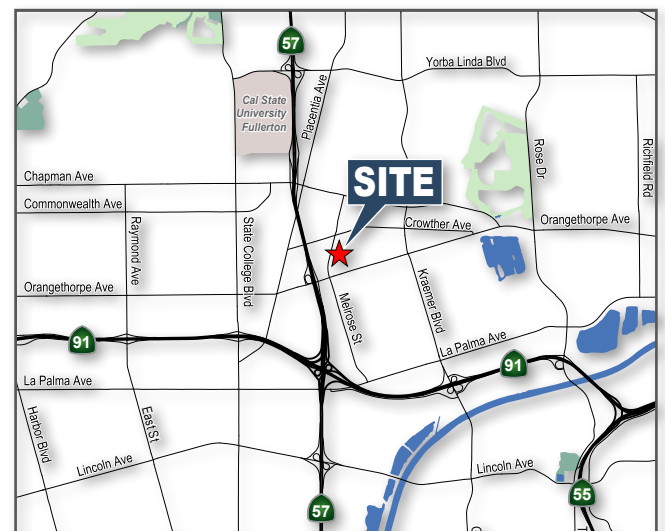

2400 E. Katella Avenue, Suite 750, Anaheim, CA 92806 • 714.978.7800 • 714.978.9431 Fax • Lic #01333376 | www.voitco.com

Real People. Real Solutions.®

FOR SALE

±20,087 Square Feet

580 S. Melrose Street, Placentia

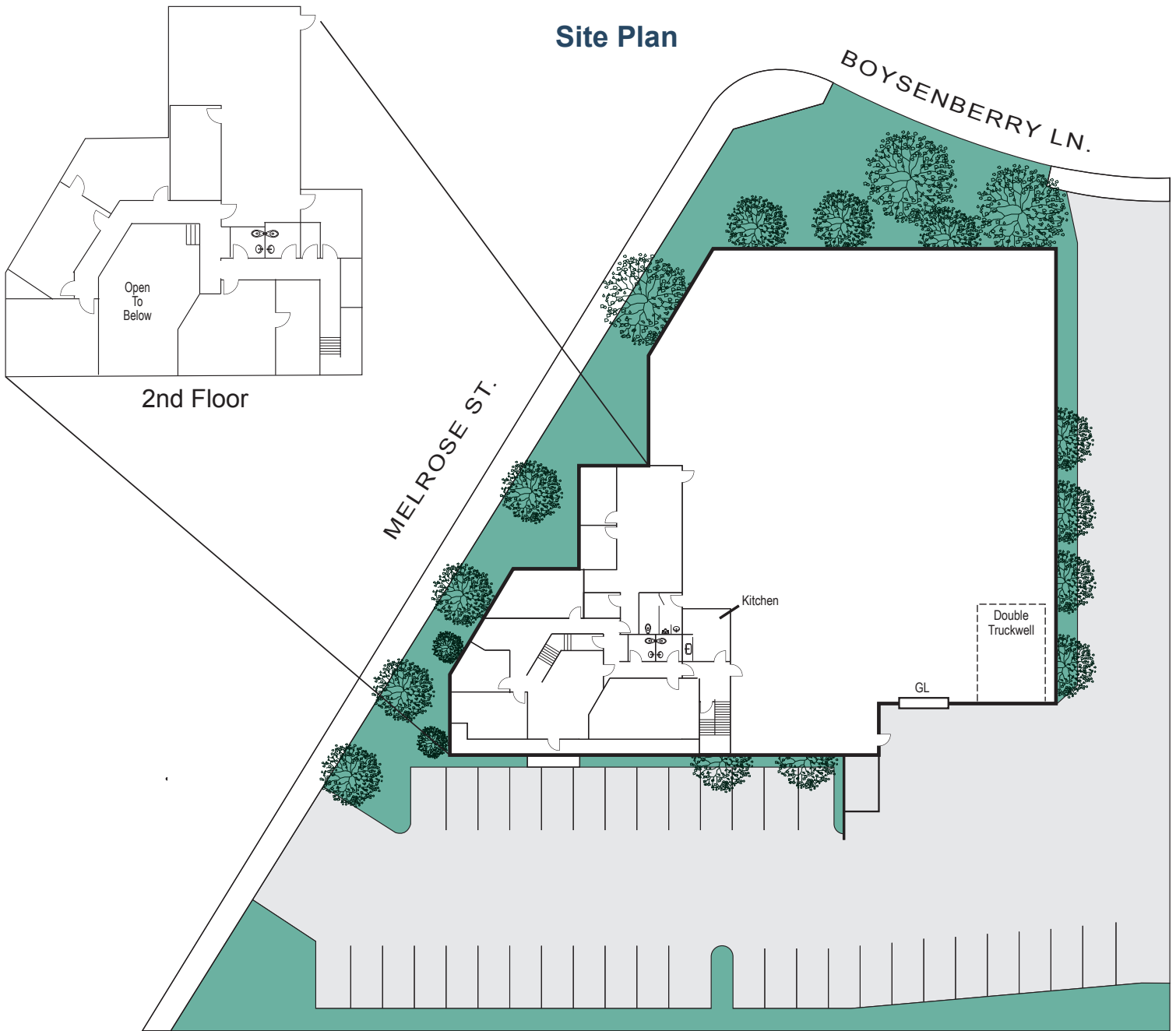

Mike Vernick, CCIM, SIOR
Vice President
714.935.2354
mvernick@voitco.com
Lic. #01420885

Morgan Hill
Associate
714.935.2322
mhill@voitco.com
Lic #01877356

Mike Hefner, SIOR
Executive Vice President
714.935.2331
mhefner@voitco.com
Lic #00857352

Voit
REAL ESTATE SERVICES

2400 E. Katella Ave., Suite 750, Anaheim, CA 92806 • 714.978.7880 • 714.978.9431 Fax • Lic #01333376 | www.voitco.com