

Shops on Seltice;

**Retail Space For Lease
Ideal for Health & Fitness Use**

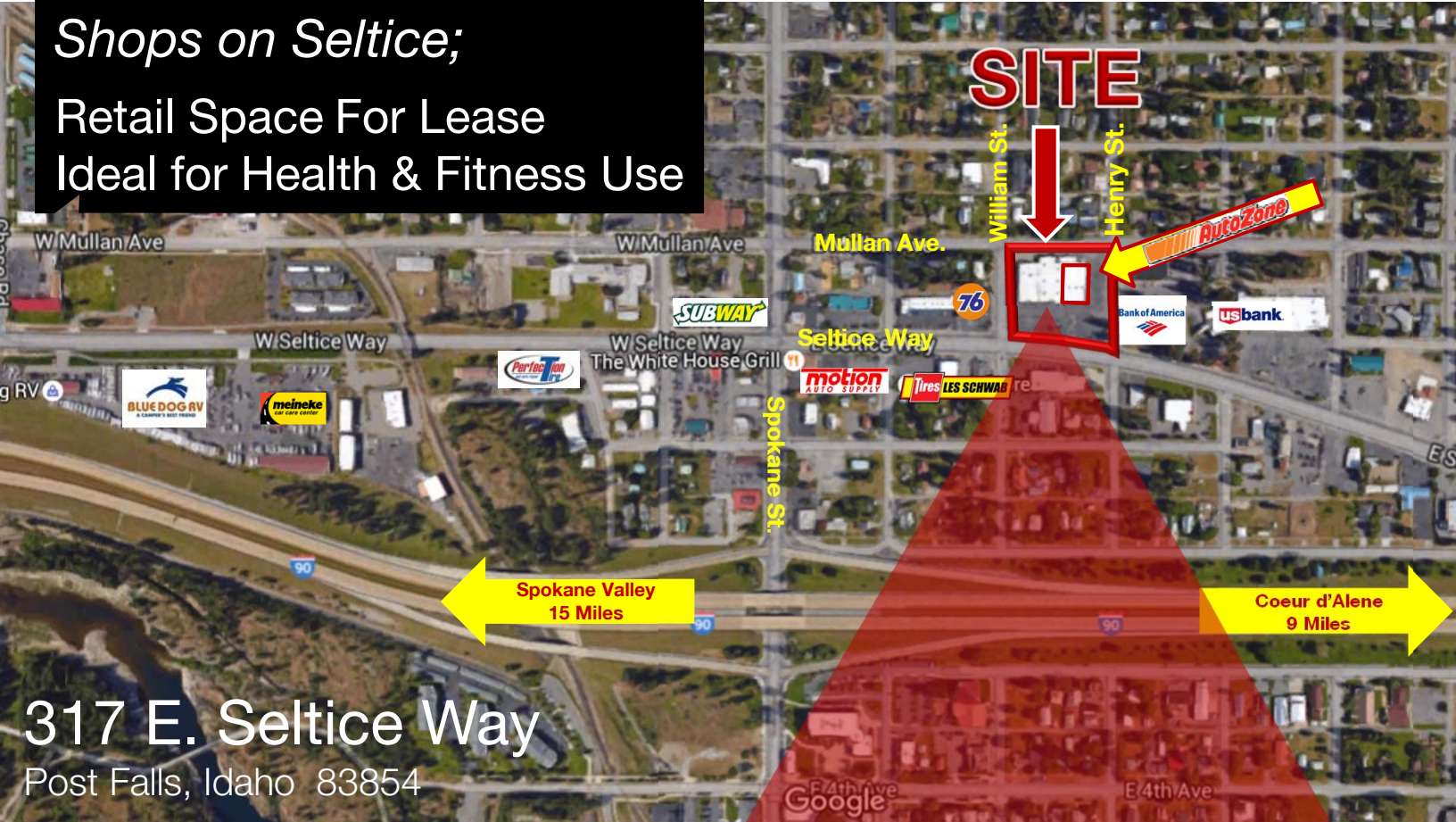

317 E. Seltice Way
Post Falls, Idaho 83854

Space Available:

- Space A: 7,282 SF ° (Corner Location)
- Space B: 5,000 SF ° (Tall Ceiling)
 - Landlord Will Expand This Store Front Glass
- Warehouse Space: 1,430 SF
- Rear of Center Abuts E. Mullan Ave.
for Additional Sign Placement
- Full City Block

Property Features

- Great Visibility
- Rear Receiving Doors
- High Traffic
- Double-Facing Pylon Sign
- Dedicated Parapet Façade Sign Opportunity
- Ample Parking
- Co-Tenants:
 - Auto Zone
 - Idaho Youth Ranch
- Near By Businesses:
 - Motion Auto Supply
 - Bank of America
 - US Bank
 - Subway Restaurants
 - Walgreens
 - White House Grill
 - ID State Liquor Store
 - Union 76 Convenience Store



**Space A
Available**

**Space B
Available**

Lease Rate:

\$10.00/PSF NNN

For More Information, Please Contact:

Stephen Pohl

+1 509 622 3568

spohl@naiblack.com

ID Lic: #AB42233

Steve Ridenour

+1 208 660 5010

sridenour@naiblack.com

ID Lic: #SP21567

Owner is a Licensed Real Estate Broker

NO WARRANTY OR REPRESENTATION, EXPRESS OR IMPLIED, IS MADE AS TO THE ACCURACY OF THE INFORMATION CONTAINED HEREIN, AND THE SAME IS SUBMITTED SUBJECT TO ERRORS, OMISSIONS, CHANGE OF PRICE, RENTAL OR OTHER CONDITIONS, PRIOR SALE, LEASE OR FINANCING, OR WITHDRAWAL WITHOUT NOTICE, AND OF ANY SPECIAL LISTING CONDITIONS IMPOSED BY OUR PRINCIPALS NO WARRANTIES OR REPRESENTATIONS ARE MADE AS TO THE CONDITION OF THE PROPERTY OR ANY HAZARDS CONTAINED THEREIN ARE ANY TO BE IMPLIED

NAIBlack

Black Commercial, Inc.
107 S. Howard; Suite 500
Spokane, WA 99201
+1 509 623 1000
naiblack.com

SITE PLAN

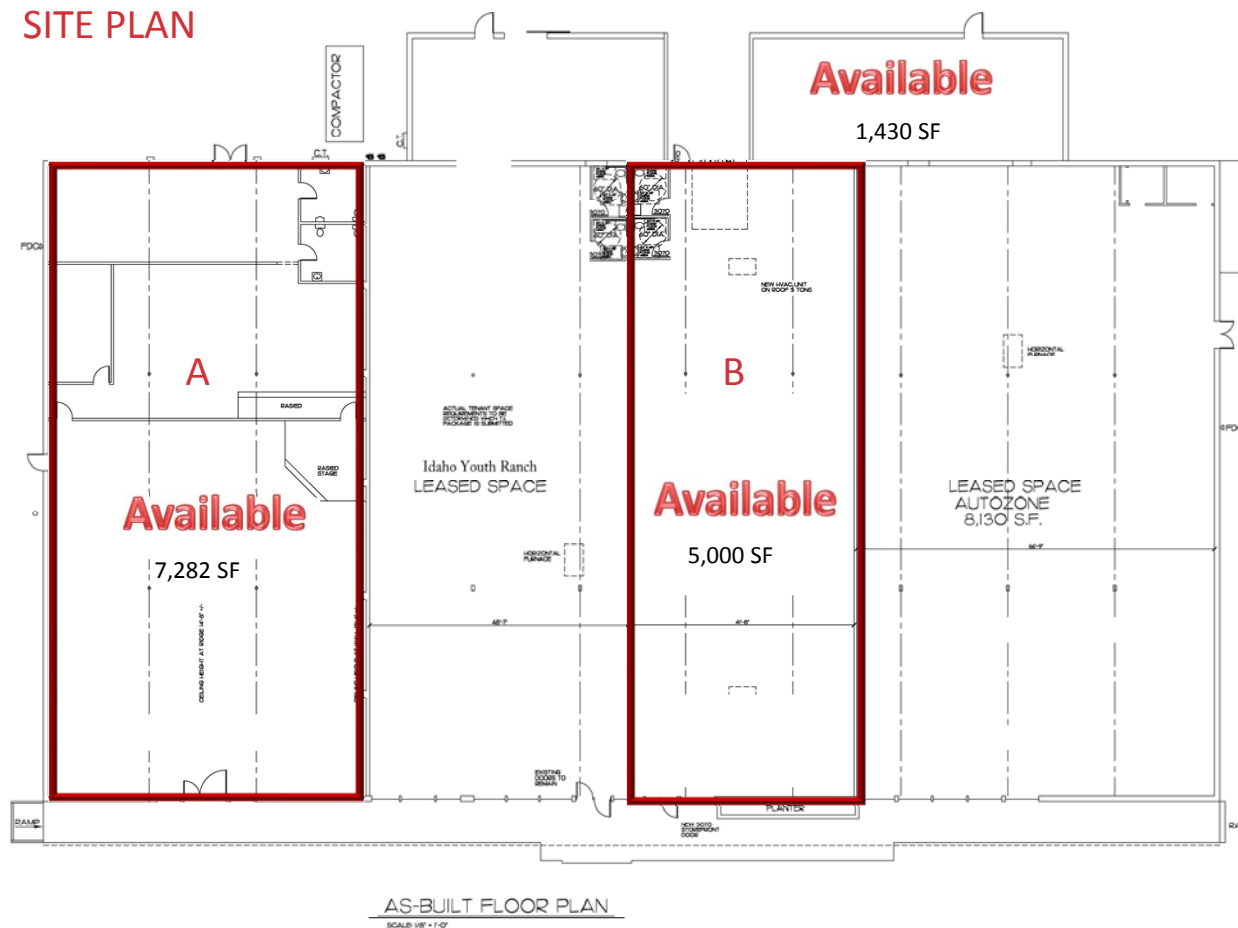

BAKER CONSTRUCTION E. 27th SPACED SPOKANE, WASHINGTON 99202 509-335-3668 FAX: 509-335-3720	
PROJECT: SPENCER'S POST FALLS, IDAHO LEASE FLOOR PLAN	DATE: FEB 17, 2006 SHEET: LS-1

For More Information, Please Contact:

Stephen Pohl

+1 509 622 3568

spohl@naiblack.com

ID Lic: #AB42233

Steve Ridenour

+1 208 660 5010

sridenour@naiblack.com

ID Lic: #SP21567



NAI Black

NAI Black respects the intellectual property rights of others. If you believe that your intellectual property rights have been violated by NAI Black or by a third party who has uploaded Content on our Site, please provide the following information to the NAI Black designated copyright agent as addressed below: a. A description of the copyrighted work or other intellectual property that you claim has been infringed; b. A specific description of where the material that you claim is infringing is located on the Site so the agent is able to locate it; c. An address, telephone number, and e-mail address where NAI Black can contact you and, if different, an e-mail address where the alleged infringing party, if not NAI Black, can contact you; d. A signed statement that you have a good-faith belief that the material use is not authorized by the copyright owner or other intellectual property rights owner, by its agent, or by law. e. A signed statement by you under penalty of perjury that the information in your notice is accurate and that you are the copyright or intellectual property owner or are authorized to act on the owner's behalf; After reviewing the complaint and determining if the complaint is valid, NAI Black will work to quickly remove the infringing material or disable access to it. Note: There are substantial penalties for false claims. NAI Black may request additional information before removing any infringing material. NAI Black may provide the alleged infringing party with your e-mail address so that that person can respond to your allegations. NAI Black has registered a designated agent with the Copyright Office pursuant to 17 U.S.C. 512(c). If you believe your copyright material is being used on this Site without permission, please notify the designated agent as follows:

By e-mail:
commercial@naiblack.com
Subject Line: Copyright Concern

By mail:
NAI Black
Attention: DMCA Designated Agent
107 S. Howard Street, Suite #500
Spokane, WA 99201

If e-mailing your copyright infringement notice, then NAI Black must receive the signed statement(s) mentioned above by mail, or attached to the e-mail, before we are required to take action.

Shops on Seltice;

For Lease

317 E. Seltice Way

Post Falls, ID 83835



2018 Demographics:

	<u>3 Mile</u>	<u>5 Miles</u>	<u>7 Miles</u>
Population:	38,111	49,450	89,668
Average HHI:	\$65,724	\$69,294	\$70,867
Median Age:	35.5	36.7	36.7
2023 Projected Population:	42,421	55,084	100,213

	<u>5 Min.</u>	<u>10 Min.</u>	<u>15 Min.</u>
Population:	17,743	45,381	127,873
Average HHI:	\$61,260	\$64,962	\$70,457
Median Age:	35.1	35.7	37.2
2023 Projected Population:	19,626	50,449	127,889

Traffic Counts:

E Seltice Way: 16,000 VPD

N Spokane St: 16,821 VPD

I-90: 48,500 VPD

9 Miles from Coeur d'Alene, ID

15 Miles from Spokane Valley, WA



For More Information, Please Contact:

Stephen Pohl

+1 509 622 3568

spohl@naiblack.com

ID Lic: #AB42233

Steve Ridenour

+1 208 660 5010

sridenour@naiblack.com

ID Lic: #SP21567

NO WARRANTY OR REPRESENTATION, EXPRESS OR IMPLIED, IS MADE AS TO THE ACCURACY OF THE INFORMATION CONTAINED HEREIN, AND THE SAME IS SUBMITTED SUBJECT TO ERRORS, OMISSIONS, CHANGE OF PRICE, RENTAL OR OTHER CONDITIONS, PRIOR SALE, LEASE OR FINANCING, OR WITHDRAWAL WITHOUT NOTICE, AND OF ANY SPECIAL LISTING CONDITIONS IMPOSED BY OUR PRINCIPALS. NO WARRANTIES OR REPRESENTATIONS ARE MADE AS TO THE CONDITION OF THE PROPERTY OR ANY HAZARDS CONTAINED THEREIN ARE ANY TO BE IMPLIED.

Black Commercial, Inc.
107 S. Howard; Suite 500
Spokane, WA 99201
+1 509 623 1000
naiblack.com