

828 W Grace St

Chicago, IL 60613

Wrigleyville

FOR LEASE

3,106 Sq Ft | Lakeview Retail at Halsted



Description:

Size: 3,106 Sq Ft
Zoning: B3-5
Alderman: Cappelman
Electrical Service: 200 Amp 2,277 / 480 V

Highlights:

- Upscale retail available on ground floor of Parkview East, a luxury residential condo development constructed in 2008
- Excellent visibility on Grace Street, featuring 10' windows and custom build-out potential
- Extra high 17' ceilings allow option to build a mezzanine loft 2nd floor area for additional storage, office space, etc.
- Ideal for day care, office, medical office, restaurant, salon / spa, retail or showroom use
- Garage parking available for sale or lease
- Rear loading area access via garage off alley

MILLER
CHICAGO

www.millerchicagorealestate.com

Andrea Miller

312 513 8333

andrea@millerchicagorealestate.com

SITE PLAN

828 W Grace St

Wrigleyville
Chicago, IL 60613

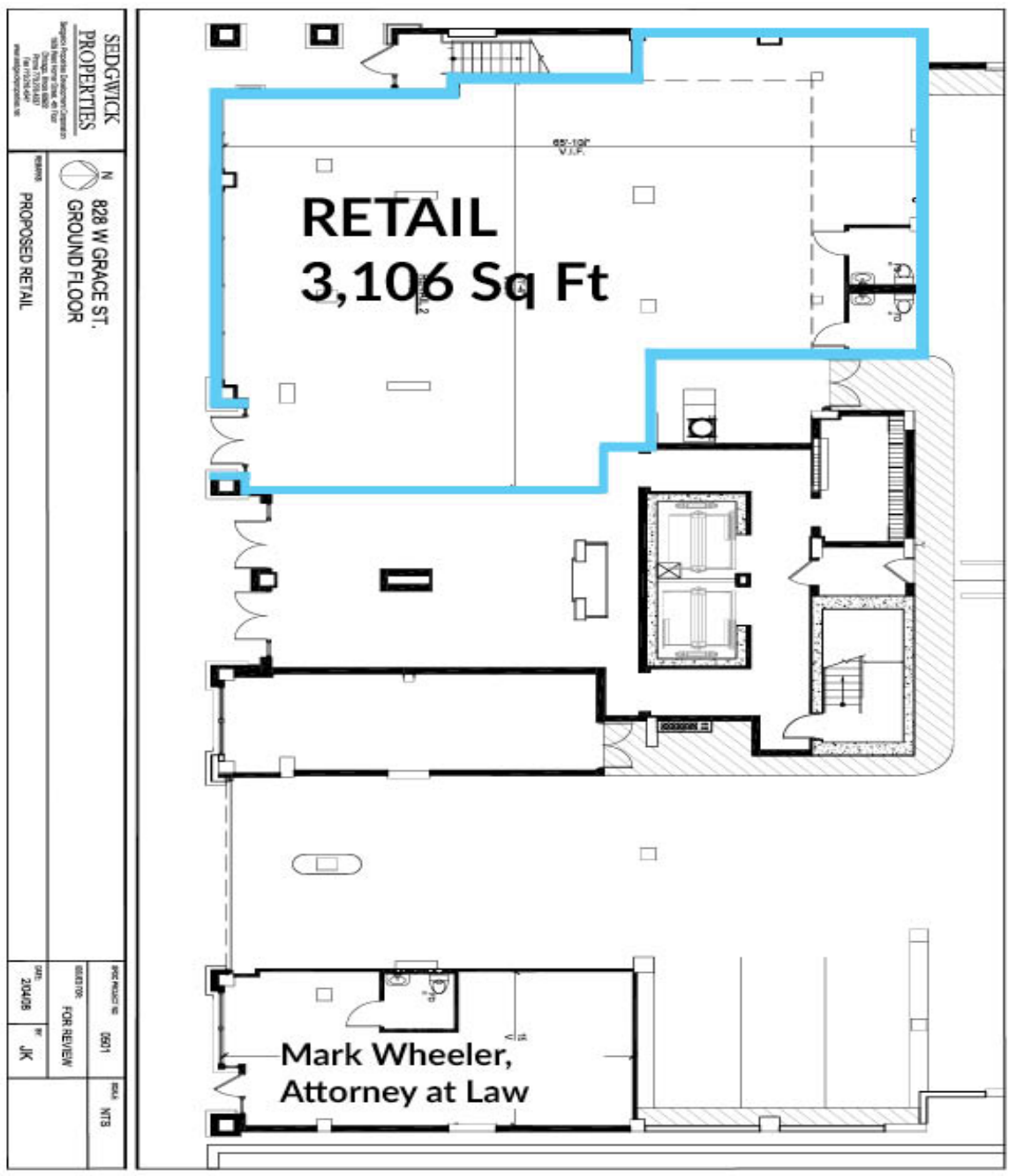

AREA MAP

828 W Grace St

Wrigleyville

Chicago, IL 60613

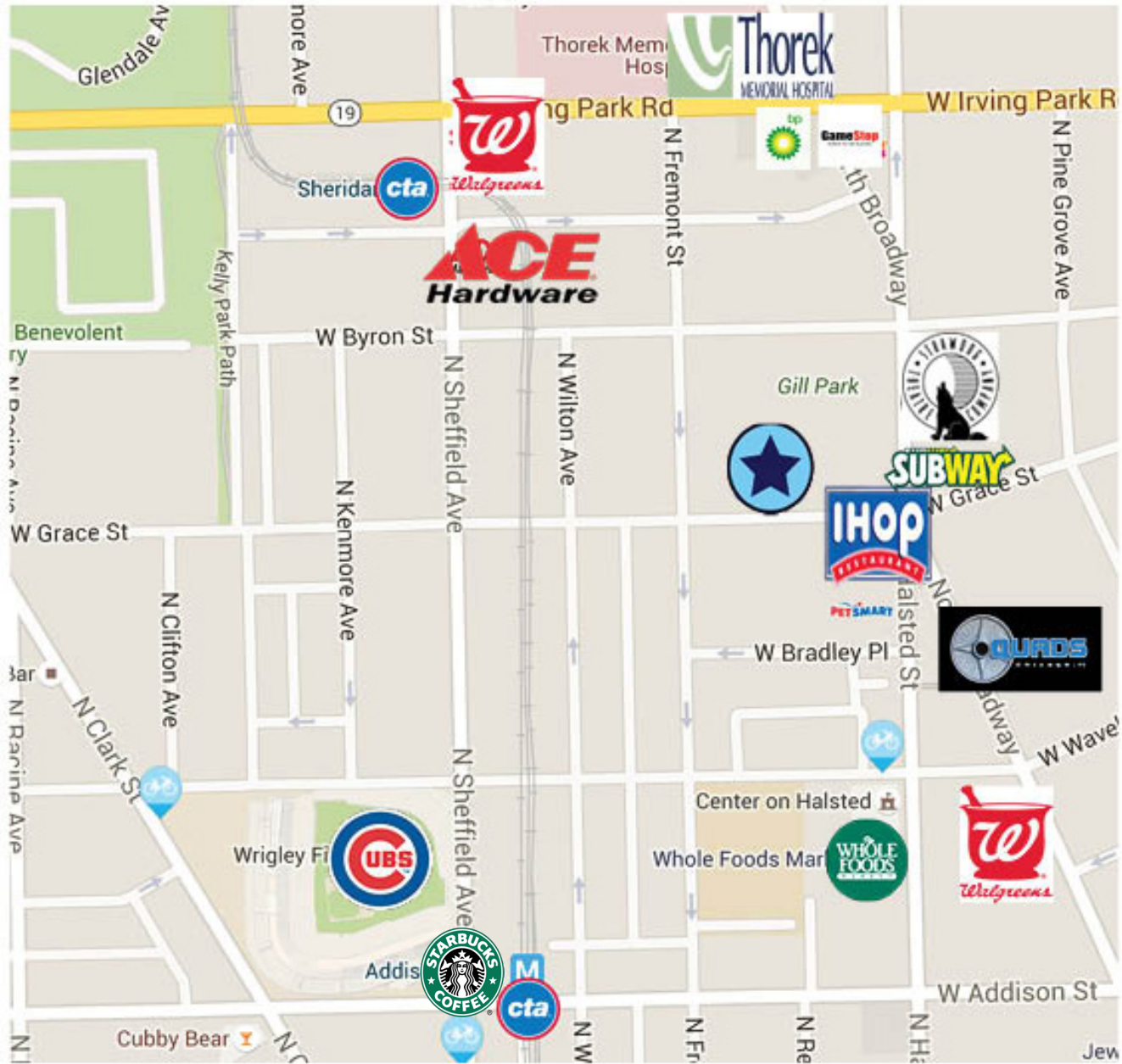

Divvy Bike Station



828 W Grace, Chicago, IL 60613