



**PREMIER
PROPERTIES**
COMMERCIAL
REAL ESTATE

FOR LEASE

2305 EL CAMINO REAL

Palo Alto, CA

RESTAURANT SPACE WITHIN
THE CALIFORNIA AVE. DISTRICT

±1,358 Sq. Ft.

Suitable for Restaurant, Retail, Personal Services
AVAILABLE IMMEDIATELY



BRAD EHIKIAN

Partner
dre license #01736391
📞 | 650.618.3001
✉ | brad.ehikian@prprop.com

JON GOLDMAN

Partner
dre license #01295503
📞 | 650.618.3003
✉ | jon.goldman@prprop.com

JESSE EBNER

Associate
dre license #02055989
📞 | 650.618.3017
✉ | jesse.ebner@prprop.com

PROPERTY DESCRIPTION

- ▶ Prime Corner Location Along El Camino Real in Palo Alto with High Visibility
- ▶ Ideal for Restaurant, Retail or Personal Services
- ▶ Existing Restaurant Infrastructure
- ▶ Building Built in 2007
- ▶ Prominent Signage & Large Windows
- ▶ Adjacent to Public Parking Lot, Street Parking & Close to Stanford Research Park



BRAD EHIKIAN
Partner
dre license #01736391
☎ | 650.618.3001
✉ | brad.ehikian@prprop.com

JON GOLDMAN
Partner
dre license #01295503
☎ | 650.618.3003
✉ | jon.goldman@prprop.com

JESSE EBNER
Associate
dre license #02055989
☎ | 650.618.3017
✉ | jesse.ebner@prprop.com

FLOOR PLAN

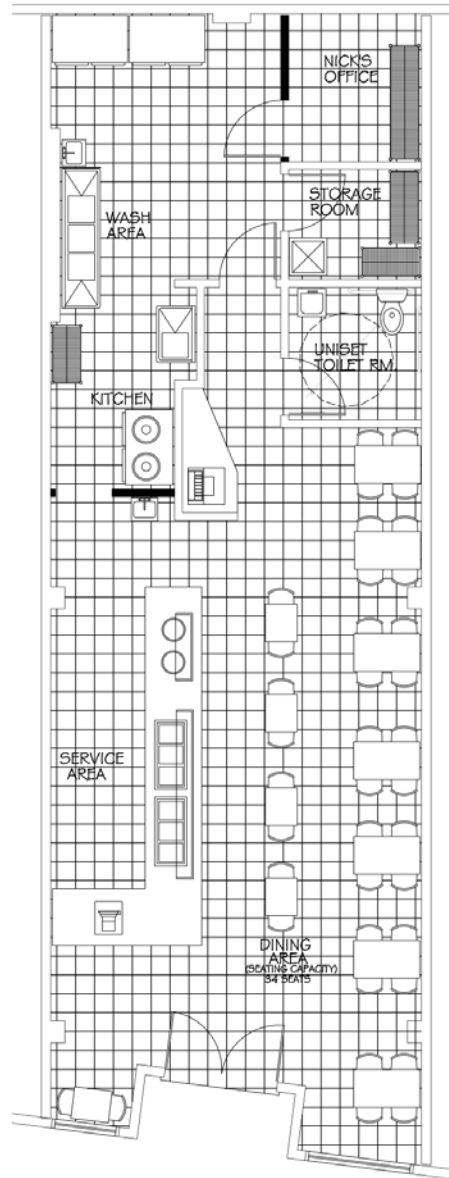

BRAD EHIKIAN
Partner
dre license #01736391
☎ | 650.618.3001
✉ | brad.ehikian@prprop.com

JON GOLDMAN
Partner
dre license #01295503
☎ | 650.618.3003
✉ | jon.goldman@prprop.com

JESSE EBNER
Associate
dre license #02055989
☎ | 650.618.3017
✉ | jesse.ebner@prprop.com

AMENITIES MAP



BRAD EHIKIAN
Partner
dre license #01736391
☎ | 650.618.3001
✉ | brad.ehikian@prprop.com

JON GOLDMAN
Partner
dre license #01295503
☎ | 650.618.3003
✉ | jon.goldman@prprop.com

JESSE EBNER
Associate
dre license #02055989
☎ | 650.618.3017
✉ | jesse.ebner@prprop.com

TRANSPORTATION AERIAL

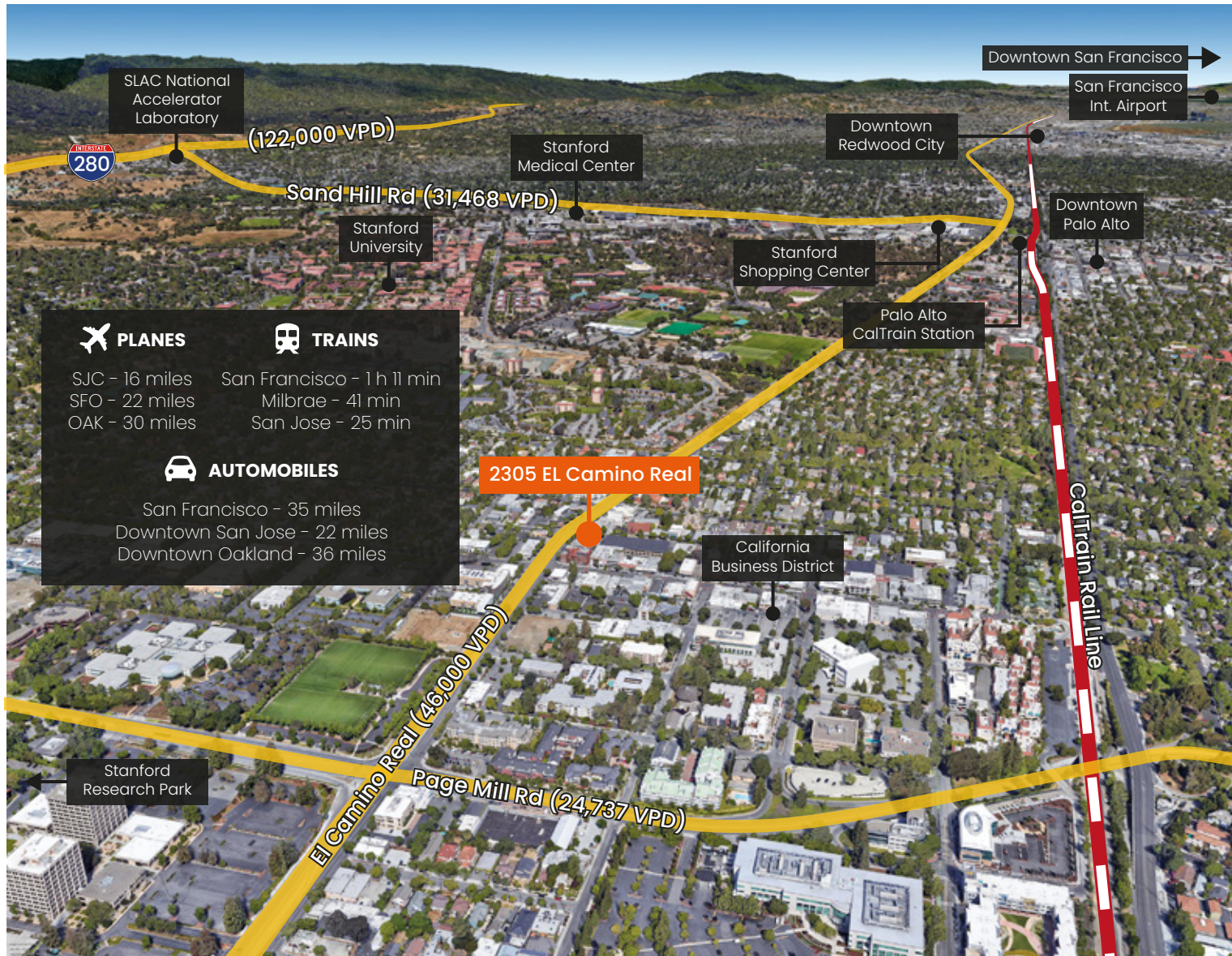

BRAD EHIKIAN
 Partner
 dre license #01736391
 ☎ | 650.618.3001
 ✉ | brad.ehikian@prprop.com

JON GOLDMAN
 Partner
 dre license #01295503
 ☎ | 650.618.3003
 ✉ | jon.goldman@prprop.com

JESSE EBNER
 Associate
 dre license #02055989
 ☎ | 650.618.3017
 ✉ | jesse.ebner@prprop.com

DEMOGRAPHICS



MEDIAN AGE
29.1

HOUSEHOLDS
187,8

FAMILIES
22,904

FAMILIES **22,904** Median Household Income **\$115,029**

Average Household Size: **2.3** Owner Occupied Housing Units: **4,055** Renter Occupied Housing Units: **5,728** Median Household Income: **\$115,029** Average Household Income: **\$187,815**

MAJOR EMPLOYERS:

Data for all businesses in area	1 mile	3 miles	5 miles
Total Businesses:	1385	8,693	14,581
Total Employees:	20,162	144,382	219,553
Total Residential Population:	22,904	141,298	288,069
Employee/Residential Population Ratio (per 100 Residents)	91	84	78



BRAD EHIKIAN
Partner
dre license #01736391
☎ | 650.618.3001
✉ | brad.ehikian@prprop.com

JON GOLDMAN
Partner
dre license #01295503
☎ | 650.618.3003
✉ | jon.goldman@prprop.com

JESSE EBNER
Associate
dre license #02055989
☎ | 650.618.3017
✉ | jesse.ebner@prprop.com