

# Clarkson Wilson Center

2-92 Clarkson Wilson Center

Chesterfield, MO 63017

## 2,930 SF RETAIL ENDCAP AVAILABLE FOR LEASE

**ENDCAP OPPORTUNITY!**  
**(FORMER TENANT EXPANDED INTO LARGER  
SPACE IN SHOPPING CENTER)**



## HUTKIN DEVELOPMENT COMPANY

10829 Olive Boulevard  
Suite 200  
St. Louis, MO 63141

Telephone 314.872.9140  
FAX 314.872.9001

Visit our website:  
[www.hutkin.com](http://www.hutkin.com)

### CONTACT

Tony Giarratano  
[tony@hutkin.com](mailto:tony@hutkin.com)  
Cell 314.276.2352

Bo Keefer  
[bkeefer@hutkin.com](mailto:bkeefer@hutkin.com)  
Cell 314.973.1242

### ■ 2,930 SF Endcap Available

■ 2-4 Clarkson Wilson Center

■ Owner will consider demising to approximately 1,465 SF

■ Signage available on two sides of the building including exposure on Clarkson Road

■ **LEASE RATE: CALL FOR DETAILS**

■ Join Sarah's Cake Shop, Kennelwood Village, Subway and other long-standing tenants in thriving neighborhood retail center

■ Signalized intersection at Clarkson Road and Wilson Road

■ Convenient access and parking

■ 2017 traffic volume on Clarkson Road: 41,893 vehicles per day

# Clarkson Wilson Center

2-92 Clarkson Wilson Center  
Chesterfield, MO 63017

## 2,930 SF RETAIL ENDCAP AVAILABLE FOR LEASE

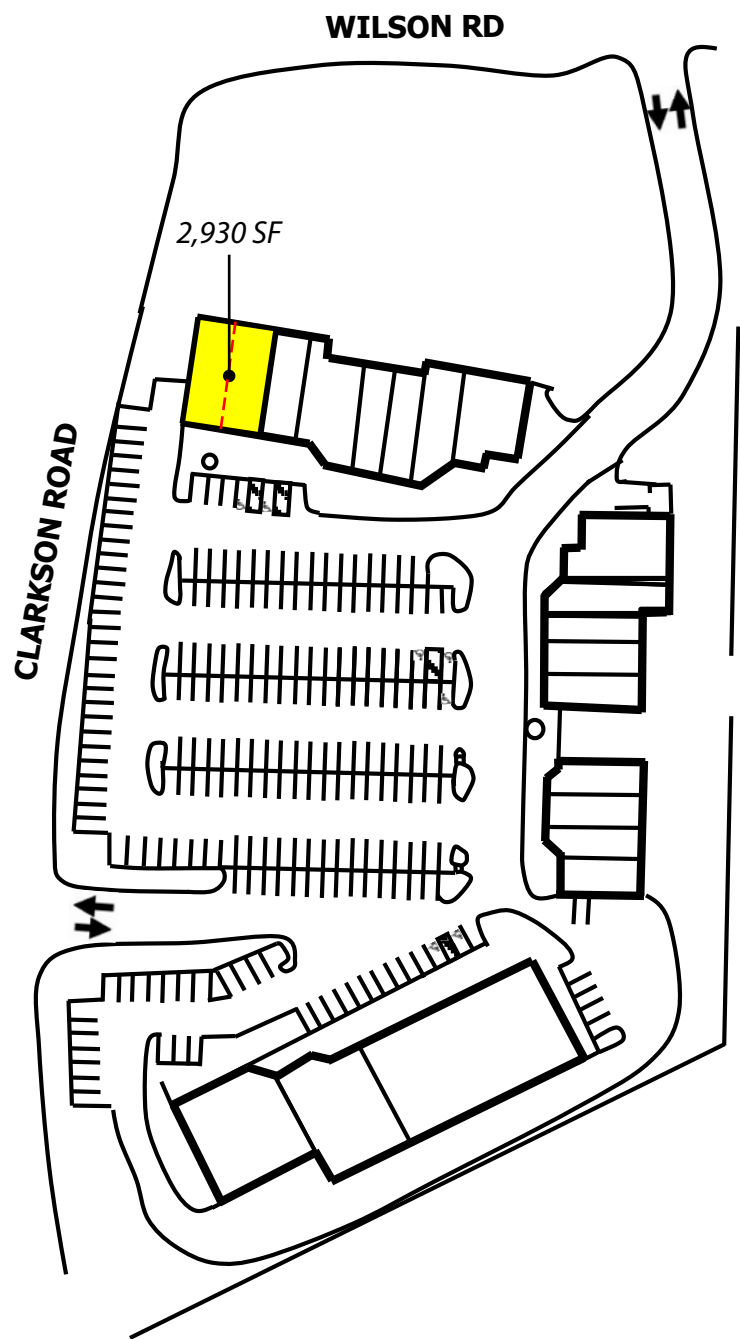
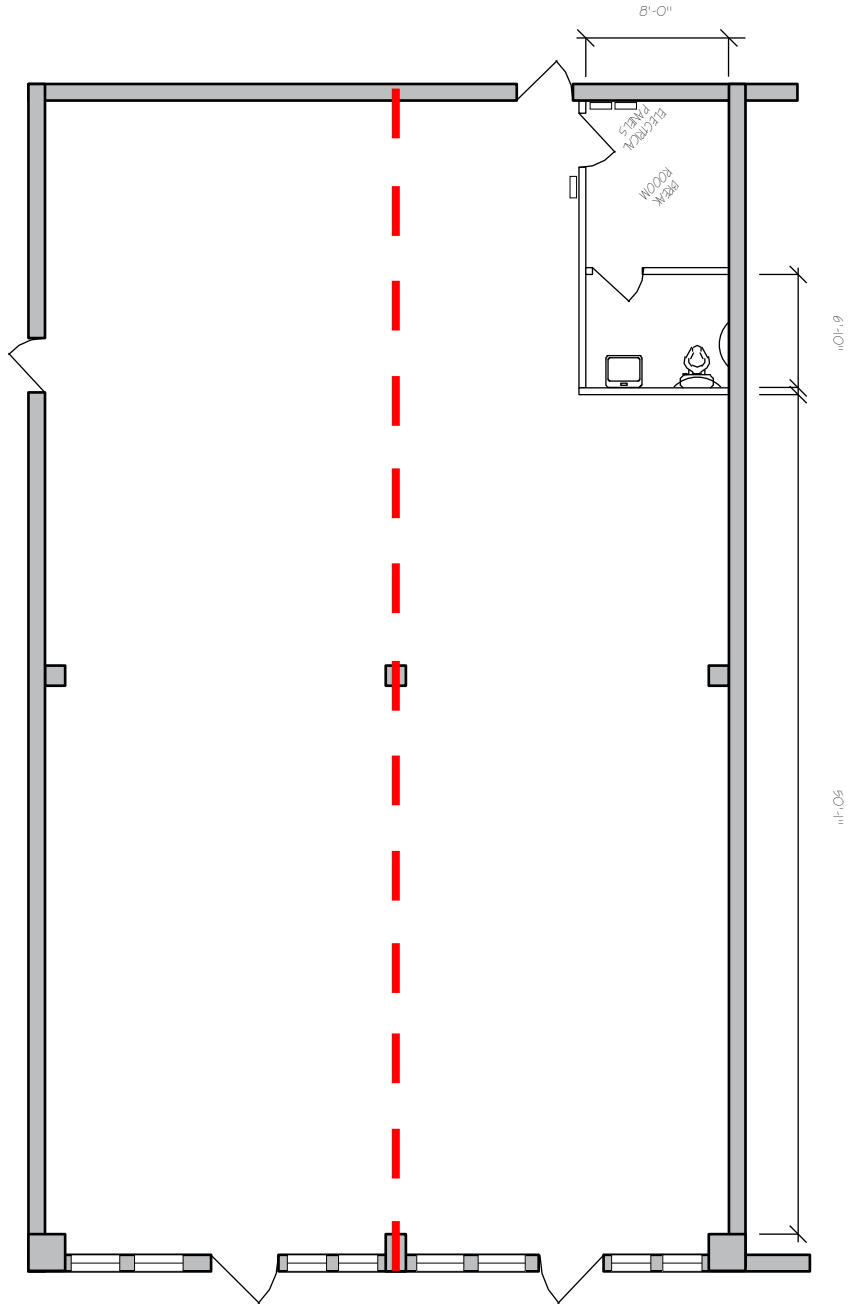

#2-#4 CLARKSON WILSON CTR: 2,930 SF

- - - - - represents potential demising of space

# Clarkson Wilson Center

2-92 Clarkson Wilson Center  
 Chesterfield, MO 63017

## 2,930 SF RETAIL ENDCAP AVAILABLE FOR LEASE



DEMOGRAPHICS	1 MILE	3 MILE	5 MILE
Population:	7,613	57,035	136,315
Daytime Employment:	1,429	37,075	101,425
Number of Households:	2,721	22,305	51,356
Average Household Income:	\$155,130	\$131,076	\$131,813
ANNUAL AVERAGE DAILY TRAFFIC		2017	
Clarkson Road (MO-340):		41,893	