

FOR LEASE

# 6720 BAYMEADOW DRIVE

GLEN BURNIE, MD 21060

105,700 SF AVAILABLE



## RENOVATIONS UNDERWAY

- + Expand all dock doors to 9' x 10'
- + Install two new dock doors, bringing total door count to 12
- + Install new seals on all dock doors
- + Upgrade lighting to LED in warehouse
- + Paint interior warehouse walls and columns to 10' safety yellow
- + New paint and carpet in the office
- + Install dolly pad for 18 trailer drops
- + Resurface car parking lot



## CONTACT US

### MIKE RODEN

Senior Vice President  
+1 410 244 3125  
mike.roden@cbre.com

### ED HARRIS

Senior Vice President  
+1 410 244 3149  
ed.harris@cbre.com

### MICHAEL ELARDO

Senior Vice President  
+1 410 244 3128  
michael.elardo@cbre.com

### JARED ROSS

First Vice President  
+1 410 244 3136  
jared.ross@cbre.com

Owned by:



**HIGH STREET**  
LOGISTICS PROPERTIES

[www.cbre.com/baltimore](http://www.cbre.com/baltimore)

**CBRE**

# FOR LEASE 6720 BAYMEADOW DRIVE

GLEN BURNIE, MD  
21060

## SITE PLAN

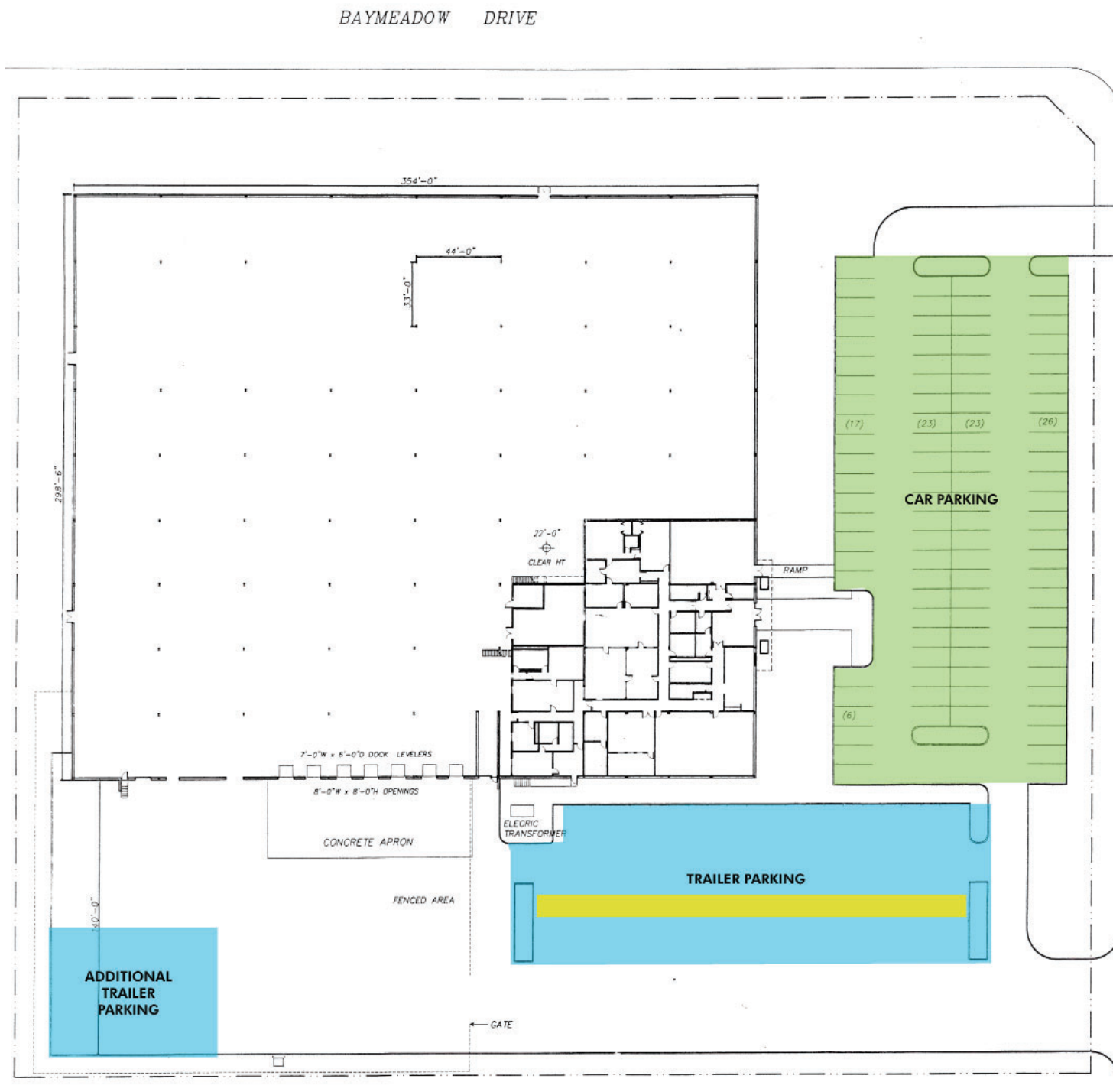

## BUILDING FEATURES

- + 105,700± SF
- + 14,000± SF existing office space
- + 11,000± SF mezzanine office
- + 22' clear height
- + 33' x 44' column spacing
- + 1600 amps 277/480 volt, 3 phase, 4 wire
- + 10 existing docks equipped with seals and levelers; 2 additional docks under construction
- + W-1 zoning
- + Abundant parking with fenced 150' truck court
- + Ability to fully secure outside area

## MEZZANINE OFFICE



# FOR LEASE 6720 BAYMEADOW DRIVE

GLEN BURNIE, MD 21060



## PROPERTY LOCATION

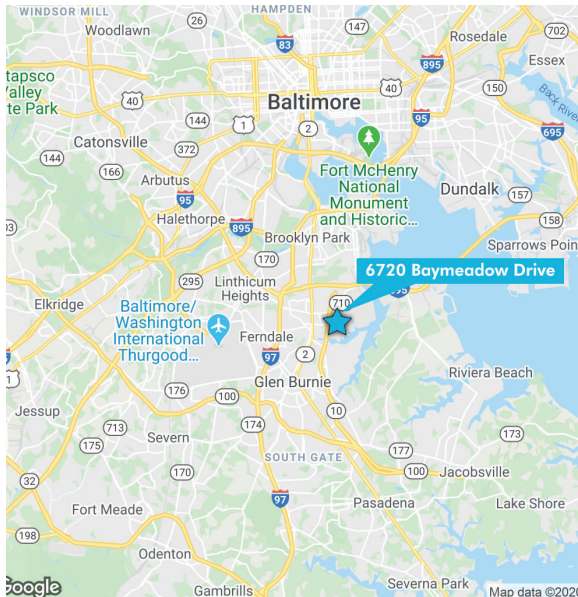

## DRIVE TIMES DISTANCES

- + **Interstate 695:** 9 mins/6.8 miles
- + **Interstate 97:** 10 mins/5.8 miles
- + **Route 100:** 10 mins/ 7.8 miles
- + **Interstate 95:** 14 mins/11.2 miles
- + **BWI Airport:** 12 mins/9.7 miles
- + **Port of Baltimore:** 19 mins/11.3 miles
- + **Baltimore:** 22 mins/11.7 miles
- + **Washington, DC:** 49 mins/37.7 miles



## CONTACT US

### MIKE RODEN

Senior Vice President  
+1 410 244 3125  
mike.roden@cbre.com

### ED HARRIS

Senior Vice President  
+1 410 244 3149  
ed.harris@cbre.com

### MICHAEL ELARDO

Senior Vice President  
+1 410 244 3128  
michael.elardo@cbre.com

### JARED ROSS

First Vice President  
+1 410 244 3136  
jared.ross@cbre.com

Owned by:



**HIGH STREET**  
LOGISTICS PROPERTIES

© 2020 CBRE, Inc. All rights reserved. This information has been obtained from sources believed reliable, but has not been verified for accuracy or completeness. You should conduct a careful, independent investigation of the property and verify all information. Any reliance on this information is solely at your own risk. CBRE and the CBRE logo are service marks of CBRE, Inc. All other marks displayed on this document are the property of their respective owners. Photos herein are the property of their respective owners and use of these images without the express written consent of the owner is prohibited.

[www.cbre.com/baltimore](http://www.cbre.com/baltimore)

**CBRE**