

[FOR LEASE]

224,089 SF STATE-OF-THE-ART
WAREHOUSE/DISTRIBUTION
FACILITY

25,873-78,485 SF AVAILABLE
FOR LEASE

TAX
ABATED



AVIATOR
BUSINESS PARK

6222-6224 PERSHALL ROAD / ST. LOUIS (HAZELWOOD), MISSOURI 63042



KATIE HAYWOOD
Senior Vice President
+1 314 655 5838
katie.haywood@cbre.com

JOHN FRITH
Associate
+ 314 655 6096
john.frith@cbre.com

CBRE, INC.
190 Carondelet Plaza
Suite 1400
St. Louis, MO 63105

PANATTONI
INTERNATIONAL VISION. LOCAL FOCUS.

CBRE

PROPERTY FEATURES

- + 224,089 SF state-of-the-art warehouse/distribution facility
- + Rear loaded
- + 78,485 SF available
- + Divisible to 25,873 & 52,612 SF
- + Excellent visibility on Lindbergh Blvd.
- + 32' minimum clear height
- + LED High Bay Lighting
- + Office built to suit
- + 14 docks (expandable) with 40,000 lb. mechanical dock levelers and dock seals
- + ESRF
- + 50' x 50' column spacing (60' speed bay)
- + Real estate tax abatement with \$0.14 PSF initial taxes
- + Ample car and trailer parking
- + Heavy electric
- + 185' truck court depth

PARK PLAN

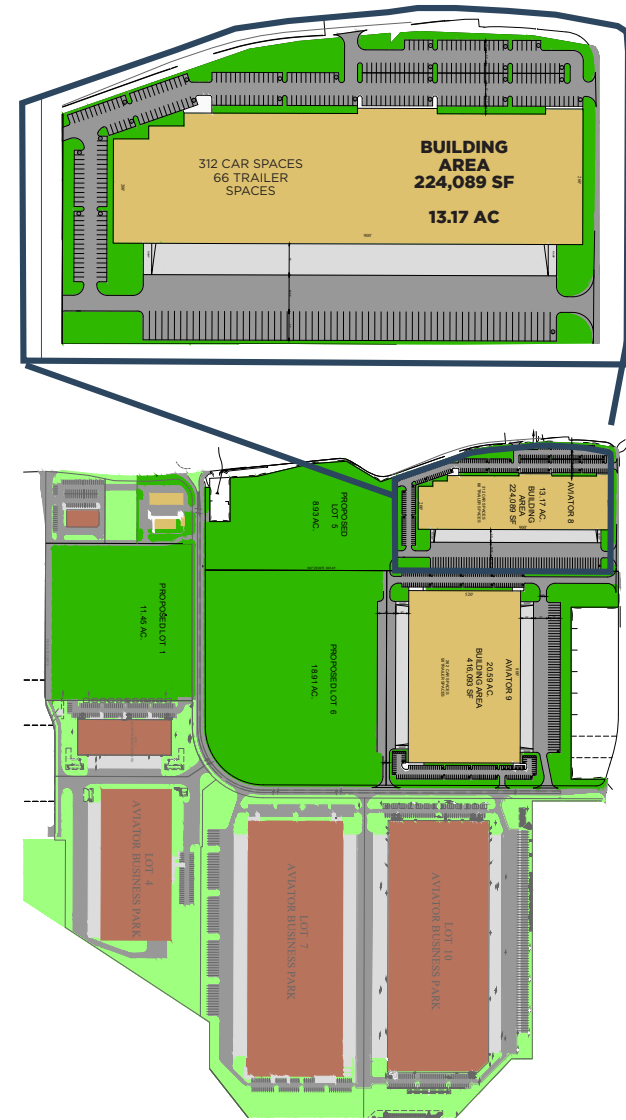

FLOOR PLAN

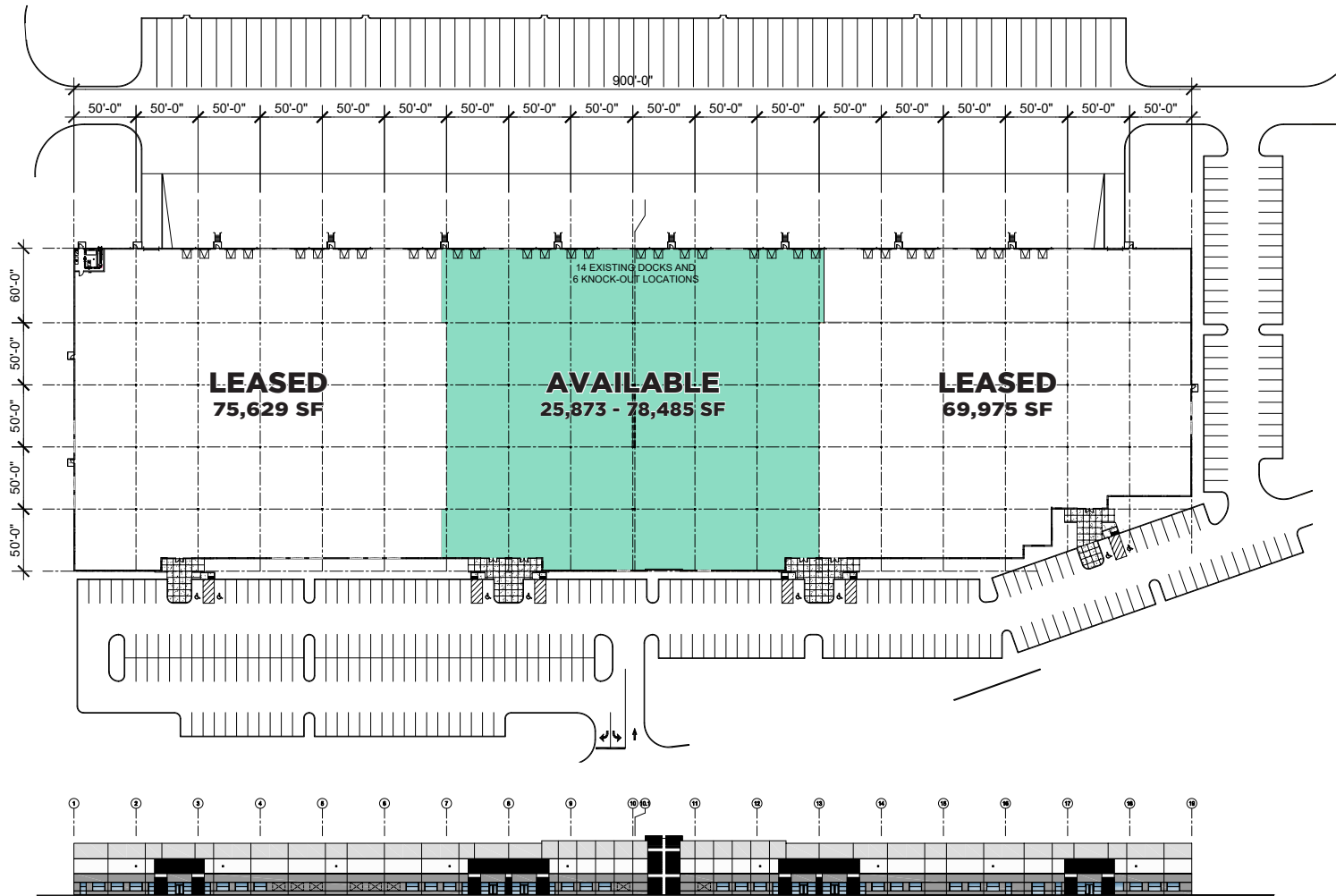



AVIATOR
BUSINESS PARK

BOEING

Mallinckrodt

ARCOBASSO FOODS

UNITED STATES POSTAL SERVICE

amazon.com

amcor

INTERNATIONAL

Weekends FURNITURE **SILGAN PLASTICS**

IRON MOUNTAIN

TAGG logistics

CM

BOEING

St. Louis Lambert International Airport

DRIVE TIMES:



0.5 MILES



2.4 MILES



12 MINUTES



13 MINUTES



8 MINUTES

6222-6224 AVIATOR DRIVE / ST. LOUIS (HAZELWOOD), MISSOURI 63042

KATIE HAYWOOD
Senior Vice President
+1 314 655 5838
katie.haywood@cbre.com

JOHN FRITH
Associate
+ 314 655 6096
john.frith@cbre.com

CBRE, INC.
190 Carondelet Plaza
Suite 1400
St. Louis, MO 63105



© 2020 CBRE, Inc. This information has been obtained from sources believed reliable. We have not verified it and make no guarantee, warranty or representation about it. Any projections, opinions, assumptions or estimates used are for example only and do not represent the current or future performance of the property. You and your advisors should conduct a careful, independent investigation of the property to determine to your satisfaction the suitability of the property for your needs. Photos herein are the property of their respective owners and use of these images without the express written consent of the owner is prohibited. PMStudio_November2018.