

# 31,434 SF

## Industrial Space For Lease



## Prologis Park Beltway Antoine 6

3463 N. Sam Houston Parkway W., Suite 100  
Houston, TX 77086 USA

### LOCATION

- Fronting Beltway 8, Antoine Drive exit
- 2 miles to TX Hwy 249 and 4 miles to I-45
- 9 minutes to Bush Intercontinental Airport
- 20 minutes to Downtown and The Woodlands

### FACILITY

- 31,434 SF available
- 2,130 SF of office
- 24' clear height
- 7 dock doors / 1 drive-in ramp
- 40' x 40' column spacing

### ADVANTAGES AND AMENITIES

- ESFR sprinklers
- T-5 warehouse lighting
- Visible to 150,000 vehicles per day
- Beltway 8 signage
- Deed restricted business park

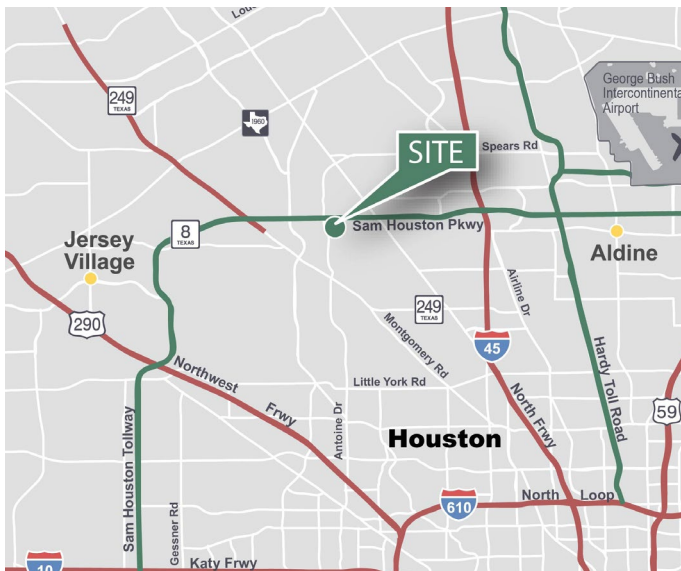

# 31,434 SF

## Industrial Space For Lease

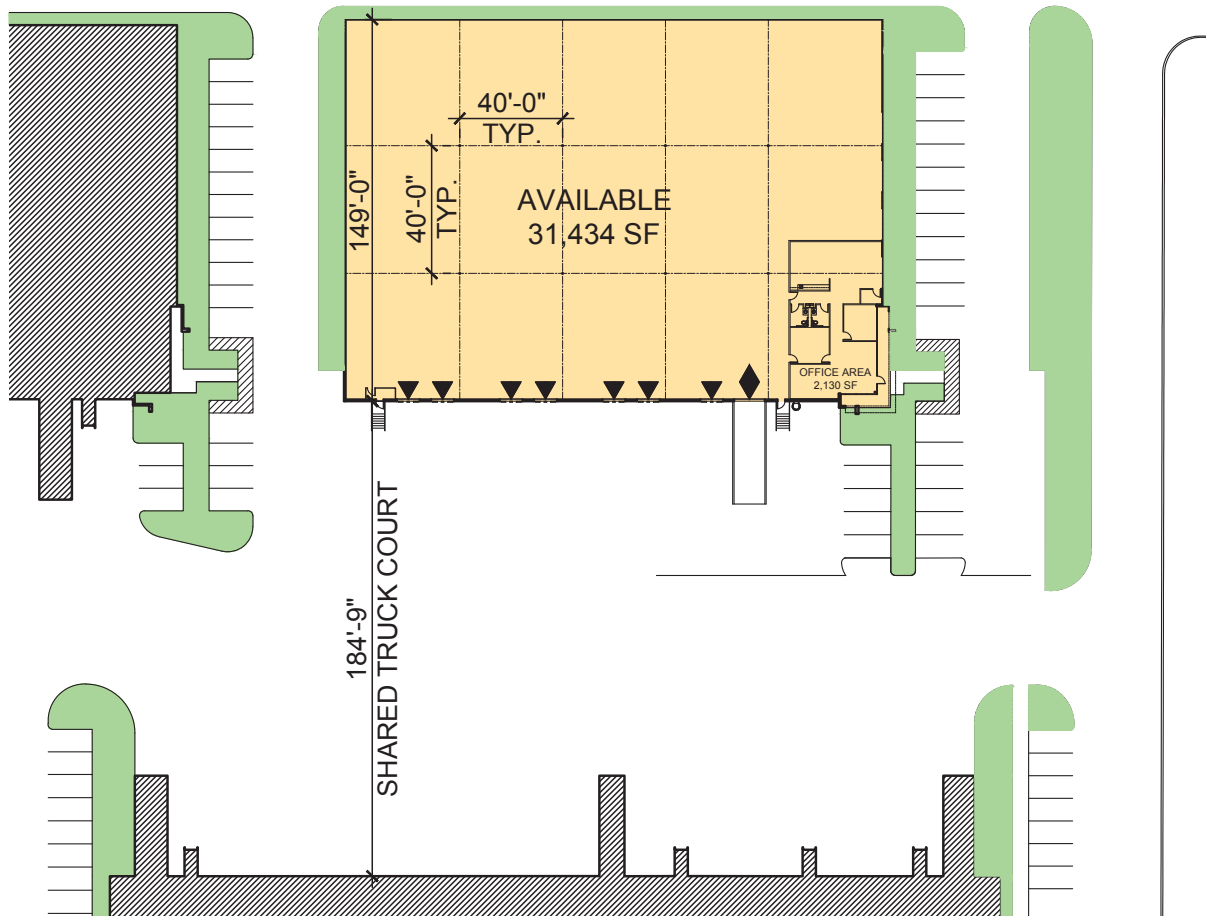

### Cushman & Wakefield

Jason Dillee

jason.dillee@cushwake.com

ph +1 713 345 1432

cell +1 832 741 0733

1330 Post Oak Blvd., Suite 2700

Houston, TX 77056 USA

### Cushman & Wakefield

Nathan Wynne

nathan.wynne@cushwake.com

ph +1 713 345 1431

cell +1 713 206 3881

1330 Post Oak Blvd., Suite 2700

Houston, TX 77056 USA

### Prologis

Kevin Wittler

kwittler@prologis.com

ph +1 713 613 6927

cell +1 832 746 1581

1296 North Post Oak Road

Houston, TX 77055 USA