

**FLEX SPACE  
FOR  
SUBLEASE**

**±4,850 SF**

Sublease  
through  
6/15/2022

Professionally  
owned and  
managed

  
**TRANSWESTERN**  
REAL ESTATE  
SERVICES

# 1296 MARK STREET

Bensenville, IL 60106

[Property Website](#)



## Specifications:

- Building Size: ±53,371 SF
- Land Area: ±3 AC
- Available Size: ±4,850 SF
- Office Size: ±2,500 SF
- Ceiling Height: 12' Clear
- Loading: 2 Drive-in Doors
- Parking: 177 Cars (Bldg Total)
- Year Built: 1975
- Construction: Masonry
- Heating: Gas
- RE Taxes: \$1.33 PSF (2018)
- Lease Rate: \$7.75 PSF MG

## Highlights:

- Sublease through June 15, 2022
- Ability to extend lease directly through Owner
- Excellent proximity to O'Hare
- Professionally owned and managed
- Direct access to Busse Rd and I-90
- Low DuPage County taxes

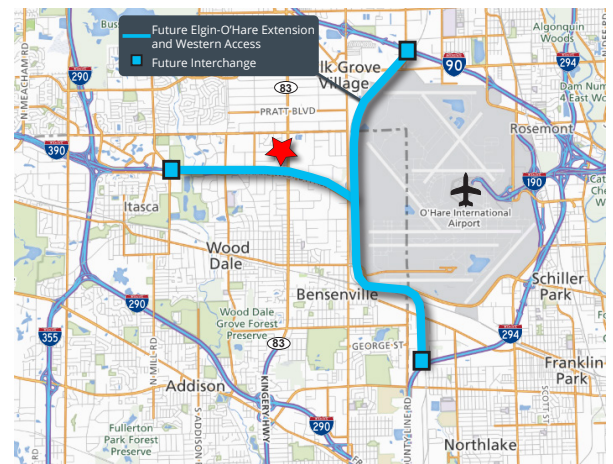

## Contact Information:

**Ross Lehrman**  
*Senior Associate*  
847.588.5671  
[ross.lehrman@transwestern.com](mailto:ross.lehrman@transwestern.com)

The information provided herein was obtained from sources believed reliable; however, Transwestern makes no guarantees, warranties or representations as to the completeness of accuracy thereof. The presentation of this property is submitted subject to errors, omissions, change of price or conditions, prior to sale or lease, or withdrawal without notice. Copyright © 2020 Transwestern.

**FLEX SPACE  
FOR  
SUBLEASE**

**±4,850 SF**

Sublease  
through  
6/15/2022

Professionally  
owned and  
managed



**TRANSWESTERN**

REAL ESTATE  
SERVICES

# 1296 MARK STREET

Bensenville, IL 60106

[Property Website](#)

## Building Layout

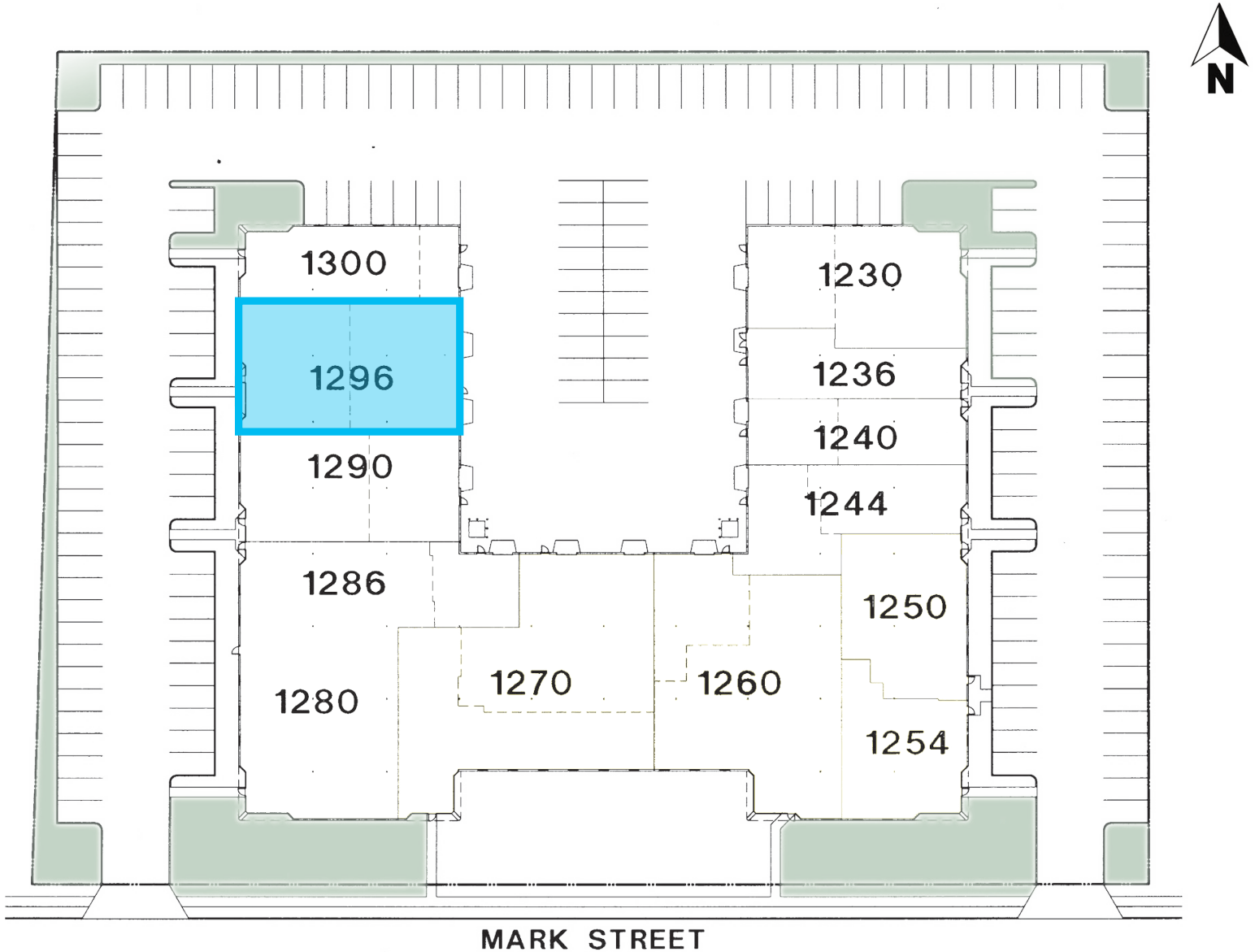

### Contact Information:

**Ross Lehrman**  
*Senior Associate*  
847.588.5671  
ross.lehrman@transwestern.com

The information provided herein was obtained from sources believed reliable; however, Transwestern makes no guarantees, warranties or representations as to the completeness of accuracy thereof. The presentation of this property is submitted subject to errors, omissions, change of price or conditions, prior to sale or lease, or withdrawal without notice. Copyright © 2020 Transwestern.