

FOR LEASE

# 1301 S 7TH AVENUE

PHOENIX, AZ 85007



## 1301 BUILDING | SUITE 200 & 300

- + 1301, Suite 200: ±2,549 SF built out medical
- + 1301, Suite 300: ±2,599 SF office/medical

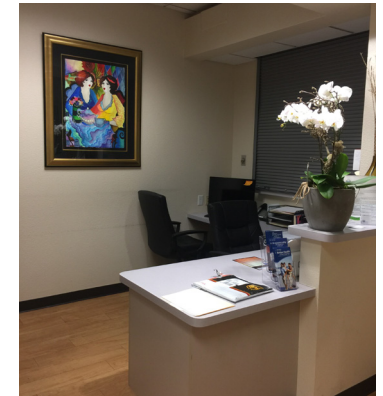
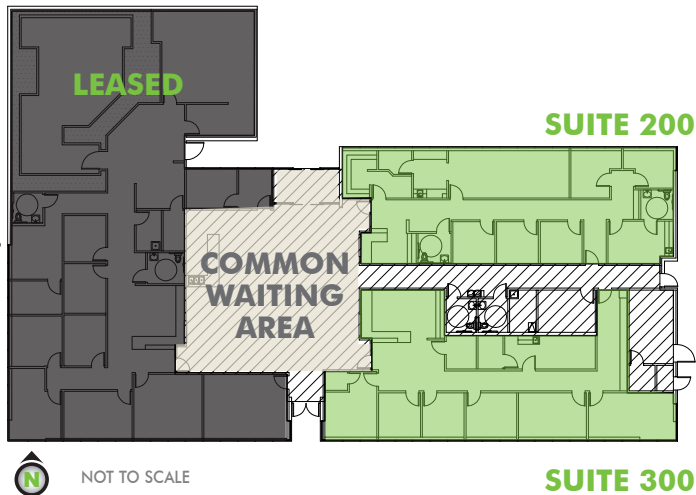

## CONTACT US

**KATE MORRIS**

+1 602 735 1790  
kate.morris@cbre.com

**VINCE FEMIANO**

+1 602 735 1793  
vince.femiano@cbre.com

[www.cbre.us/PhoenixHealthcare](http://www.cbre.us/PhoenixHealthcare)

**CBRE**

# FOR LEASE 1301 S 7TH AVENUE

PHOENIX, AZ 85007



## PROPERTY FEATURES

- + READY TO OCCUPY
- + One-story ±11,600 SF medical building; 95% leased
- + On the campus of Phoenix Memorial Center
- + Well-maintained & established ownership
- + Convenient central Phoenix location, near Interstate 10 and Buckeye Road, just south of the quickly-growing downtown warehouse area
- + ±15 minutes from Sky Harbor International Airport

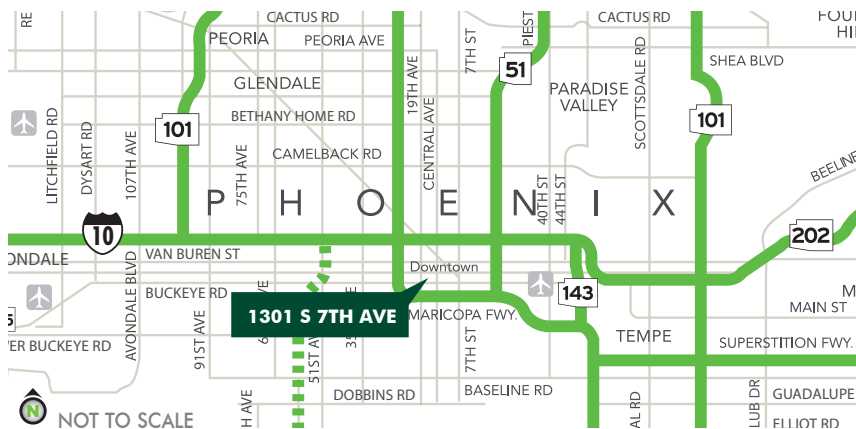

© 2017 CBRE, Inc. All rights reserved. This information has been obtained from sources believed reliable, but has not been verified for accuracy or completeness. You should conduct a careful, independent investigation of the property and verify all information. Any reliance on this information is solely at your own risk. CBRE and the CBRE logo are service marks of CBRE, Inc. All other marks displayed on this document are the property of their respective owners. Photos herein are the property of their respective owners. Use of these images without the express written consent of the owner is prohibited.