

Circle Freeway Distribution Center

234A Circle Freeway Drive, West Chester, OH 45246

DTZ



26,175 SF Available for Lease



- **26,175 SF available**
- Build-to-suit office
- 26,175 SF warehouse
- 20' clear height
- Four (4) dock doors
- Fully sprinklered
- Easy access to I-275 & I-75
- Attractive business park environment

For more information, contact:

Dave Kelly, CCIM

513.763.3009

david.kelly@dtz.com

Tom McCormick, SIOR, CCIM

513.763.3025

thomas.mccormick@dtz.com

221 E Fourth Street, Suite 2600

Cincinnati, OH 45202

T: 513.421.4884

F: 513.421.1215

www.dtz.com

DTZ Copyright 2015. The information contained herein was lawfully obtained from sources we consider reliable. DTZ is not responsible and expressly disclaims all liability, for errors, omissions, prior sales, withdrawal from the market or change in price. Seller (or Lessor, as the case may be) and broker make no representation as to the environmental condition of the property and recommend Purchaser's (or Lessee's) independent investigation.

Circle Freeway Distribution Center

234A Circle Freeway Drive, West Chester, OH 45246

DTZ

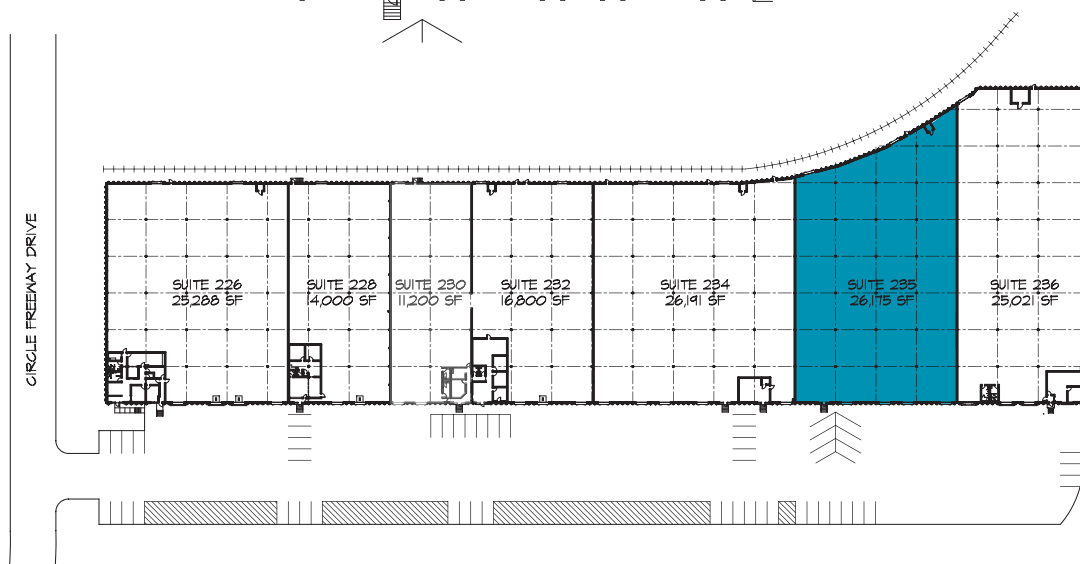
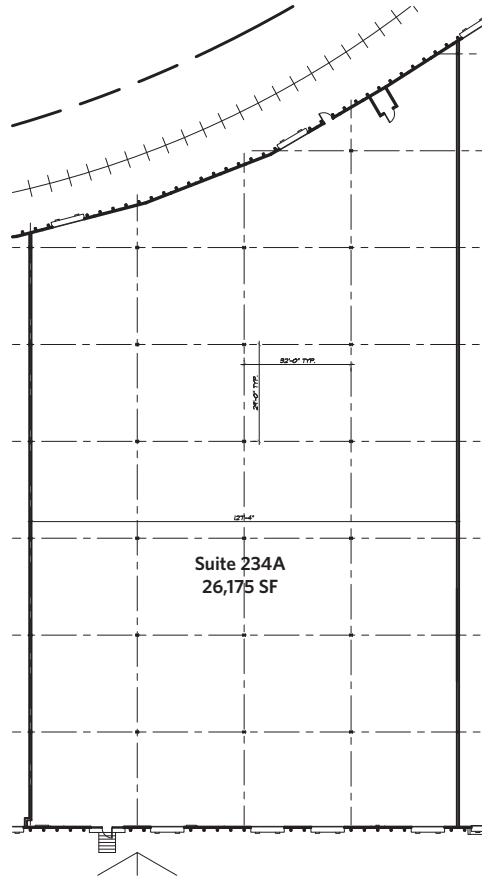

For more information, contact:

Dave Kelly, CCIM

513.763.3009

david.kelly@dtz.com

Tom McCormick, SIOR, CCIM

513.763.3025

thomas.mccormick@dtz.com

221 E Fourth Street, Suite 2600

Cincinnati, OH 45202

T: 513.421.4884

F: 513.421.1215

www.dtz.com

DTZ Copyright 2015. The information contained herein was lawfully obtained from sources we consider reliable. DTZ is not responsible and expressly disclaims all liability, for errors, omissions, prior sales, withdrawal from the market or change in price. Seller (or Lessor, as the case may be) and broker make no representation as to the environmental condition of the property and recommend Purchaser's (or Lessee's) independent investigation.

Circle Freeway Distribution Center

234A Circle Freeway Drive, West Chester, OH 45246

DTZ

Property Specifications

Available SF:	26,175 SF
Office SF:	Build-to-suit
Warehouse SF:	26,175 SF
Clear Height:	20'
Typical Bay Size:	32' x 175'
Dock Doors:	Four (4) 9'x 10'
Truck Court:	95' turnaround
Year Built:	1971
Zoning:	M-2, Industrial
Lighting:	T-5 HO fixtures
Electric:	120/208-volt, 200-amp
HVAC:	
Office:	Fully ducted gas heat, electric, air conditioning
Warehouse:	Gas-fired unit heater
Sprinkler:	Conventional wet system
Miscellaneous:	Attractive business park environment Professionally landscaped No earnings tax Easy access to I-275 & I-75
Operating Expenses:	\$0.85/sf
Lease Rate:	\$2.95/sf NNN



For more information, contact:

Dave Kelly, CCIM

513.763.3009

david.kelly@dtz.com

Tom McCormick, SIOR, CCIM

513.763.3025

thomas.mccormick@dtz.com

221 E Fourth Street, Suite 2600

Cincinnati, OH 45202

T: 513.421.4884

F: 513.421.1215

www.dtz.com

DTZ Copyright 2015. The information contained herein was lawfully obtained from sources we consider reliable. DTZ is not responsible and expressly disclaims all liability, for errors, omissions, prior sales, withdrawal from the market or change in price. Seller (or Lessor, as the case may be) and broker make no representation as to the environmental condition of the property and recommend Purchaser's (or Lessee's) independent investigation.

Circle Freeway Distribution Center

234A Circle Freeway Drive, West Chester, OH 45246

DTZ

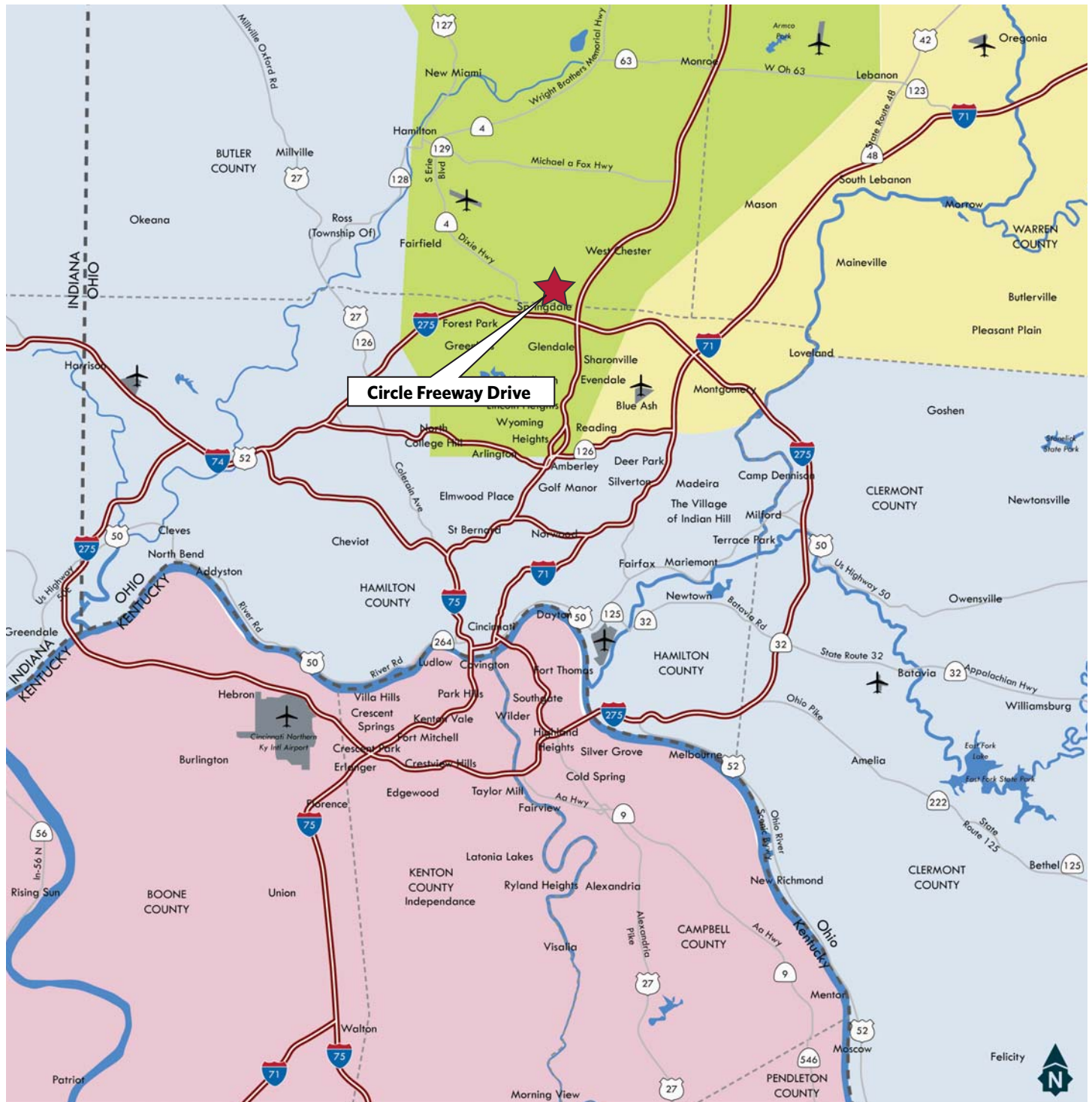

For more information, contact:

Dave Kelly, CCIM

513.763.3009

david.kelly@dtz.com

Tom McCormick, SIOR, CCIM

513.763.3025

thomas.mccormick@dtz.com

221 E Fourth Street, Suite 2600

Cincinnati, OH 45202

T: 513.421.4884

F: 513.421.1215

www.dtz.com

DTZ Copyright 2015. The information contained herein was lawfully obtained from sources we consider reliable. DTZ is not responsible and expressly disclaims all liability, for errors, omissions, prior sales, withdrawal from the market or change in price. Seller (or Lessor, as the case may be) and broker make no representation as to the environmental condition of the property and recommend Purchaser's (or Lessee's) independent investigation.