

FOR LEASE



CROSSWAYS @ GREENBRIER

Lease Rate:
Negotiable

SUBMARKET OVERVIEW

Located in the heart of Chesapeake, Virginia right off of Greenbrier Parkway on Crossways Blvd. Area Tenants include Target, Bed, Bath & Beyond, Best Buy, Total Wine, Macy's and Dillards. Easily accessible from Interstate 64, it is within a short drive from Chesapeake, Norfolk, Portsmouth and Virginia Beach.

DEMOGRAPHICS

	1 MILE	3 MILES	5 MILES
Households:	2,522	35,298	75,835
Population:	6,344	89,578	202,850
Avg HH Income:	\$76,042	\$64,587	\$68,241

PROPERTY HIGHLIGHTS

- 2,126 SF Available Now
- Monument signage available
- Traffic Count 75,000 VPD
- Former Bank Space available with Drive-Thru
- Ample Parking
- Easy access to I64 Greenbrier

FOR FURTHER INFORMATION, PLEASE CONTACT:
ELIZABETH C. PAASCH • epaasch@divaris.com • 757.333.4322



FOR LEASE

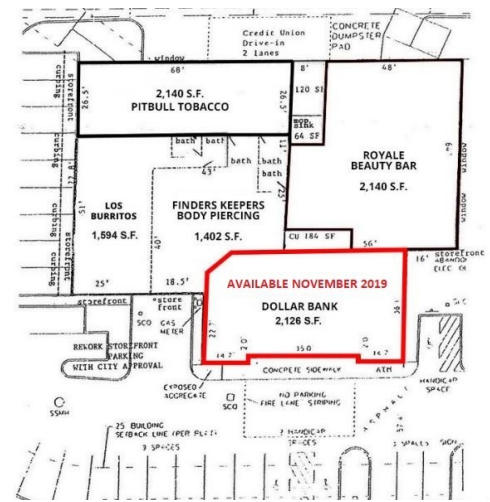
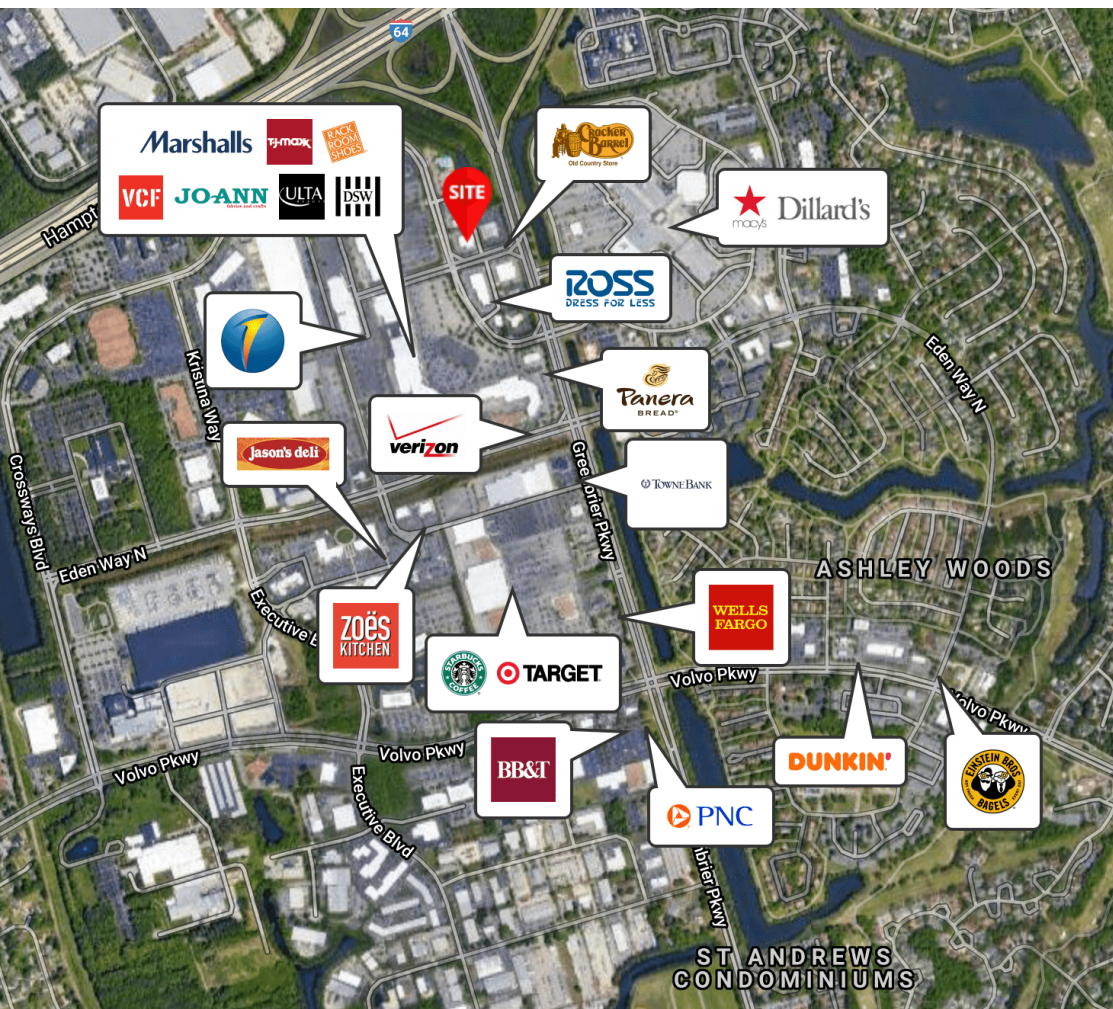

FOR FURTHER INFORMATION, PLEASE CONTACT:
ELIZABETH C. PAASCH • epaasch@divaris.com • 757.333.4322

