



LAND For Sale

Location: Havenridge Road
Side of Street: East
City: New Haven, MI
Cross Streets: W. of Gratiot Ave. & S. of 27 Mile Rd.
County: Macomb

Acreage: 35.34
Zoning: Industrial
Improvements: N/A
Dimensions:

UTILITIES

Sanitary Sewer: No
Storm Sewer: No
Water: No
Gas: No
Outside Storage: No
Rail Siding: Yes

ADJACENT LAND

North: Ind. & Agr.
South: Industrial
East: Agri./Res.
West: Res./Ind.

PRICING INFORMATION

Asking Price: \$1,060,200.00
Per Acre: \$30,000.00
Per SqFt: \$0.69
Terms: Cash
Parcel #: 26-06-28-451-002
Assessor Number: N/A
Taxes: \$3,589.02 (2016/17)

TRAFFIC INFORMATION

Yr: 2015 Count: 3,077 Havenridge & 27 Mile 2-Way
Yr: 2015 Count: 3,077 27 Mile & Havenridge 2-Way
Yr: 2015 Count: 12,413 Main/Havenridge & 27 Mile
Yr: Count:

DEMOGRAPHICS

	Population	Median HH Income
1 Mile Radius	3,392	\$51,383
3 Mile Radius	12,199	\$68,194
5 Mile Radius	51,726	\$73,039

Comments: Property backs up to rail line.

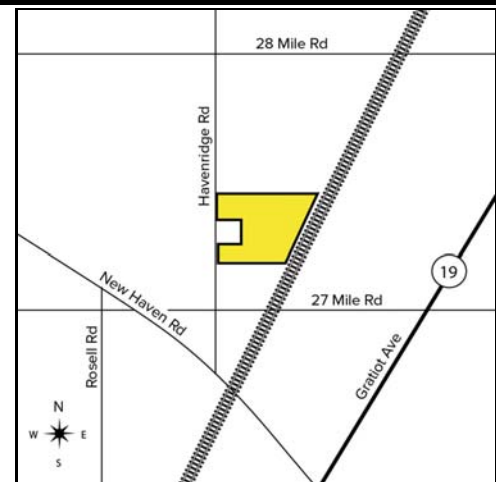

Broker: SIGNATURE ASSOCIATES

Agent(s):

Paul Saad, (248) 359-0652, psaad@signatureassociates.com
 Steve Gordon, (248) 948-0101, sgordon@signatureassociates.com