

FOR SALE OR LEASE - 26,952 SF
612 BURLINGTON RD.
SAGINAW, TX 76179



LOCATION

| | |
|-----------|------------------------------|
| COUNTY | Tarrant County |
| MARKET | North Ft. Worth Ind. |
| SUBMARKET | Meacham Fld./Fossil Cr. Ind. |

BUILDING HIGHLIGHTS

| | |
|-------------------|--|
| ACREAGE | 2.00 AC |
| TOTAL BUILDING SF | 26,952 SF |
| OFFICE SF | 3,000 SF (2 story office) |
| CLEAR HEIGHT | 15' |
| LOADING | 5 Grade Level Doors 1 Drive-Through Door |
| POWER | 3-Phase, 240V/±2,000A |
| COMMENTS | <ul style="list-style-type: none">• Office contains a will call area with large reception/showroom, 6 private offices and breakroom on main level, 3 offices in mezzanine• Fenced, outside storage with concrete pad• Entire site improved• Zoned HI - Heavy Industrial |

Click to open in Google Maps



Becky Thompson, Principal
bthompson@lee-associates.com
D: (972) 934-4019
C: (817) 600-0935

FOR LEASE - 26,952 SF
612 BURLINGTON RD.
SAGINAW, TX 76179

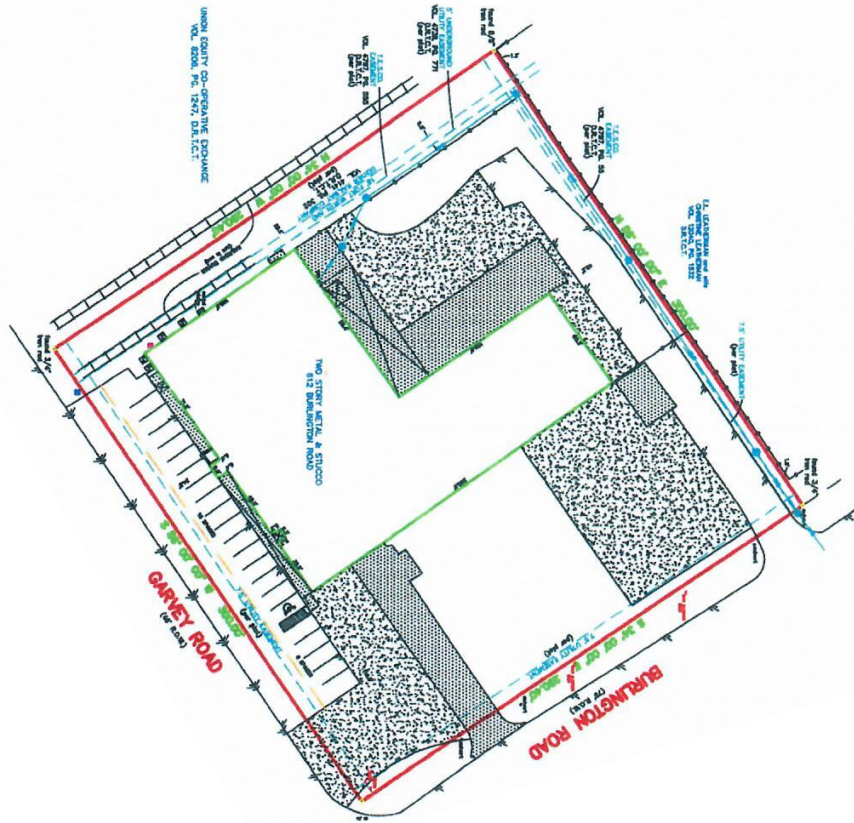

DEMOGRAPHICS

| | 1 mi radius | 3 mi radius | 5 mi radius |
|------------------------------|-------------|-------------|-------------|
| Population | 11,012 | 77,760 | 207,216 |
| Households | 3,580 | 24,646 | 68,084 |
| Pop. Median Age | 32.7 | 31.2 | 31.4 |
| 5 Year Pop. Growth (Total %) | 6.6% | 7.0% | 7.4% |

5 MILE INFORMATION

| | | |
|-----------|---------------|------------|
| | | |
| 57,017 | \$76,921 | 3,725 |
| Employees | Median Income | Businesses |



Becky Thompson, Principal
bthompson@lee-associates.com
 D: (972) 934-4019
 C: (817) 600-0935

All information furnished regarding property for sale, rental or financing is from sources deemed reliable, but no warranty or representation is made to the accuracy thereof and same is submitted to errors, omissions, change of price, rental or other conditions prior to sale, lease or financing or withdrawal without notice. No liability of any kind is to be imposed on the broker herein.