

Large Main Level Office with Open Floor Plan

1888 N. Market Street , Suite C | Frederick | MD | 21701

VCRE.CO



Fantastic main level office suite with open floor plan. Excellent location, plenty of parking.



Office: 240.367.9600 | Fax: 240.668.6822 | 1845 Brookfield Ct. | Frederick, MD 21701

Justin Saltzman

301.639.5894 mobile

Justin@vcre.co

240.367.9600

1888 N. Market Street, Suite C

Frederick, MD 21701

VCRE.CO

Unit Size 1698 SF

Zoning: GC General Commercial

Utilities: Public well and septic in Frederick

Built: 1988

Lease Price: \$25/ SF Full Service

Directions: I-270 North towards Frederick, Exit at
Route 26, turn right at the first light, make next right onto N
Market Street, building is on the left.



1888 N. Market Street, Suite C

Frederick, MD 21701

VCRE.CO

Location Highlights

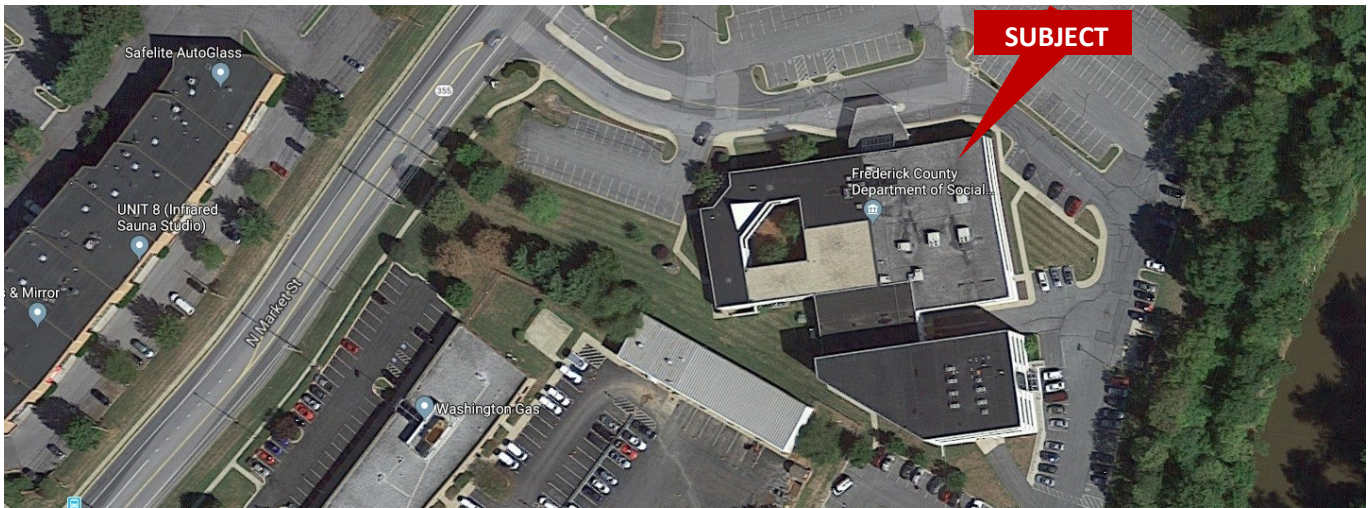
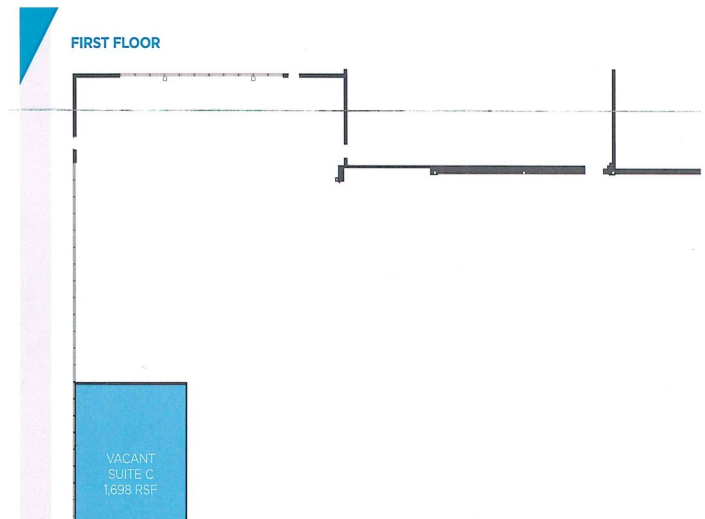
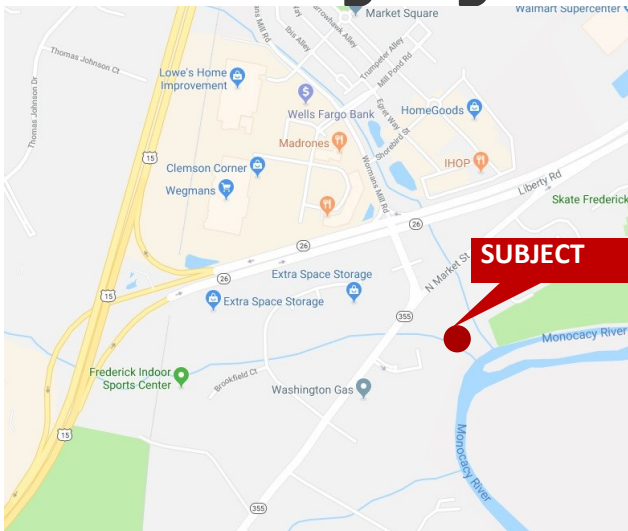

Disclaimer: Information obtained from sources deemed to be reliable. However, we make no guarantee, warranty or representation. Information, prices, and other data may change without notice.



1845 Brookfield Court
Frederick, MD 21701

Office 240.367.9600

Cell 301.639.5894

vcre.co



1888 N. Market Street, Suite C

Frederick, MD 21701

VCRE.CO

Zoning

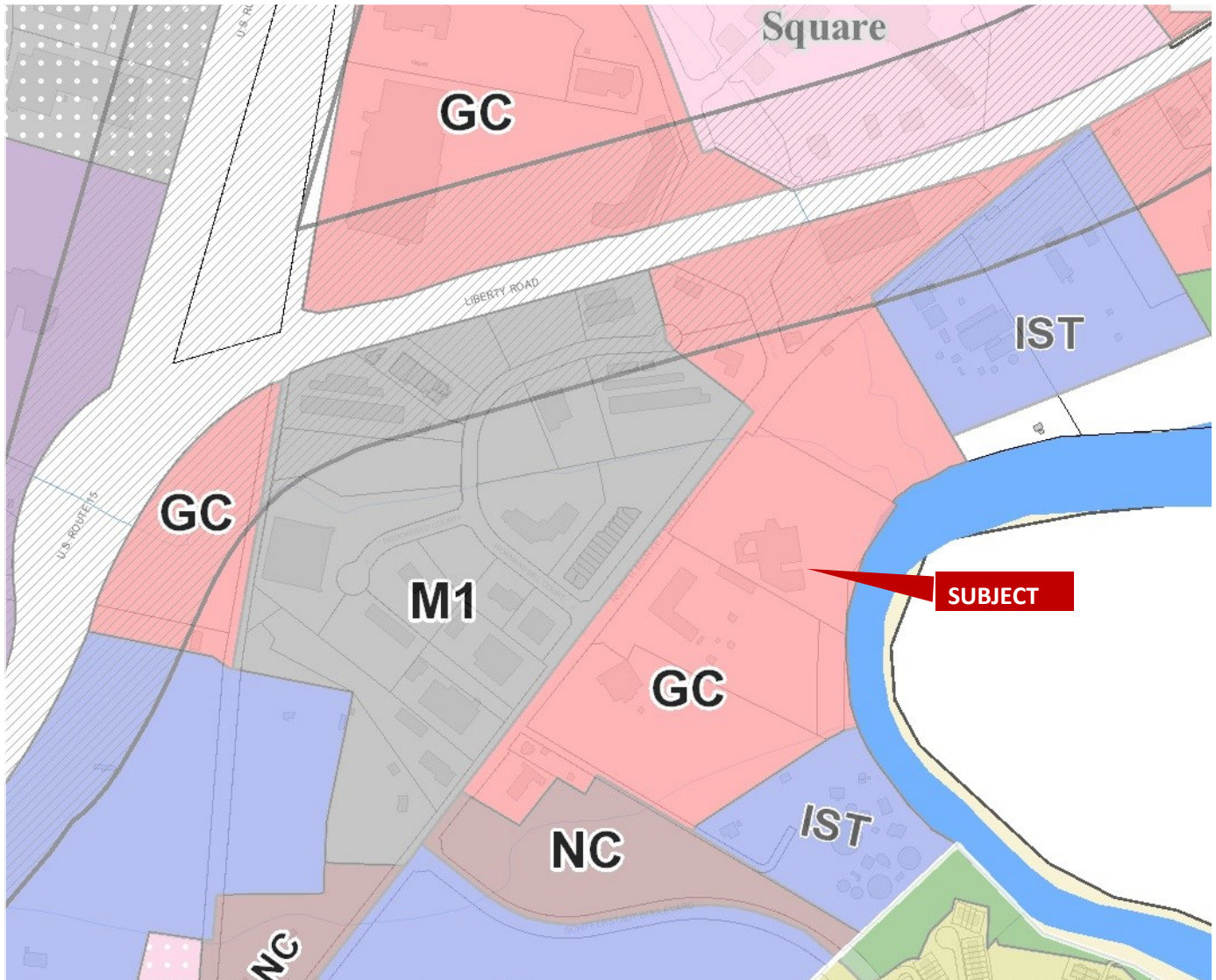

Disclaimer: Information obtained from sources deemed to be reliable. However, we make no guarantee, warranty or representation. Information, prices, and other data may change without notice.



1845 Brookfield Court
Frederick, MD 21701

Office 240.367.9600

Cell 301.639.5894

vcre.co

