



# 330 SOUTH WELLS

330 S. WELLS IS LOCATED AT  
THE NORTHWEST CORNER OF  
WELLS AND VAN BUREN  
LOOP | CHICAGO, IL

**RETAIL SPACE  
AVAILABLE**



# LOOP RETAIL SPACE AVAILABLE

Northwest Corner of Wells and Van Buren | Chicago

# 330

SOUTH WELLS

**SPACE AVAILABLE**  
**Option A**  
 Single Tenant

**SPACE AVAILABLE**  
**Option B**  
 Multi-Tenant

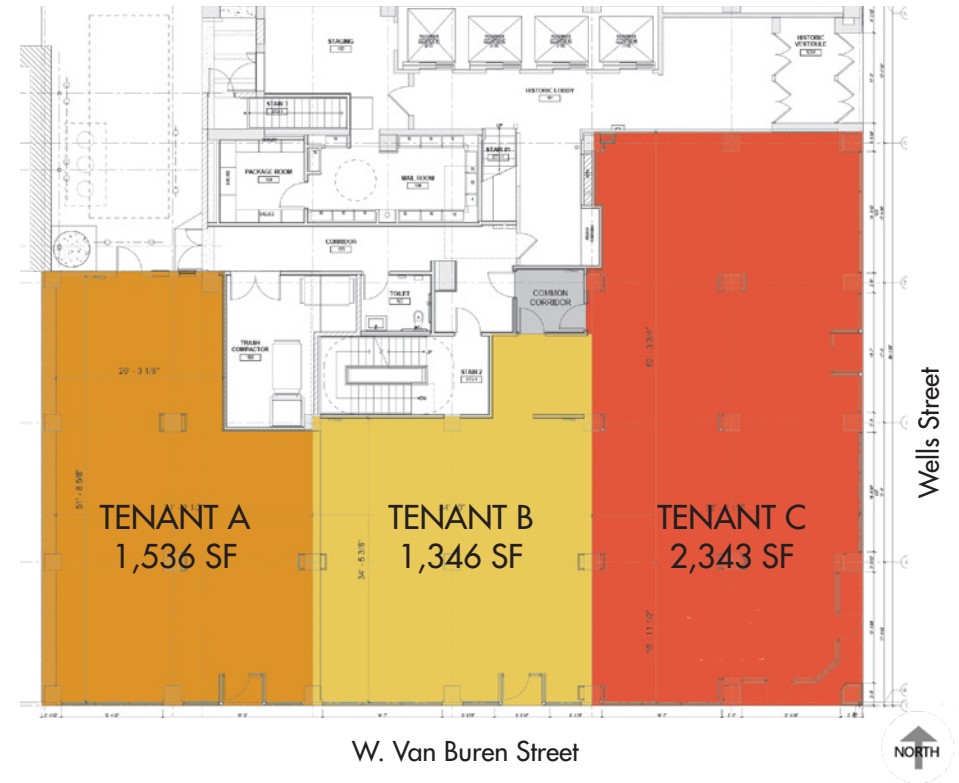
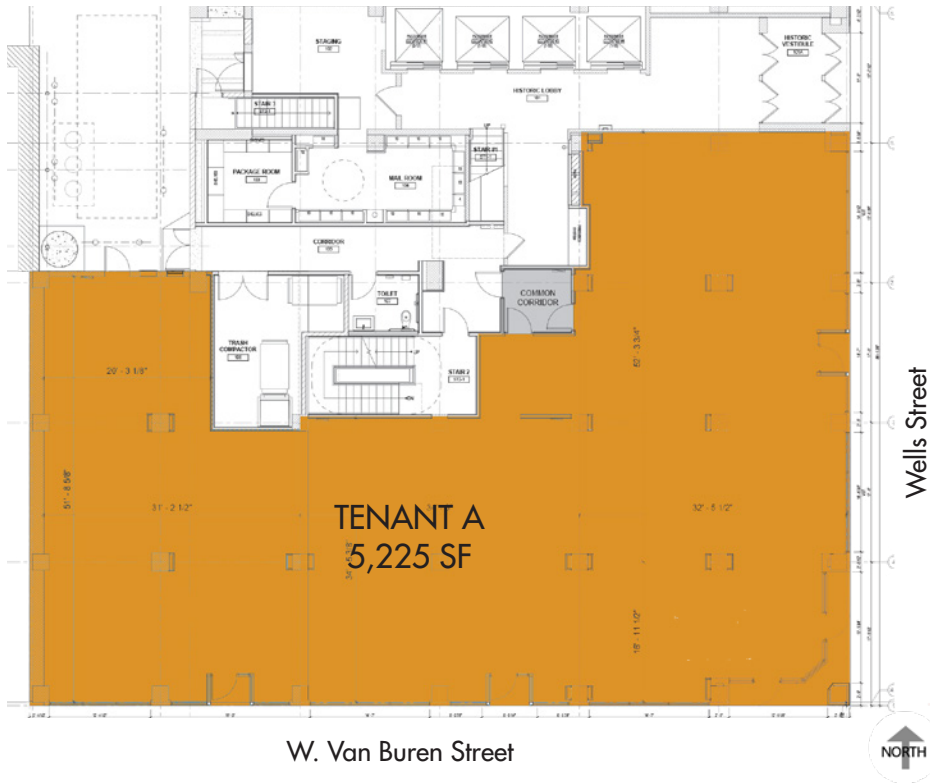

### SITE SUMMARY

- Ground floor corner retail space located at the northwest corner of Wells and Van Buren.
- Steps away from Chicago's historic Financial District.
- Walking distance from CTA Brown, Purple, Orange and Pink lines.
- Building includes 130 new residential rental units.

### NEIGHBORING TENANTS

Qdoba, Greek Kitchen, Dunkin Donuts, Panda Express, Chase, FedEx Office, McDonald's and Giordano's

# LOOP RETAIL SPACE AVAILABLE

## Northwest Corner of Wells and Van Buren | Chicago

330  
SOUTH WELLS

DEMOGRAPHICS	
TOTAL POPULATION	
14,528	0.50 Mile
54,426	1 Mile
200,271	2 Miles
AVERAGE HH INCOME	
\$115,071	0.50 Mile
\$125,422	1 Mile
\$116,717	2 Miles
DAYTIME POPULATION	
168,865	0.50 Mile
300,628	1 Mile
438,197	2 Miles

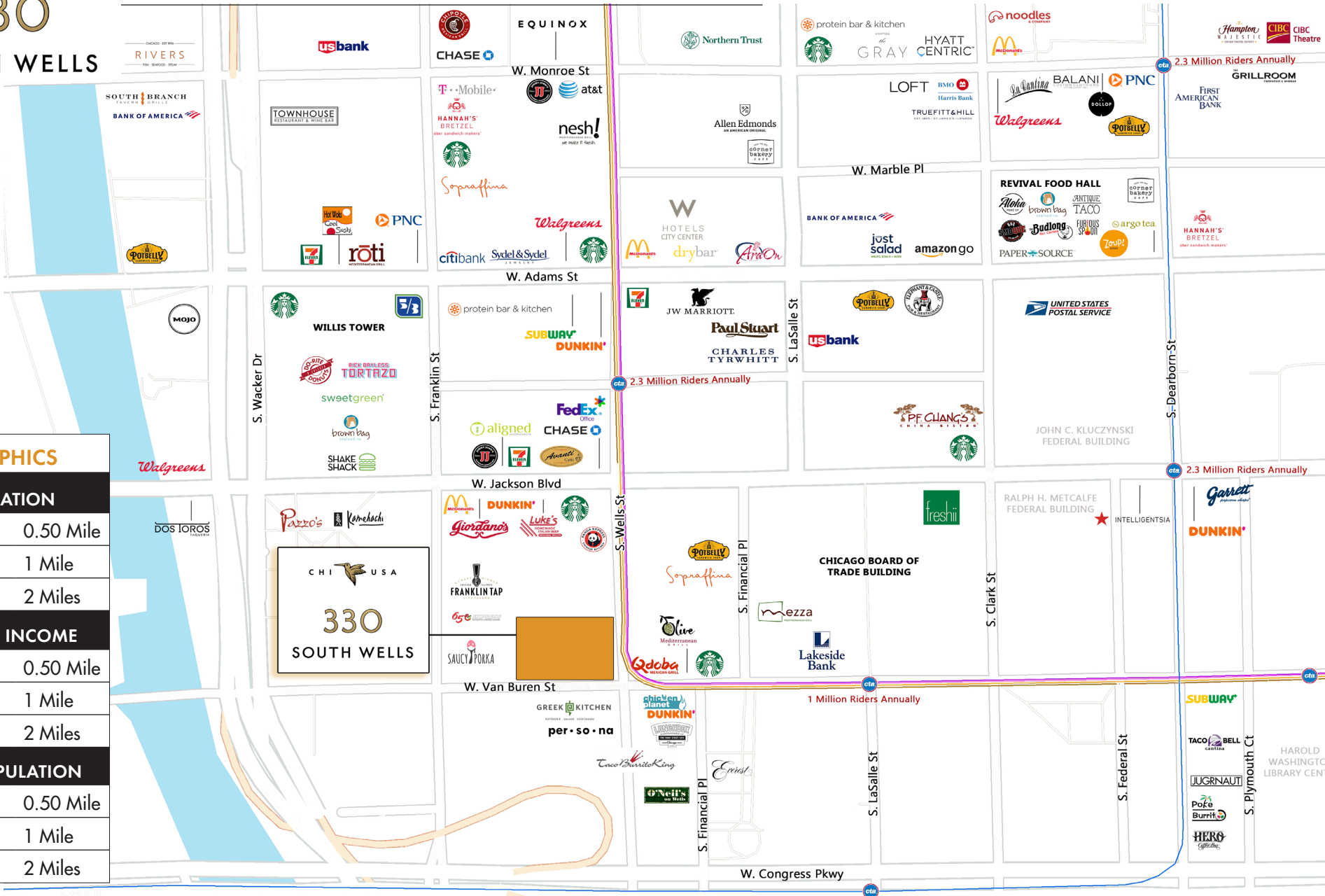

**CONTACT**  
**ANTHONY CAMPAGNI**  
 ac@arcgrp.com  
 630.908.5695

**ELAN RASANSKY**  
 elan@arcgrp.com  
 630.908.5696

© 2020 ARC Real Estate. All information is from sources believed reliable, not independently verified, and thus subject to errors, omissions, and modifications such as price, listing, square footage, rates and commissions. All information, estimates and projections subject to change, market assumptions, unknown facts and conditions, and future potentialities. ARC Real Estate makes no express or implied representations or warranties, as facts and results may vary materially from all information, estimates and projections. All renderings presented are conceptual.